

The Tour is coming!

Suffolk Coastal will be on centre stage this September, as the OVO Energy Tour of Britain comes to the district.

Stage six of the road cycling race travels entirely within Suffolk for the first time, starting from Newmarket and travelling east to a stage finish in Aldeburgh on Friday 8 September.

The 183km stage promises plenty of challenges for the riders.

The route comes into our district at Dennington and travels past Framlingham Castle, Wickham Market, Grundisburgh, past Kesgrave High School, through Woodbridge and our Council Offices in Melton. It then travels through Rendlesham, past Snape Maltings and finally finishes on Aldeburgh's High Street.

The cycling event last visited the county in 2015 and was won by German sprinter Andre Greipel in Ipswich.

Cllr TJ Haworth-Culf, cabinet member for Customers, Communities and Leisure, said: "We're very excited to be welcoming some of the world's top professional cyclists to east Suffolk and Aldeburgh this September!

"The Suffolk coast has become a destination for cycling since hosting the Women's Tour in previous years and it has proved to be a fantastic boost for the area.

"We hope to build on that

success as hosting the Tour of Britain gives us a real opportunity to showcase Suffolk Coastal as a fantastic tourist destination, with the route travelling through the majority of our district.

"We want to use national events like this to give young people the inspiration to take up the sport and get active in Suffolk Coastal.

"By hosting a stage finish,

continued on page 7



Work for us

We've launched a new jobs site in partnership with Suffolk Jobs Direct – to provide one single place for all job opportunities at Suffolk Coastal and Waveney District Councils.

The new site aims to improve and streamline the

application process, allowing candidates to apply for vacancies through an online application process.

We are working in partnership and are committed to improving the quality of life for everyone living in, working in, and, visiting east Suffolk. Our

councils are an exciting place to work and a great place to make a real difference to people's lives.

If you are looking for a dynamic and friendly organisation that will support your professional career, take a look at the fantastic

opportunities our councils offer.

Visit: www.suffolk-jobsdirect.org/East-SuffolkCouncils

**Work
for us!**

Suffolk Coastal & Waveney District Councils



in partnership

eastsuffolk.gov.uk



Contact Us

You can do much more at: www.eastsuffolk.gov.uk, it's quick, easy and cost effective

Email: customerservices@eastsuffolk.gov.uk

General enquiries: 01394 383789

Council Tax: 01394 444855

Housing Benefit: 01394 444838

- Monday to Wednesday 8:45am - 5:00pm
- Thursday 9:30am - 5:30pm
- Friday 8:45am - 4:30pm

Minicom/textphone: 01394 444211

Tweet and follow us: [@suffolkcoastal](https://twitter.com/suffolkcoastal)

Find us on Facebook: [f](https://www.facebook.com/suffolkcoastal)

www.facebook.com/suffolkcoastal

LinkedIn [in](https://www.linkedin.com/company/suffolkcoastal) YouTube [yt](https://www.youtube.com/suffolkcoastal)

Instagram: [@eastsuffolkcouncils](https://www.instagram.com/eastsuffolkcouncils)

Visit us

Suffolk Coastal Customer Services is now based within the community through Felixstowe and Woodbridge Libraries and staff are available to handle enquiries face to face, over the phone and email.

From the library locations we have public access computers and free Wi-Fi.

District Council Customer Services –

Woodbridge Library, New Street, Woodbridge, IP12 1DT

Opening times from April 2016:

- 8.45am – 5pm Monday to Wednesday
- 9.30am - 5pm on Thursday
- 8.45am - 4.30pm on Friday
- Citizens Advice Bureau drop in session Monday 10am-12pm

District Council Customer Services –

Felixstowe Library, Crescent Road, Felixstowe IP11 7BY

Opening times:

- 10am - 4pm on Mondays
- 9am - 5pm Tuesdays to Fridays

- SNAP Support and Advice Project – Friday 9.30am-12.30 & 2-4pm
- Citizens Advice Bureau drop in session, Monday 10am-12pm

For refuse collection and recycling enquiries contact Suffolk Coastal Norse Ltd

Telephone: 01394 444000

Email: scs@ncsgrp.co.uk

Leisure centres (managed by Places for People Leisure)

- Felixstowe 01394 670411
- Brackenbury 01394 270278
- Leiston 01728 830364
- Deben Pool 01394 383789

We are closed on all bank holidays

Out-of-hours emergency telephone service

Contact both Suffolk Coastal and Waveney District Councils on:

01502 527133.

More homes, better business

Suffolk Coastal is committed to providing more new homes and developing businesses as part of its commercial approach to providing services.

This financial year (2017/18), the Suffolk Coastal portion of the Council Tax bill rose by 3.25%.

In real money, this equates to a rise of less than £5 for people living in a Band D property, with the Council Tax on Band D increasing by £4.95 from £152.37 to £157.32 a year... or by less than 10p a week!

But Suffolk Coastal's Leader, Cllr Ray Herring, says the extra funds are needed to maintain the council's investment in the District.

"We remain very positive about the future and believe Suffolk Coastal District Council has a key role to play in fostering a strong economy in the District," said Cllr Herring.



Suffolk Coastal's Leader, Cllr Ray Herring, looks to the future of the Council

"Specifically, we are working to help businesses develop, provide more housing (particularly extra affordable homes) and create new jobs.

"In addition, we need to adopt a more commercial approach to providing services. We need to

generate more income from our services, if we are to keep Council Tax down and protect the tax payer."

No one wants to pay more for services or pay more Council Tax. But we are faced with dwindling financial support from central Government.

By being more commercial, we create funds to be able to invest in important community projects, such as improving our leisure centres, as well as continuing to deliver our Enabling Communities agenda.

For more information see pages 4 and 5.

Money matters

There are financial challenges ahead, but Suffolk Coastal is confident it can continue to deliver quality services, while making efficiency savings and investing in the future.

Our partnership with Waveney District Council has already drastically reduced our staffing numbers and resulted in a joint saving of over £16million since 2010. These savings have been achieved while safeguarding frontline services.

But we need to build on our success and continue to drive down costs. We are moving forward on all fronts, from the proposed merger with Waveney District Council through to moving to new, more economical offices in Melton at no cost to the tax payer.

The Council has an annual budget of about £12 million. About £7.7million of this comes from Council Tax. Although we collect the Council Tax (on behalf of Suffolk Coastal, the County

Council, Police and Town/Parish Councils), only about 10p in the pound goes towards providing our district council services.

We are also facing a steep reduction in central Government grants. Grant income from central Government has dropped from £7.4million in 2010/11 to £600,000 in 2017/18 – and is projected to fall even further in the future.

The Council has benefited from what is called 'incentiv-

ised income', through New Homes Bonus and business rate retention, although there is still a projected budget gap of £2.1 million in 2018/19.

Rather than make cuts to services, Suffolk Coastal is committed to reducing its dependence on central Government grants by becoming more financially self-sufficient. We hope to achieve this through reduced spending and more income generation to make up this shortfall.

Supporting communities

We're celebrating the success of our Councillors Enabling Communities Budgets this issue by taking a look at some of the recent achievements.

Since the launch of the scheme in December 2013, an amazing £600,000 has been spent on a wide range of new community initiatives across 460 projects from new play areas to charity groups.

This year, a total of £273,000 has been put aside to give each elected member £6,500 to spend on new community projects or to develop projects in their ward.

Cllr TJ Haworth-Culf, Cabinet Member for Customers, Communities and Leisure, said: "We believe local people know best what's needed to make their communities better places to live and work – that's why we've given our Councillors even more funding this year to support the projects that are making a real difference to people's lives.

"We hope we can support even more projects over the next 12 months, so if you have a community project or idea your Councillor could support, please do get in touch."

To see how your local Councillor has spent their budget so far, search your ward online at: www.eastsuffolk.gov.uk/your-council/councillors/suffolk-coastal-district-councillors

Community farm benefits



Cllrs Jim Bidwell and Jane Day joined together to help the Deben Community Farm

Support from Suffolk Coastal councillors is helping a new community farm in Melton to grow.

Melton Councillors Jim Bidwell and Jane Day together donated £2,000 from their Enabling Communities Budgets to the Deben Community Farm in Melton to develop the parking area and make improvements to the entrance of the site and

the farm's latest developments.

The farm is home to 50 hens, two highland cattle, three sheep, three lambs, two pigs, 12 piglets and a goat. The land also includes a woodland area, a newly-planted orchard and a yurt which is well used by visiting schools.

Heather Heelis, one of the

directors of the farm, said: "Our District Councillors have been very generous in their support for the farm by helping to fund animal shelters, fencing, entrance way improvements and a small car park. It really has helped to get the Community Farm off the ground."

Cllr Jim Bidwell said on behalf of both Councillors: "We were pleased to provide funding to the community farm because it's becoming a wonderful attraction to local people and visitors to the area.

"We hope that as the farm continues to grow, it will help enable more children to discover the wonders of the natural world and we will endeavour to support them in the future."

To find out more about the project, visit their website: www.debencommunity-farm.co.uk

Kids supported



Kids brightened up the Fun Run with their Hi-Vis vests

Councillor Debbie McCallum, local ward member for Kesgrave West has once again supported Kesgrave's annual Fun Run with her Enabling Communities Funding.

This year Cllr McCallum provided £300 in funding to the Kate Moyes Memorial Fund for the purchase of Hi Vis vests for children taking part in the 5k fun run on 7 May.

This has become a key date in the calendar for Kesgrave with all profits raised going to the charity as well as the St Elizabeth Hospice.

Cllr McCallum, who helps to organise the annual event, said: "Thanks to everyone who took part, we've raised a fantastic £1,800 so far and are now waiting for sponsor money to come through.

"The fun run is a great day for Kesgrave and it's lovely to see the community spirit that comes with this event. Hopefully in turn, the event will also have a positive impact on younger people in the town and encourage more to get fit and active."

For more information visit www.kesgrave5k.com

Budget backs sport

Suffolk Coastal's Enabling Communities Budget is helping support the growth of a local football team.

Cllr Stuart Lawson, ward member for Kesgrave West has given £500 in funding to AFC Kesgrave to help purchase kit and equipment for children on the under 8's football team which is also used for the team's recently formed futsal training sessions.

Nick Richardson, AFC Kesgrave Coach for Futsal, said: "Futsal is an exciting, fast-paced small sided football game that is widely played across the world and

is officially recognised by both UEFA and FIFA.

"The nature of the game places a large emphasis on technical skill and ability in situations of high pressure, and is subsequently an excellent breeding ground for football competencies that can be translated into the 11-a-side format of the game.

Cllr Lawson said: "I'm happy to see that with support from the Enabling Community Funding, I've been able to contribute to the growth of this popular sport.

"The training sessions



Funding is also supporting AFC Kesgrave's Futsal team

have become a popular addition for members of the football club and I hope the technical skills and creativity that come with this growing sport will help develop players ability and

confidence in the larger game."

For more information about AFC Kesgrave and their activities, visit: www.afck-esgravefc.co.uk

New base for youth charity



Just42 now has a new home!

Funding from Suffolk Coastal's Enabling Communities Budget has helped a local youth charity secure accommodation in Woodbridge for the next five years.

Together, Cllrs Geoff Holdcroft, Patti Mulcahy and Colin Hedgley gave £5,500 from their Enabling Communities Budgets to support Just42's purchase of a newly refurb-

ished cabin to use as a main base and office.

The charity which provides kids clubs, youth clubs, mentoring and support to children and young people in the Woodbridge area moved into the £6,000 cabin in December 2016.

Cllr Geoff Holdcroft, said on behalf of the cllrs who provided the funding: "Just42 is a valuable resource for young people in this area by giving them support and guidance as well as helping them develop into later life. We hope by securing this new office space they can concentrate

on the work they do so well."

Caroline Rutherford, Just42 Manager said: "It's great that by buying this container we've secured a base for us to hopefully stay in for a few years. It's now one less financial headache not having to fundraise for our accommodation and it's fantastic that we can now focus our fundraising on delivering our work to children and young people."

Just42 is always looking for support from volunteers, if you would like to get involved or find out more about their work, visit: www.just42.org.uk/get-involved

Help grow

Suffolk Coastal Councillor Graham Harding, ward member for the Trimleys has continued his support

to Trimley Parish Council by awarding further funding from his budget to support their allotments.

Together he has given

over £1,300 in Enabling Communities funding to the parish council since 2015.

The support has helped pay for a new workshop,

which is used for storage and an amenity area, fund a secure container to hold a new lawnmower and new industrial strimmer and locks to keep the equipment safe.

Armed Forces Weekend

This month, Felixstowe is proud to be hosting Suffolk's Armed Forces Weekend on Saturday 24 and Sunday 25 June!

Over the action-packed two days, we're proud to be welcoming service personnel, their families, the local community and visitors alike to celebrate the contribution made by our Armed Forces, past and present.

The weekend promises to be filled with entertainment to mark the 350th anniversary of the Dutch attack on Landguard Fort in Felixstowe. There will be something for everyone, including live music, military displays, battle

re-enactments, children's activities, fireworks and much more!

Cllr TJ Haworth-Culf cabinet member for Customers, Communities and Leisure at Suffolk Coastal, said: "We're very excited about hosting Suffolk Armed Forces Day in Felixstowe. We hope the weekend will raise public awareness of the contribution made to our country by those who serve and have served in Her Majesty's Armed Forces as not many people, locally or nationally know that Felixstowe played an important role in the history of our nation."

The weekend is being organized by the Suffolk Armed



Celebrate our Armed Forces on 24 and 25 June!

Forces Covenant Group, the Landguard Fort Trust, Royal Marines Association and Royal British Legion, with assistance from local

authorities and military units. For more information, visit: www.visitfelixstowe.org.uk/suffolk-armed-forces-weekend

Open-air cinema coming this summer!

Suffolk Coastal's newly created Beachside Events Area in Felixstowe is to host an open-air cinema during the summer holidays.

On Saturday 29 July, a day is being dedicated to films for all the family to enjoy on the seafront.

The free, one-day event is being supported by the Felixstowe Town Council's Youth Forum who have provided £2,000 in funding.

The District Council completed the work to create the multi-use Beachside Events Area in Septem-

ber and since then the Area has been used to host a number of local events.

Three films will be shown throughout the day after we invited the public to send in their film ideas – one for young children in the morning, one for young

people in the afternoon and one for adults in the evening.

All films should be PG and suitable for all ages.

You can send your film ideas to: communications@eastssuffolk.gov.uk

Landguard Photography Competition



Last year's 'Overall Judges Choice' Winning entry by Svetland Sewell

After six hugely successful years, the Landguard Partnership have launched its

seventh Photography Competition for 2017 - where you could win a cash prize of £50 to put towards photographic equipment, plus a framed copy of your photograph.

The competition is open to UK residents only, including

all amateur and professional photographers, and once again, there are three competition themes to choose from; wildlife, macro and photographs at Landguard that make you go 'wow'!

Entrants can submit their photograph by emailing landguardenquiries@eastssuffolk.gov.uk. Please include your full name, age, a telephone number where the Partnership can contact you

if there are any problems and the theme you would like to enter. Remember all photographs must have been taken on the Landguard Peninsula.

Closing date for entries is 12pm on Wednesday 6 September 2017.

For full details, visit: www.discoverlandguard.org.uk/landguard-photography-competition-2017-enter-now

Look out for **the Tour**



Stage Six finishes on Aldeburgh's High Street on Friday 8 September

continued from page 1

it's a fantastic opportunity for young people to get up close with top athletes and get our communities together to celebrate why Suffolk Coastal is a great place to visit and live."

"Our ultimate aim is to give young people the inspiration to take up the sport and get active in Suffolk Coastal."

To stay up to date with the latest news of the Tour, visit: www.tourofbritain.co.uk



The Tour of Britain gives cycling fans the opportunity to see the world's best teams and riders competing on their door step, over eight stages between Sunday 3 and Sunday 10 September 2017.

- Stage 1:** Edinburgh to Kelso
- Stage 2:** Kielder Water to Blyth
- Stage 3:** Normanby Hall to Scunthorpe
- Stage 4:** Mansfield to Newark
- Stage 5:** Tendring Individual Time Trial
- Stage 6:** Newmarket to Aldeburgh
- Stage 7:** Hemel Hempstead to Cheltenham
- Stage 8:** Worcester to Cardiff

Women **On Wheels**

Women On Wheels returns to Rendlesham this October, and this year we hope to get even more girls and women of all ages cycling in support of the Suffolk Royal British Legion Poppy Appeal.

Communities and Leisure at Suffolk Coastal District Council, said: "Last year we had a lot of fun, and raised just under £500 for the Suffolk Royal British Legion Poppy Appeal.

The two rides are 5km and 15km and take place at Rock Barracks, Sutton on Sunday, 1 October, offering an opportunity for women and girls of all abilities to get on their bikes to take on a challenge and have some fun.

"This year we hope to get even more ladies involved. You don't have to be a pro cyclist or wear lycra - this is about getting girls and women of all ages together to have fun and raise money for a noble cause.

Cllr TJ Haworth-Culf, cabinet member for Customers, www.eastsuffolk.gov.uk

Females of all ages can find out more information at:

www.eastsuffolk.gov.uk/development/women-on-leisure/sportandleisure-wheels



Girls and women of all ages are invited to take part in WOW 2017!

Leisure revamp



An artist's impression of the new Deben Leisure Centre

A five-year programme to reinvent leisure facilities in Suffolk Coastal is set to start this autumn.

The Deben Leisure Centre in Woodbridge is the first to be improved, with work starting in September to create a more spacious gym, featuring modern equipment, through the

and the provision of two studios, one to incorporate a spin room and the other for fitness classes, which will also be available for community hire.

The new facility operated by Places for People Leisure has been designed with the Council's leisure development partner, Pulse Fitness.

Deben Leisure Centre is the first facility to be upgraded, followed by Leiston and then Felixstowe in subsequent years.

Cllr TJ Haworth-Culf, cabinet member for Customers, Communities and Leisure, said: "We're delighted that we'll soon be starting the work to Deben, which marks

come at no additional cost to the tax payer.

"We want to increase the number of people using our leisure facilities and boost overall numbers of people taking part in health and well-being activities as part of our commitment to getting more people fit and active.

"Residents and visitors to Suffolk Coastal will have the opportunity to experience dramatically improved facilities with new equipment in a modern setting. We hope the investment and transformation it will bring will make our leisure centres places our communities are truly proud of."

“Ultimately, we want our leisure centres to be refurbished to today's and future standards that the whole community can enjoy, that come at no additional cost to the tax payer.”

addition of a new floor, and a new health suite with a steam room, sauna and ice room.

The approved plans also include purpose-built family changing areas and separate changing facilities for use by schools

The work is set to start in September and last for approximately 10 months. During this time, a full closure is required, due to the nature of the site and the work being undertaken. It's hoped that works will be completed by summer 2018.

the start of our five year programme to redevelop our leisure offer across the district.

"Ultimately, we want our leisure centres to be refurbished to today's and future standards that the whole community can enjoy, that

One of Suffolk Coastal's 10 priorities in its Business Plan focuses high-quality, modern leisure centres that the whole community can enjoy, with state-of-the-art equipment, that come at no additional cost to the tax payer.

continued on page 9

[@SuffolkCoastal](#)

Sports funding for project

The development project to refurbish Deben Leisure Centre in Woodbridge has been boosted by Sport England National Lottery Funding.

Sport England National Lottery Funding awarded £500,000 from their improvement fund to support Suffolk Coastal in improving the leisure centre as part of the Council's wider commitment to improve its leisure centre offer and to encourage more people to become fit and active.

The funding enhances Suffolk Coastal's investment of £2.5M in the project, which in total is set to cost £3M.

Sport England Property Director, Charles Johnston, said: "Sports facilities are vital to encouraging people to be more active and we know people have a better experience of sport when they can play in good quality facilities. The investment being made into Deben Leisure Centre through our Improvement Fund will make a big difference to community sport in Suffolk and will ensure everyone has a place to get active and enjoy sport."

Cllr TJ Haworth-Culf, Cabinet Member for Customers, Communities and Leisure, said: "We're delighted to have received this funding and backing from Sport England



National Lottery Funding as it importantly means that the improvement works can be completed at no cost to the taxpayer.

"Their valued support confirms that our proposals for Deben Leisure Centre are in line with the latest sports recommendations – ensuring that our residents have the best facilities that meet today's and future standards.

"We hope this will be the start of a long relationship with them as we progress our leisure development programme for the whole of the district."

The funding announcement follows good progress for the project after gaining planning approval in February and receiving sign off from Suffolk Coastal's cabinet for the project's business case in March.

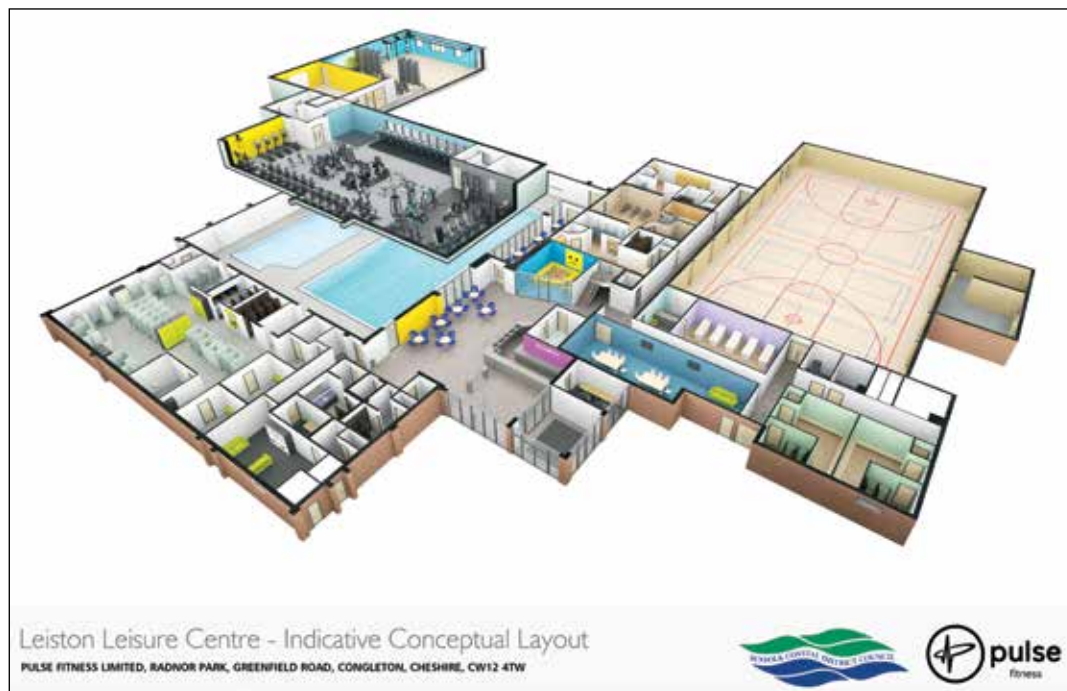

What the new layout of Leiston could look like

continued from page 8

The work builds on the progress made by the Leisure Strategy formed in 2014, which sets out

improvements to the leisure provision across the district, over the next 10 years.

Suffolk Coastal is working closely with its operational

leisure partners, Places for People Leisure, to ensure that disruption is kept to a minimum and existing users receive regular communications and updates.

Leisure News



To stay up to date with all the latest news and progress of Suffolk Coastal's Leisure Redevelopment Programme, sign up to receive our regular newsletter.

To subscribe to future editions, send us any story ideas or if you require further information, please contact: leisure@eastsoffolk.gov.uk

New Visitor Information Service

Suffolk Coastal District Council has joined with the Aldeburgh Cinema Trust to launch a new Visitor Information Service through the cinema.

A new self-help service area now provides the public with information on local events, places to visit and offer local knowledge and advice. This includes an interactive terminal for the public to use to access key tourist information websites, with cinema staff and volunteers on hand to provide assistance to the public.

The cinema will now be open longer hours during the day from 10am-5/6pm (depending on the time of year).

Cllr Geoff Holdcroft, Deputy Leader of Suffolk Coastal and cabinet member for Economic Development, with responsibility for Tourism, said: "The Cinema is an important part of the community and the public already come here to find out what's going on in Aldeburgh. Our aim is to ensure visitors have access to information about Aldeburgh and the surrounding area in a



The new service aims to help visitors explore more of what Aldeburgh has to offer

convenient, accessible way, while also making sure we

are providing best value to the tax payer."

Investment in car parking

Suffolk Coastal has invested in two of its car parks to support more local people and visitors coming to the area.

Melton Riverside now has the capacity for 20 more parking spaces bringing the total of spaces to 50 following works to realign the area.

Thorpe Road in Aldeburgh has now been improved and the surface has been

replaced to prevent standing water issues and to help the car park drain water more effectively.

Cllr Carol Poulter, cabinet member for the Green Environment at Suffolk Coastal, said: "Our investment in these car parks demonstrates the Council's commitment to improving facilities for tourists visiting the area.

"Suffolk Coastal is a fantastic

place for people to come and visit and these car parks will serve as further attractions for our tourists visiting Melton and Aldeburgh.

"Both projects have been a great success as they've been completed ahead of schedule and under budget during the autumn and winter months to reduce the impact on our residents and visitors."

Both car parks will continue



Work to improve the Melton Riverside car park was completed in January

to receive ongoing maintenance by Suffolk Coastal Norse.

Suffolk on big Screen

Just five months after launching to the industry, Suffolk's new one-stop film service Screen Suffolk is already seeing increased interest in the county. Within just the last few weeks, Sherlock star Benedict Cumberbatch has been filming at Shingle Street, and author and screenwriter Anthony Horowitz has hailed Suffolk as a great place to make film.

Screen Suffolk, who now manage filming and photography at all council-owned locations (as well as some private), supported 37 filming days in March and April alone; this puts them firmly on track to meet their target of attracting 100 filming days to the county in their first year.

The screen industries can bring significant direct and

indirect benefits to a region. In 2015, the number of productions filming in the English regions increased by 37 percent, amounting to £93 million on-location spend and over 7,700 days of work for crew. Screen Suffolk's mission is to make Suffolk the most film-friendly county in the UK, and in turn, to attract our share of these benefits.

Many in the county are



already getting involved and Screen Suffolk is calling for all industry professionals to register with them via their website.

To register with Screen Suffolk, visit: www.screensuffolk.com/contact

Single east Suffolk Council

Hailed by Council Leaders in Suffolk as a 'historic day', an agreement to formally merge has been reached by two district councils for the first time since local government reorganisation in 1974.

Suffolk Coastal and Waveney District Councils have both approved proposals to create a brand new 'super district' council, delivering services to communities across east Suffolk and will now work with the Department of Communities and Local Government to begin the formal process of merger. With the Secretary of State's agreement, the new Council would then hold elections, and start operating, in 2019.

Suffolk Coastal approved the proposals at a Full Council meeting on January 26 2017, a day after Waveney councillors voted in favour of the merger - and both Council Leaders recognise the significance of this decision.

Cllr Ray Herring, Leader of Suffolk Coastal District Council said: "This is a historic day for local government, for Suffolk and, most importantly, the communities we serve. By creating a new, larger and more influential council, we will be able to keep costs down, enabling us to maintain and improve the services that local people depend on.

"Working in partnership has already helped the councils save over £16m since 2010. However, further savings cannot be made unless the partnership progresses further. A new, merged, council will be better placed to address the challenges that both councils face."

The late Cllr Colin Law, Leader of Waveney District Council at the time of the decision, said: "Our councils have made history today and I could not be more delighted. We already have a joint 'East Suffolk Business



Suffolk Coastal and Waveney District Councils agreed to proposals in January

Plan' which sets out our vision for the future of the area and a new council is a natural development reflecting important, shared similarities and challenges.

Stephen Baker, Chief Executive for the two councils, has been in post since 2008 and is looking forward to a bright future for the new council. He said: "The challenge facing local government throughout the

country is the need and desire to deliver the best possible services for local people in an increasingly challenging economic environment. At Suffolk Coastal and Waveney we have always sought to innovate and tackle these challenges head on. This is another excellent example of how we have taken a lead and made a progressive decision which we have no doubt will be watched and followed by other councils."

East Suffolk House



Our new office premises at Riduna Park, Melton

Suffolk Coastal moved into new office premises at Riduna Park in Melton in December.

The two buildings East Suffolk House and the Annexe, provide open office space for Suffolk Coastal

staff and includes a flexible and adaptable Council Chamber for meetings, making meetings more accessible to those who want to attend or wish to view them remotely.

The move from the existing and increasingly ageing offices at Melton Hill in Woodbridge is part of the Council's aim to protect the tax payer, by downsizing to reduce the Council's running costs in the future and to give staff more efficient and modern facilities to work in.

Cllr Geoff Holdcroft, Deputy Leader of Suffolk Coastal, said: "The new purpose-built offices provide a contemporary and comfortable place for our staff to work and allow for improved flexible working for both staff and members.

"We're pleased that the move importantly helps us, and the tax payer, save an estimated £200,000 a year in running costs, rising to £500,000 a year in the longer term."

Recruits needed

Children from Suffolk Coastal are being invited to take part in the ground-breaking scheme – Operation Camouflage.

The military-themed summer activity scheme is back for the 10th year from Tuesday 8 – Friday 11 August at Rock Barracks, Sutton, the home of 23 Parachute Engineer Regiment.

The aim of the programme, organised by Suffolk Coastal District Council and the Army Welfare Service (AWS) with funding contributed by ABF The Soldiers' Charity, is to bring together young people from different

backgrounds to challenge themselves and develop new skills.

Activities in the four day programme include graffiti art, climbing, obstacle course, handball, air rifle shooting, archery tag, t-shirt designing and much more.

The action-packed event is aimed at children between 8 – 16 years from Suffolk Coastal and children from military families based at Colchester, Wattisham and Woodbridge.

To take part contact Active Communities, by calling:



Kids can take part in the summer activity from 8-11 August

01394 444652 or email: **Active.communities@eastsuffolk.gov.uk** for an information & recruitment pack by Friday 31 July.

For further information, visit: **www.eastsuffolk.gov.uk/leisure/sportandleisure-development/operation-camouflage**

Calling local artists

We're calling the community to get involved in the competition to commission some art for Suffolk Coastal's new headquarters.

Suffolk Coastal staff have now been in East Suffolk House for over six months and we're looking for local

artists with a link to the area to put their stamp on the building and in turn support the regional artistic community and give them some recognition for their work.

Cllr Geoff Holdcroft, Deputy Leader of Suffolk Coastal, with responsibility for the



Suffolk Coastal staff leading on the art project with Genevieve Christie who is a founder and co-director of Suffolk-based arts charity, FlipSide

Accommodation Project, said: "We've now settled into East Suffolk House and are looking to give something back to the community by giving local artists the opportunity to showcase their work in the new buildings.

"The new building was completed under budget and we want to use some of this leftover funding to commission some exciting artwork for staff and the public to enjoy.

"We hope through this project to celebrate the importance of art and encourage the community to get involved in having their say."

The search for art is set to be launched this summer, look out for further details on our website: **www.eastsuffolk.gov.uk**

Food trail

Food businesses in east Suffolk are being invited to join in a new food tourism trail.

The 'East Suffolk Food and Drink Trails' website, which has been developed by Suffolk Coastal and Waveney District Councils with support from Defra funding, allows visitors to create their own personal trail of discovery around the local area, selecting places to stay and eat as well as things to do from a selection of participating businesses.

Trails can be named, saved and shared on social media. Businesses can also create their own trails, which are featured online.

To start your trail or to sign up, visit: **www.thesuffolkcoast.co.uk/east-suffolk-food-trails**

Have your say on new Local Plan

Want to help us plan for the future of our towns, villages and countryside?

We're encouraging residents to have their say on how our towns and villages grow and change and where new housing, employment, retail and community uses are located.

This summer we will be starting a consultation on the Issues and Options for the Local Plan Review.

The new Local Plan will cover the whole of the area up to

2036. The Plan will guide development and include the policies which will be used when making decisions on planning applications.

The consultation will last for a minimum of six weeks and we are asking people for their feedback and to let us know what they feel should be included in the Plan.

Exhibitions will also be taking place across the district during the consultation period.

You can stay up to date with the latest information,



Get involved in our consultation to have your say on the future of planning in the district

by signing up to the mailing list by emailing: suffolkcoastallocalplan@eastsoffolk.gov.uk

Beach hut consultation

Thank you to everyone who took the time to respond to our consultation on how beach hut services should be run in the district.

We received over 700 responses which are now being analysed in detail and used to inform a report which will be taken to Cabinet later this year.

The review was launched in support of the current East Suffolk Business Plan, which contains a specific action to 'increase the number of beach huts

provided in the District by at least 10%.

The beach hut service is just one of many being reviewed by the council. As an organisation, we are faced with falling revenue from central Government and are seeking to protect the local council tax payer, by getting a fair market value for all the services we offer.

At this stage, no decisions have been taken on how the beach hut service will be managed, or what charges will be levied, in



A decision will be made later this year on how beach hut services will be run

the future. The responses to this consultation will be invaluable in assisting Suffolk

Coastal to shape the future of this service and make decisions on this issue.

Food hygiene

To help businesses ensure that food handlers are trained, Suffolk Coastal and Waveney District Councils jointly run a one-day Highfield Level 2 Award in Food Safety in Catering.

This qualification is accredited and recognised internationally

www.eastsuffolk.gov.uk

and has been developed to protect customers, brand reputation and profit. The Highfield qualification replaces the equivalent CIEH level 2 qualification following voluntary surrender of recognition by the CIEH.

Subjects covered include

hazards and controls, food safety management and temperature controls, food poisoning control, personal hygiene, cleaning and disinfection, food pests, and the role of the food handler in keeping food safe.

The course dates in Melton are



15 August and 11 October.

To find out more, to book and pay online, visit: www.eastsuffolk.gov.uk/business/food-safety/food-safety-training

New partnership for Leiston



A new partnership has been set up in Leiston to regenerate the town to improve the lives of local people, businesses and community groups.

Leiston Together was formed in November 2016 through support from the Department for Communities and Local Governments, (DCLG) Coastal Communities Fund to create a Coastal Community Team.

Led by Leiston Change Manager, Elspeth Gibson, the partnership meets to use its influence and resources to enable the delivery of four key priorities in the community of Leiston. These focus on town centre regeneration, young people, business and enterprise and health and wellbeing.

Elspeth said: "There are lots of positive things happening in Leiston at the moment

and we hope with the new partnership we can harness this positivity to make the town a better place for everyone including local people, businesses and community groups.

"I'm excited to see this new partnership coming together which aims to regenerate the town and as change manager, my new role is key to facilitating the delivery of these priorities in Leiston."

Cycle safe

As we approach the summer tourist season, the year-long trial allowing cycling along Felixstowe's Promenade is going well.

But we're repeating our appeal for people using the Prom to take extra care, as the shared space becomes busier.

The trial to allow cycling on the Prom was officially launched in mid-October 2016, when

the byelaw which prohibited cycling was lifted to allow cycling for a period of 12 months.

Temporary signs have been installed to promote the trial and inform both pedestrians and cyclists that the Prom is now a shared space, where cycling is permitted. The signs stress the need for cyclists to be mindful of pedestrians and to dismount

in crowded or narrow areas.

The trial period will continue to be monitored throughout the year and a final report will be prepared at the end of this period to determine the trial's success and give recommendations for the future.

If you have any comments, please send them to: felixstowe.forward@eastsuffolk.gov.uk

Improving community buildings in east Suffolk

The Thriving Community Buildings project, delivered by Groundwork Suffolk with funding and support from the ESP, SCDC, Suffolk Coast & Heaths AONB Sustainable Development Fund and Suffolk County Council has now supported over 40 community buildings since it began in 2014.

The service offers tailored advice on energy and resource efficiency, emergency planning and resilience, health and safety, governance and charity guidelines, safeguarding, financial management, business planning, employment and biodiversity as well as access to wildlife.

So far the project has identified savings of £21,527 and just under 100 tonnes of carbon dioxide. To find out if your community building could benefit, contact Jamie Murphy from Groundwork Suffolk on 01473 350370 or email jamie.murphy@groundwork.org.uk

Youth activities funding

The East Suffolk Youth Priority Action Group (ESYPAG) has now launched the fourth round of funding for their youth holiday activities programme through the East Suffolk Partnership (ESP).

The aim of the programme is to improve the variety of opportunities available to young people aged between school years 7 – 13 (ages 11-18 years) in east Suffolk, with the ESP providing £50,000 in funding to support the initiative over the next two years.

Activity providers across Suffolk Coastal and Waveney are being asked to involve and provide not just sport, but also activities promoting the arts, science as well as activities to improve skills, as well as activities aimed at young disabled people.

This round of funding will be used to organise projects taking place during October Half Term and Christmas holidays 2017 and can be applied by youth organisations across east Suffolk.

The project builds on the



work of the ESYPAG who has been working since 2015 to support and develop youth participation in Suffolk Coastal and Waveney, with final decisions on successful applications being made by a panel of young people.

The deadline for applications is Friday 18 August. For more information, visit: www.eastsuffolkpartnership.org.uk/home/priorities/esypag

‘Love East Suffolk’ celebrates success

Thank you to everyone who took part in this spring’s ‘Love East Suffolk’ litter pick scheme.

At the time of going to press, we’ve had 51 groups and over 1,200 volunteers registered to take part in community litter picks throughout the year.

To incentivise more groups of volunteers to help litter pick in East Suffolk, the scheme offered a £20 payment to all groups who registered their litter pick to take place between 1 March to 31 May and were also entered into a prize draw.

All registered groups who took part during this period have also be entered into a prize draw, with prizes of £200 awarded to winning groups in each of five “neigh-



Thanks to Surfers Against Sewage who’ve helped clean up Aldeburgh beach

bourhood areas” in Suffolk Coastal with funding once again provided by Norse.

Cllr Carol Poulter, cabinet member for the Green Environment at Suffolk Coastal District Council, said: “Thank

you to our hard working volunteers for their support!

“Although the incentive has now finished for this year, we will as always continue to support groups by providing them with litter picking

equipment and collect the waste away for them and will continue to do so at any time of the year.” To book a litter pick in your community, visit: www.eastsuffolk.gov.uk/waste/litter/love-east-suffolk

Get recycling!



You can now recycle small electrical appliances in Woodbridge and Saxmundham

It is now even easier for residents in and around Woodbridge to recycle their electronic and textile waste.

Collection containers for small electrical and electronic appliances and textile banks have been placed at the recycling centre behind the Deben Pool swimming

pool in Station Road, Woodbridge and an electrical bank has also been placed at the Market Place car park in Saxmundham.

The new electric facilities enable residents to deposit waste items such as hair-dryers, kettles, toasters, electric clocks, irons, food mixers, DVD players, radios and small electrical hand tools and will be serviced by our partners, Suffolk Coastal Norse.

Electrical and electronic waste can already be recycled at the County Council’s Household Waste and Recycling Centres at Leiston, Foxhall and Felixstowe.

Turn your garden green!

Home composting is the most environmentally friendly way of dealing with garden waste, and Suffolk residents can get hold of a compost bin from as little as £8.99 (plus P&P) to turn their garden waste into their own home-made compost thanks to the Suffolk Waste Partnership’s subsidy scheme.

As well as basic compost bins, a range of alternative systems which can deal with cooked food waste are also available, including food waste digesters, wormeries, and hot compost bins.

For details of the products and offers, and to order, visit: www.suffolk.getcomposting.com or call **0844 571 4444** quoting reference SUF17L.

For details about home composting and the Suffolk Master Composter Volunteer scheme, visit: www.greensuffolk.org/recycling/reduce-and-reuse/home-composting

For lots of handy food waste reduction tips, visit: www.lovefoodhatewaste.com



Suffolk Armed

Forces Weekend

24 and 25 June 2017

Family fun at
the seaside
Live music &
entertainment
Re-enactments
& displays

© Global Stars/Keith Wilson



Felixstowe



www.visitfelixstowe.co.uk
www.facebook.com/visitfelixstowe