

PUBLIC PATH DIVERSION ORDER

HIGHWAYS ACT 1980

EAST SUFFOLK COUNCIL (CLOPTON FOOTPATH 4 (PART)) PUBLIC PATH DIVERSION ORDER 2025

This order is made by East Suffolk Council ("the authority") under section 119 of the Highways Act 1980 ("the 1980 Act") because it appears to the authority that in the interest of the owner and occupier of the land crossed by the footpath described in paragraph 1 of the order it is expedient that the line of the footpath should be diverted.

Mr J Pierce has agreed to defray any compensation which becomes payable in consequence of the coming into force of the order, and any expenses which are incurred in bringing the new site of the footpath into a fit condition for use by the public.

Suffolk County Council has been consulted as required by section 120(2) of the 1980 Act and has consented to the making of the order.

BY THIS ORDER:

1. The public right of way over the land situated at Clopton and shown by a bold continuous line on the map contained in this order and on the Definitive Map and described in part 1 of the schedule to this order shall be stopped up with effect from the date on which Suffolk County Council certifies that the work to bring the new site of the footpath described in paragraph 2 of this order into a fit condition for use by the public has been carried out. Certification shall not take place prior to the creation of the new route described in paragraph 2 of this order.
2. There shall at the end of 30 days from the date of confirmation of this order be a public footpath over the land situated at Clopton described in part 2 of the schedule and shown by a bold broken line on the map contained in this order.

GIVEN under the common seal of East Suffolk Council this 17th day
of April 2025

THE COMMON SEAL OF)
EAST SUFFOLK COUNCIL)
was hereunto affixed in the presence of:)

MAKING CLARKE
CICEROINE MANARA AND
RUTHIE DAS LACTRA

Authorised Officer

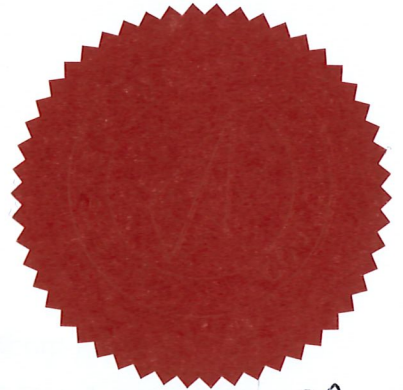

1592

The foregoing Order is hereby confirmed by East Suffolk Council
as an unopposed Order

THE COMMON SEAL of EAST SUFFOLK COUNCIL
was hereunto affixed this 10th day of July 2025

MAKING CLARKE
Authorised Officer
CICEROINE MANARA AND
RUTHIE DAS LACTRA



1592
1679

SCHEDULE

Part 1

Description of Site of Existing Path

Clopton Public Footpath 4 (part) – The entire width of that part of Clopton Public Footpath 4 commencing at point A at Ordnance Survey grid reference TM22575509 and proceeding in a north easterly direction from Shop Road for approximately 150 metres to point B at Ordnance Survey grid reference TM22705516 and continuing in a north easterly direction for approximately 141 metres to point C at Ordnance Survey grid reference TM22845520; this being the route shown between points A – B – C on the order map.

Part 2

Description of Site of New Path



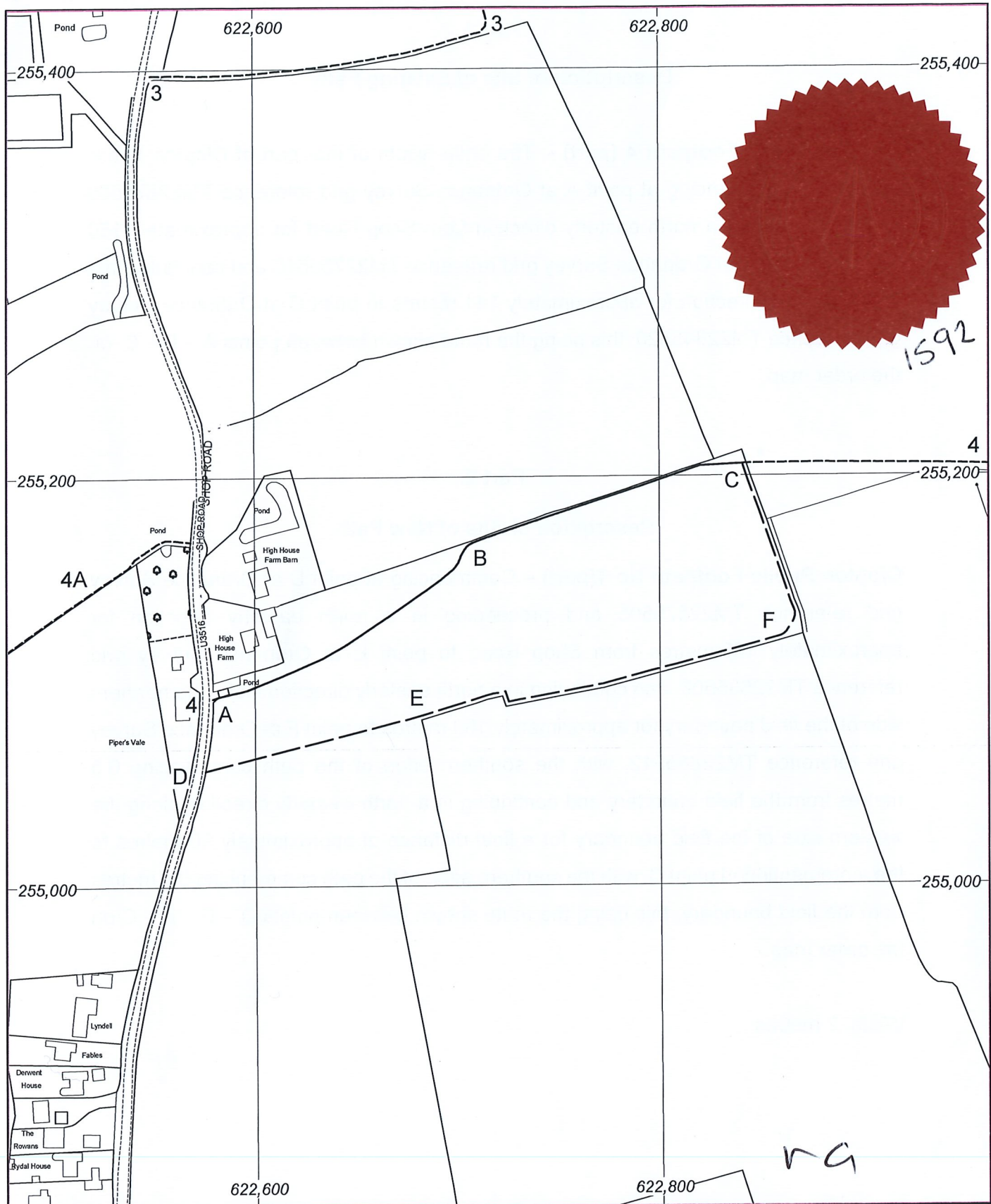

Clopton Public Footpath No 4(part) – Commencing at point D at Ordnance Survey grid reference TM22575505 and proceeding in a north easterly direction for approximately 109 metres from Shop Road to point E at Ordnance Survey grid reference TM22685508 and continuing in a north easterly direction along the northern side of the field boundary for approximately 189 metres to point F at Ordnance Survey grid reference TM22865512, with the southern edge of the path commencing 0.5 metres from the field boundary and continuing in a north westerly direction along the western side of the field boundary for a final distance of approximately 90 metres to the aforementioned point C, with the southern edge of the path commencing 0.5 metres from the field boundary; this being the route shown between points D – E – F – C on the order map.

Width: 2 metres



**MAP REFERRED TO IN THE EAST SUFFOLK COUNCIL (CLOPTON FOOTPATH 4(PART))
PUBLIC PATH DIVERSION ORDER 2024 - HIGHWAYS ACT 1980 SECTION 119**



-  Footpath to be diverted (A - B - C)
-  Proposed Footpath (D - E - F - C)
-  Unaffected Footpath
-  Definitive Map Parish Boundary



Scale: 1:2,500 at A4