

EAST SUFFOLK COUNCIL

PUBLIC PATH DIVERSION ORDER 2025

WENHASTON FOOTPATH 1(PART) AND FOOTPATH 25(PART)

This order is made by East Suffolk Council ("the authority") under section 119 of the Highways Act 1980 ("the 1980 Act") because it appears to the authority that in the interest of the owner of the land crossed by the footpaths described in paragraph 1 of the order it is expedient that the lines of the footpaths should be diverted.

Mr D Parker has agreed to defray any compensation which becomes payable in consequence of the coming into force of the order, and any expenses which are incurred in bringing the new site of the footpath into a fit condition for use by the public.

Suffolk County Council has been consulted as required by section 120(2) of the 1980 Act and has consented to the making of the order.

BY THIS ORDER:

1. The public rights of way over the land situated at Wenhaston and shown by a bold continuous lines on the map contained in this order and on the Definitive Map and described in part 1 of the schedule to this order shall be stopped up with effect from the date on which Suffolk County Council certifies that the work to bring the new site of the footpath described in paragraph 2 of this order into a fit condition for use by the public has been carried out. Certification shall not take place prior to the creation of the new routes described in paragraph 2 of this order.
2. There shall at the end of 30 days from the date of confirmation of this order be public footpaths over the land situated at Wenhaston described in part 2 of the schedule and shown by a bold broken lines on the map contained in this order.

GIVEN under the common seal of East Suffolk Council this 4th day
of July 2025

THE COMMON SEAL OF)
EAST SUFFOLK COUNCIL)
was hereunto affixed in the presence of:)

Mr MARTIN CLARK
LICKWILL PARADE AND
ROSE CRAN CATERA

Authorised Officer



1659

SCHEDULE

Part 1

Description of Site of Existing Path

Wenhaston Public Footpath 1 (part) – The entire width of that part of Wenhaston Public Footpath 1 commencing at point A at Ordnance Survey grid reference TM41427501 and proceeding in a north easterly direction from Bartholomew's Lane immediately south of the poultry houses and then across an agricultural field for approximately 344 metres to point B at Ordnance Survey grid reference TM41757511 and continuing in a north easterly direction across an agricultural field for approximately 115 metres to point C at Ordnance Survey grid reference TM41867514; this being the route shown between points A – B – C on the order map.

Wenhaston Public Footpath 25 (part) – The entire width of that part of Wenhaston Public Footpath 25 commencing at the aforementioned point B and proceeding in a generally south easterly direction across an agricultural field for approximately 218 metres to point D at Ordnance Survey grid reference TM41887496; this being the route shown between points B – D on the order map.

Part 2

Description of Site of New Path

Wenhaston Public Footpath 1 (part) – Commencing at point E at Ordnance Survey grid reference TM41467494 approximately 79 metres south from the aforementioned point A on Bartholomew's Lane in a easterly direction for approximately 5 metres across a 2 metre wide culvert adjacent to a field gate to point F at Ordnance Survey grid reference TM41477494 then in a south easterly direction following the eastern side of the field edge boundary for approximately 32 metres to point G at Ordnance Survey grid reference TM41487491 then in a north easterly direction following the northern side of the field edge boundary for approximately 184 metres to point H at Ordnance Survey grid reference TM41667497 where it crosses an existing field boundary then continues in a north easterly direction following the northern side of the field edge boundary for approximately 131 metres to point I at Ordnance Survey grid reference TM41787500 then in a southerly direction following the eastern side of the field edge boundary for approximately 57 metres to point J at Ordnance Survey grid reference TM41797495 then in a generally easterly direction following the northern

side of the field edge boundary for a final distance of approximately 98 metres to the aforementioned point D; this being the route shown between points E – F – G – H – I – J on the order map.

Width: 2 metres

Wenhaston Public Footpath 25 (part) – Commencing at the aforementioned point C and proceeding in a southerly direction across an agricultural field for approximately 178 metres to the aforementioned point D; this being the route shown between points C – D.

Width: 2 metres



1059
1-6

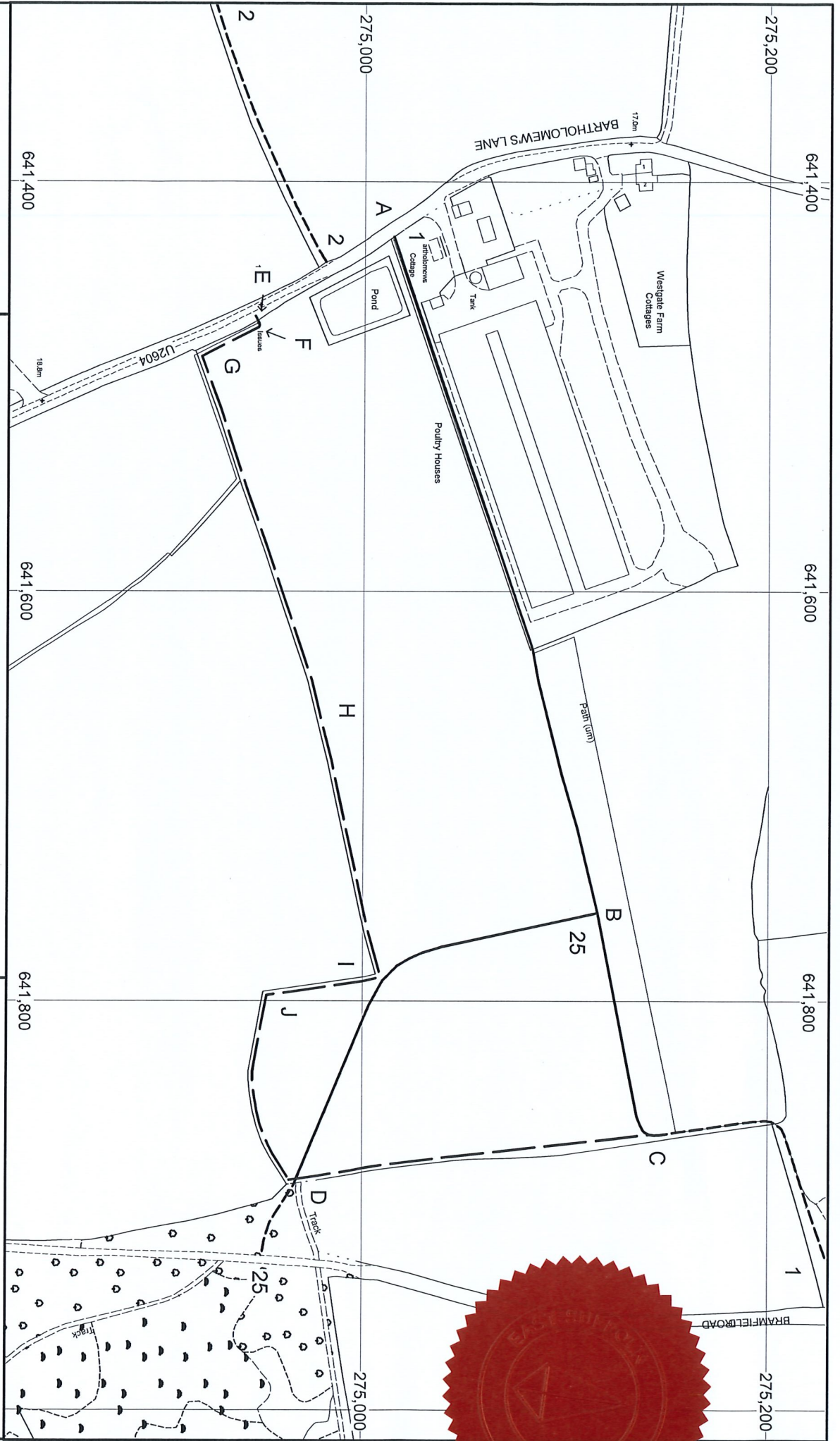

- Footpath to be diverted (A-B-C) (B-D)
- Proposed Footpath (E-F-G-H-I-J-D) (C-D)
- Unaffected footpath



Scale: 1:2,500 at A4

EAST SUFFOLK COUNCIL
PUBLIC PATH DIVERSION ORDER 2025
WENHASTON FOOTPATH 1(PART) AND
WENHASTON FOOTPATH 25(PART)