

Northern Transport Forum

Tuesday 6th February 2024
7pm

A landscape photograph of a field at sunset, framed by a large teal circular graphic. The field is filled with tall grasses, some green and some golden, under a sky with soft, colorful clouds. The teal graphic is a large circle with a thick, curved border that frames the central text.

Welcome and Introductions

Forum Chairs



Brian Stewart OBE, Chair of the Northern and Southern Transport Forums.

Also Chair of trustees for Papworth Trust and the Anglian Great Ouse Regional Flood and Coastal Committee.



Christine Abraham, Community Forum Chair

Former CEO of Community Action Suffolk

Sizewell C Team

Isaak Manolis
Project Manager AD1

Richard Bull
DCO Lead

John Craddock
Project Manager AD3

Rebecca Calder
Community Environment Manager

Chris Heaney
Sizewell C Transport Coordinator

Marjorie Barnes
Head of READ

Jez Porter
SPM Associated Development- Highways

Richard Knight
Senior Community Relations Manager

John Hicks
Technical Director WSP

Zoe Botten
Community Relations Manager



Agenda

- 1. Purpose of the forum – Terms of Reference**
- 2. DCO Implementation**
- 3. Updates**
- 4. Q&A**
- 5. Chairs Concluding Remarks**
- 6. Date of the next meeting**



SZC Forum
Trinity Park, Felixstowe Road,
Ipswich, Suffolk, IP3 8UH

Tuesday 9th April 2024
19:00 – 21:00



**Main
Development
Site Forum**

Leiston Town Athletic Association, Victory Road, Leiston,
Suffolk, IP16 4DQ

Tuesday 16th January 2024
18:30 -20:30

Tuesday 16th April 2024
18:30 -20:30

Tuesday 16th July 2024
18:30 – 20:30

Tuesday 15th October 2024
18:30 - 20:30



**Northern
Transport
Forum**

Stratford St Andrew Riverside Centre, Great Glemham
Road, Stratford St Andrew, Suffolk, IP17 1LL

Tuesday 6th February 2024
19:00 – 20:30

Wednesday 8th May 2024
19:00 – 20:30

Wednesday 7th August 2024
19:00 – 20:30

Wednesday 6th November 2024
19:00 – 20:30



**Southern
Transport
Forum**

Stratford St Andrew Riverside Centre, Great Glemham
Road, Stratford St Andrew, Suffolk, IP17 1LL

Monday 12th February 2024
19:00 – 20:30

Wednesday 15th May 2024
19:00 – 20:30

Wednesday 14th August 2024
19:00 – 20:30

Wednesday 13th November 2024
19:00 – 20:30

Purpose of Northern Transport Forum



TO PROVIDE
PROJECT
INFORMATION OF
RESPECT OF
RELEVANT
CONSTRUCTION
ISSUES AND
PROGRESS



ENABLE LOCAL
ELECTED
REPRESENTATIVE
TO ASK QUESTIONS
AND RAISE
QUESTIONS OF
CONCERN.



INFORM SZC ON
KEY ISSUES
AFFECTING THE
LOCAL COMMUNITY
IN THE IMMEDIATE
VICINITY OF THE
NORTHERN
TRANSPORT SITES

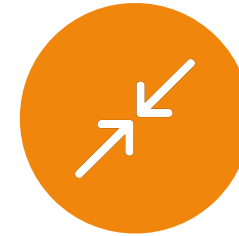

TO FIND WAYS TO
MINIMISE THE
IMPACTS AND
MAXIMISE THE
BENEFITS.



ANY
RECOMMENDED
ACTIONS FROM THE
NTF WILL BE
ESCALATED BACK
TO THE DELIVERY
STEERING GROUP

Working Groups and Forums

REVIEW GROUPS

PLANNING GROUP

ENVIRONMENT REVIEW

TRANSPORT REVIEW

SOCIAL REVIEW

ECONOMIC REVIEW



WORKING GROUPS

B1125 WORKING GROUP

B1122 EARLY YEARS WORKING GROUP

YOXFORD WORKING GROUP

LEISTON WORKING GROUP

RIGHTS OF WAY WORKING GROUP

WICKHAM MARKET WORKING GROUP

MARLESFORD AND LITTLE GLEMHAM WORKING GROUP



MAIN DEVELOPMENT SITE FORUM

Through the Main Development Site Forum, representatives from communities located in the immediate vicinity of the Main Development Site of Sizewell C can raise and discuss construction progress and key issues affecting the local community.



ANNUAL COMMUNITY FORUM

The Annual Community Forum meeting will be open to the East Suffolk community, to hear updates on the work of the Main Development Site Forum, the Southern Transport Forum, and the Northern Transport Forum. We'll discuss key issues for local communities and ways to minimise impacts and maximise benefits to those living and working nearby.



NORTHERN TRANSPORT FORUM

The Northern Transport Forum is where we'll discuss all things road and rail, with representatives from communities located in the immediate vicinity of the Northern Park and Ride Site, Yoxford roundabout and other highway improvement works sites, and Sizewell Link Road.



SOUTHERN TRANSPORT FORUM

In this Forum, we'll focus on road and rail transport issues and opportunities, with representatives from communities located in the immediate vicinity of the Southern Park and Ride Site, Freight Management Facility Site, and the Two Village Bypass Site.

Project Progress Overview



Transport Review Group

SZC Co's approach to engagement with the local community was agreed as part of the DCO. This is summarised in Plate 5.1.

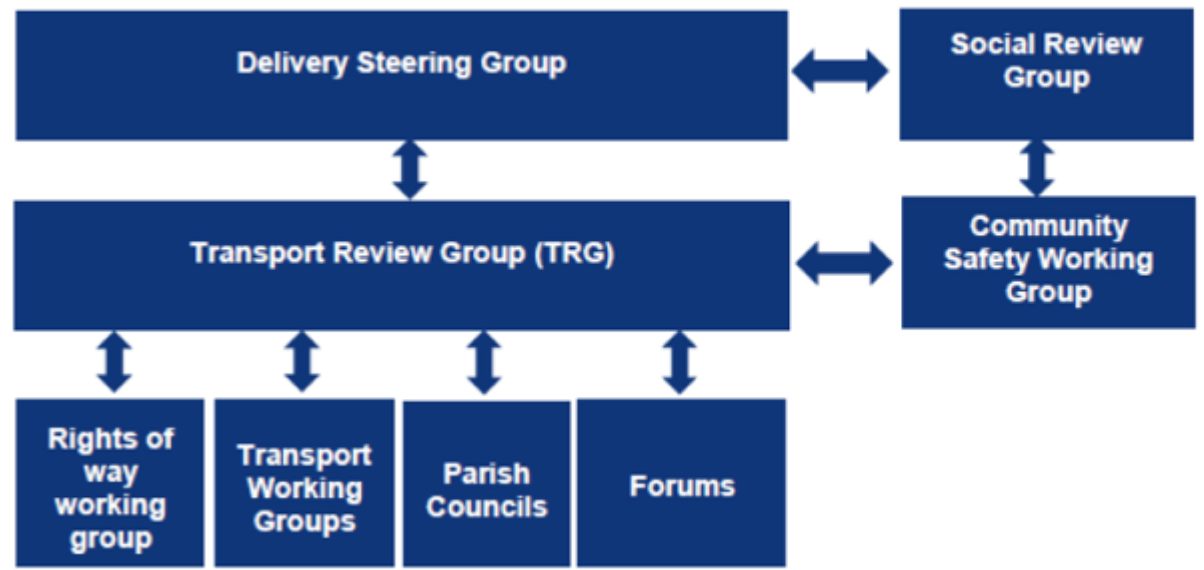

HGV Management

The Construction Traffic Management Plan (CTMP) includes prescribed HGV routes and HGV caps as well as other measures and controls.

Initially the cap is 600 two-way HGVs and buses per day (300 each way).

SZC is not expecting to operate at the HGV daily cap until towards the end of 2024.

The HGV caps and routes will be monitored with the Delivery Management System (DMS), which is in operation.

Monitoring data will be reported to the Transport Review Group and the Transport Monitoring Reports made public.

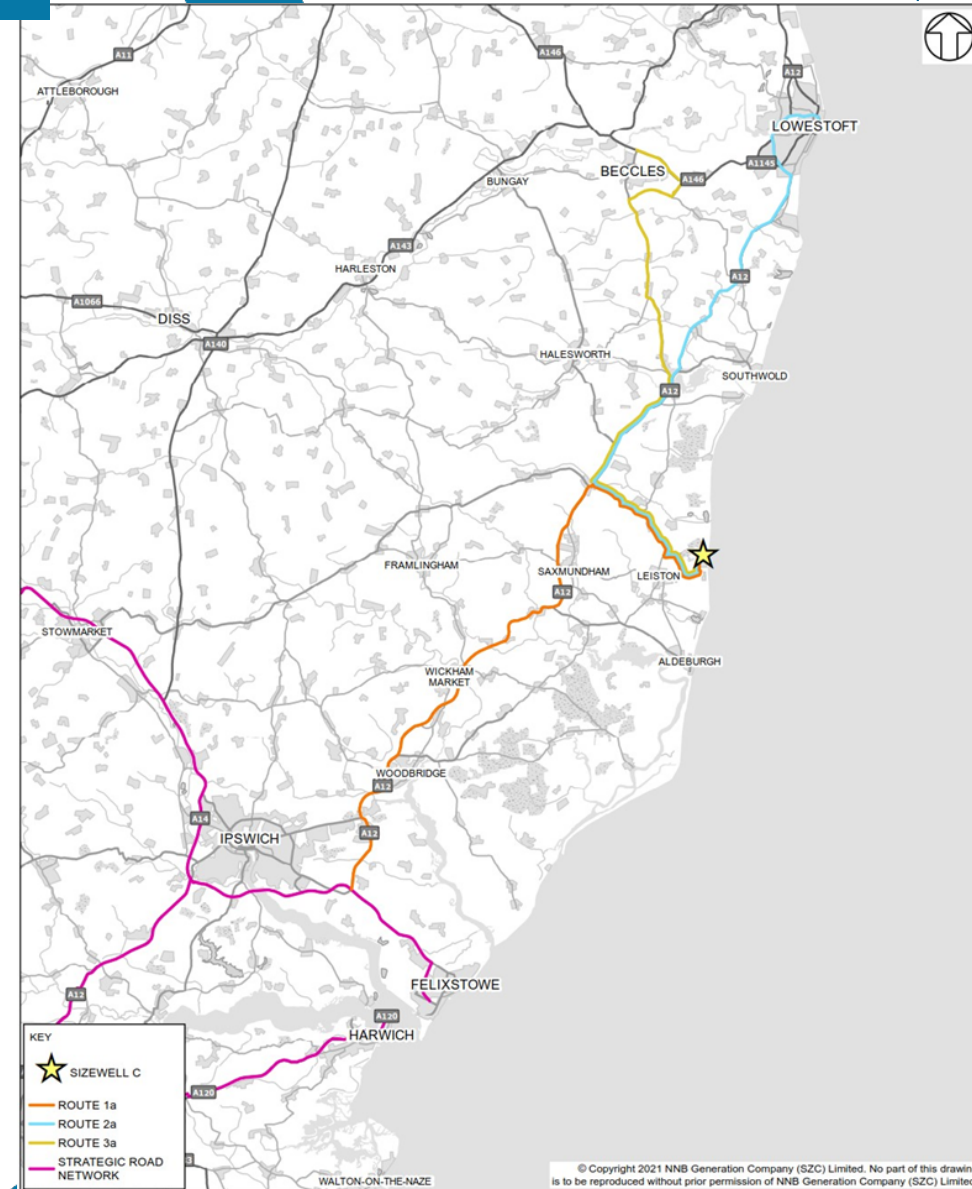

Traffic Management

Countywide Highways Signage



Traffic Management

B1122 Resurfacing

Diversion route for Closure
(South down A12 to Saxmundham & along the B1119)

Resurfacing work along the B1122 (3.5KM total incl. Ironwork adjustment)

March 2024

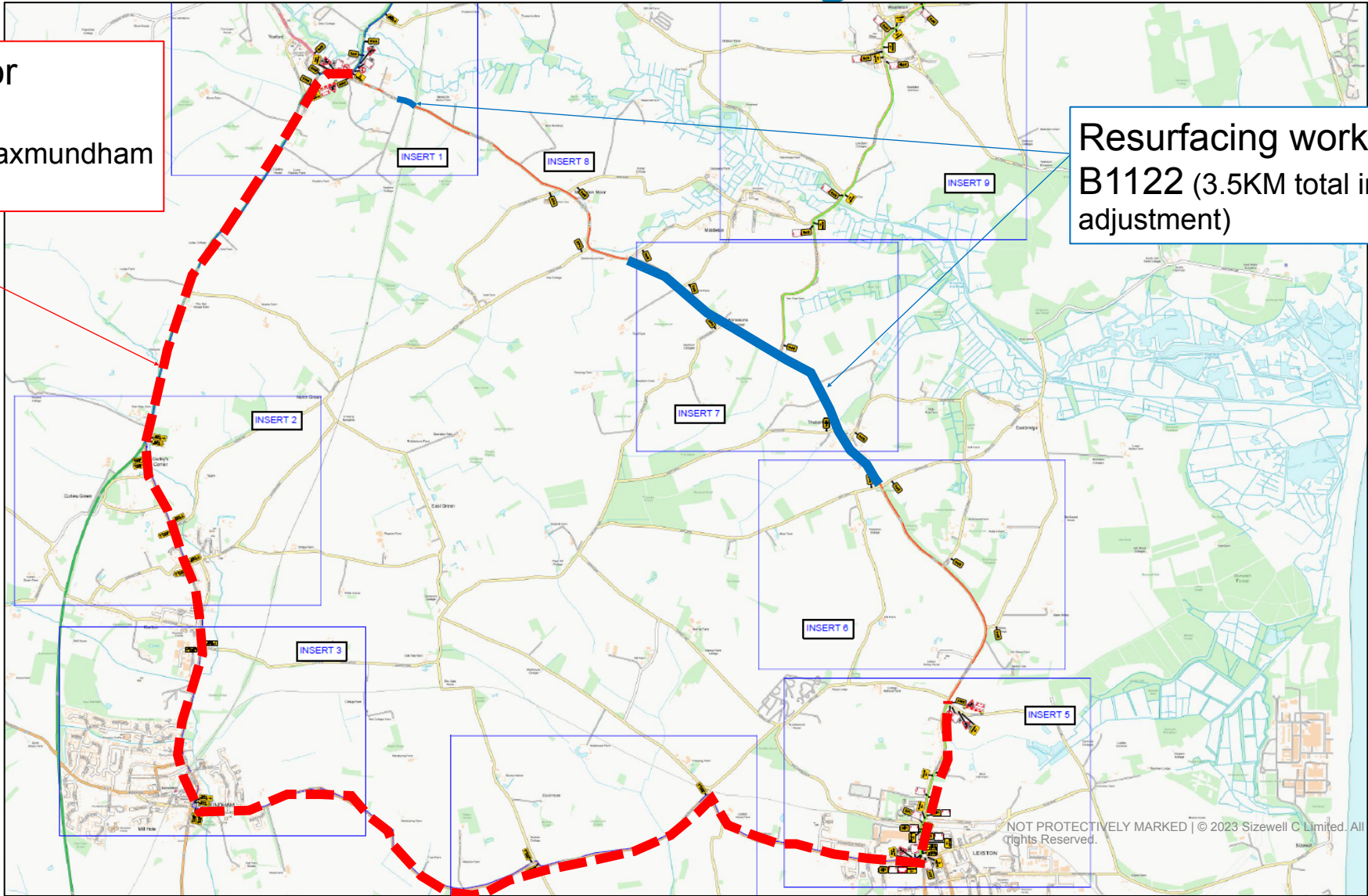

Speed Limits and Compliance

- Lover's Lane – DCO powers for temporary 30mph / permanent 40mph.
- SZC Co is liaising with the authorities and Town / Parish Councils to monitor speed compliance on the B1122 and B1125.
- A12 average speed cameras - to be operational from Spring 2024 for ~8wks opposite Friday St.

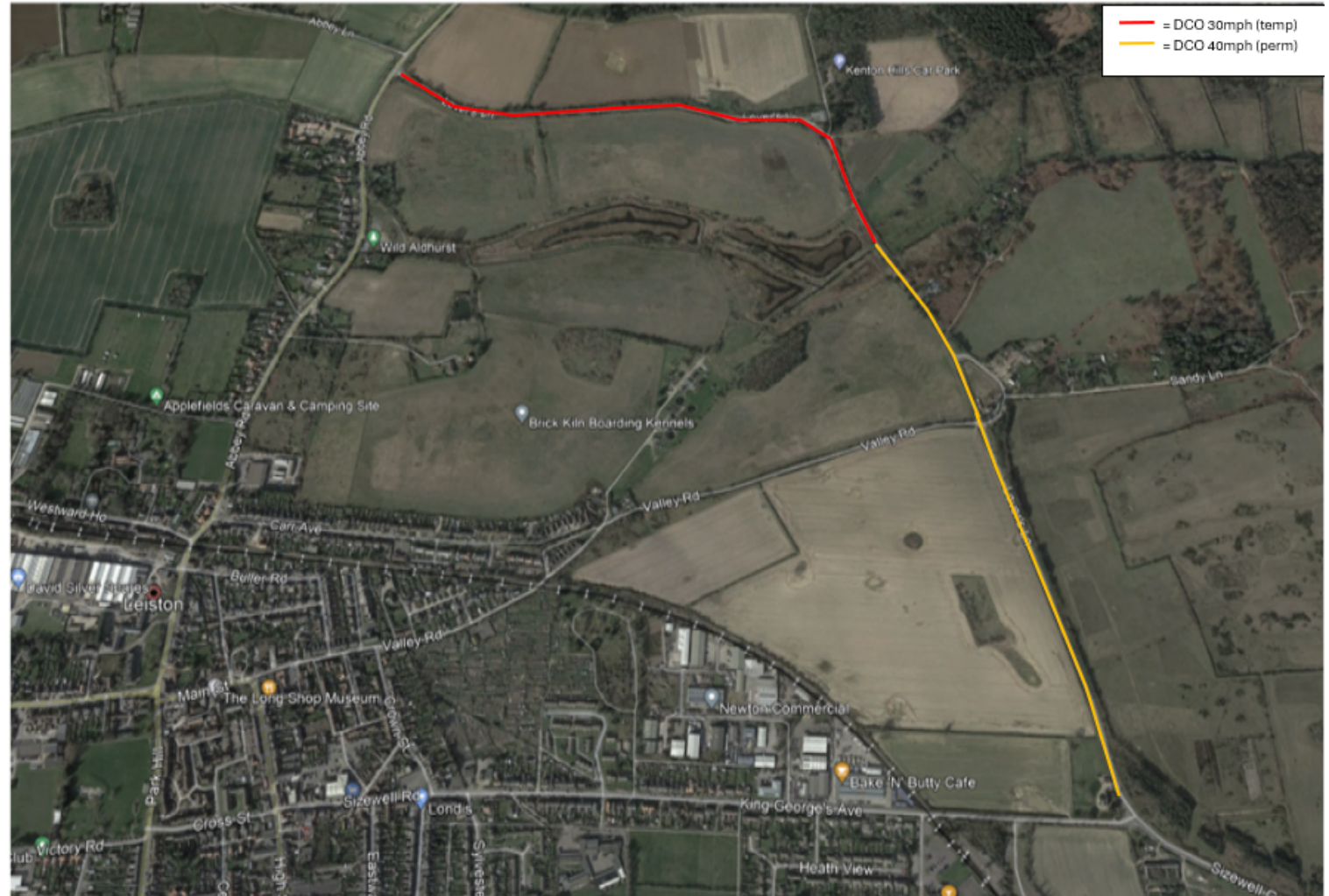

Traffic Management

Schemes – Phase 1 H1 2024

- Aldhurst Farm Access Improvement
Circa 1 week, lane closure
- Upper Abbey Farm Drive Access
Circa 1-week, Private Road Closure/
Limited Access
- ACA Secondary Access
Circa 1 week lane closure
- B1122 Resurfacing
Rolling TM through Q1

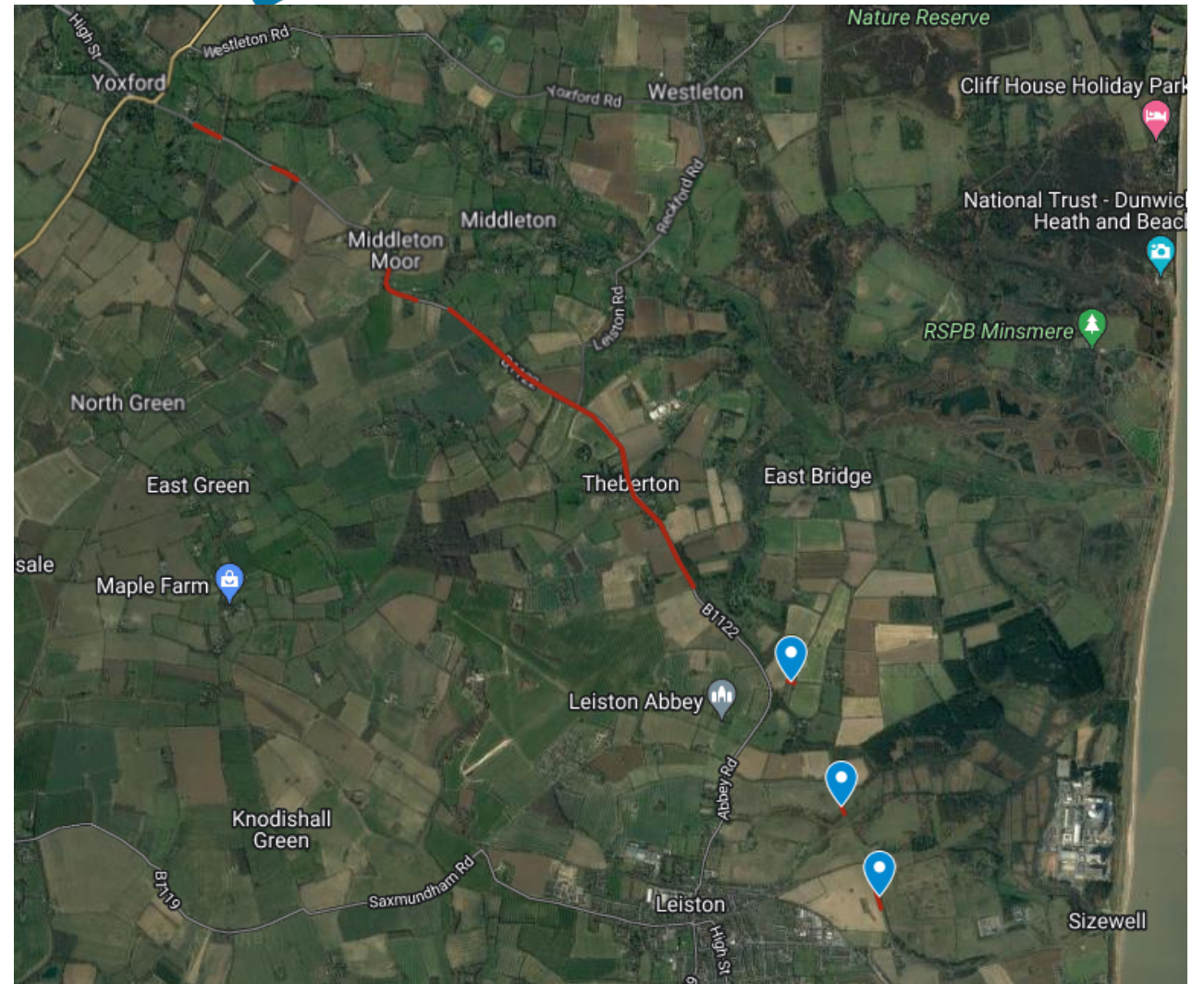

Traffic Management

Schemes – Phase 2 H1 2024

- Buckleswood Road Access Install
Circa 1 week lane closure
- Green Rail Route Access Install
Circa 1 week lane closure
- Yoxford Access Install
Private Road limited accesses circa 1 week
- Middleton Moor Access
Circa 2 week Road Closure

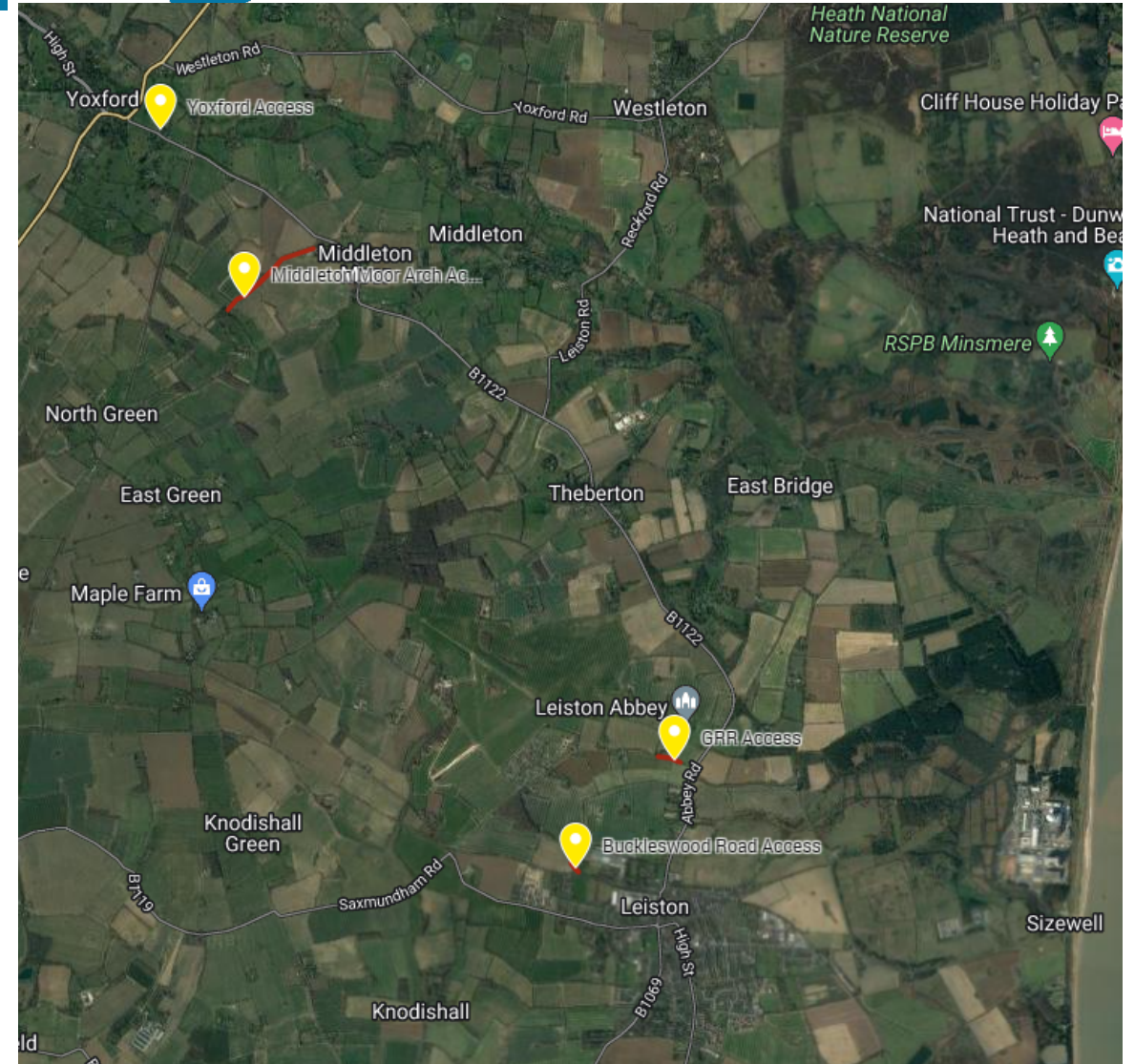

Off Site Infrastructure (OSI) Major Highway

Sizewell Link Road

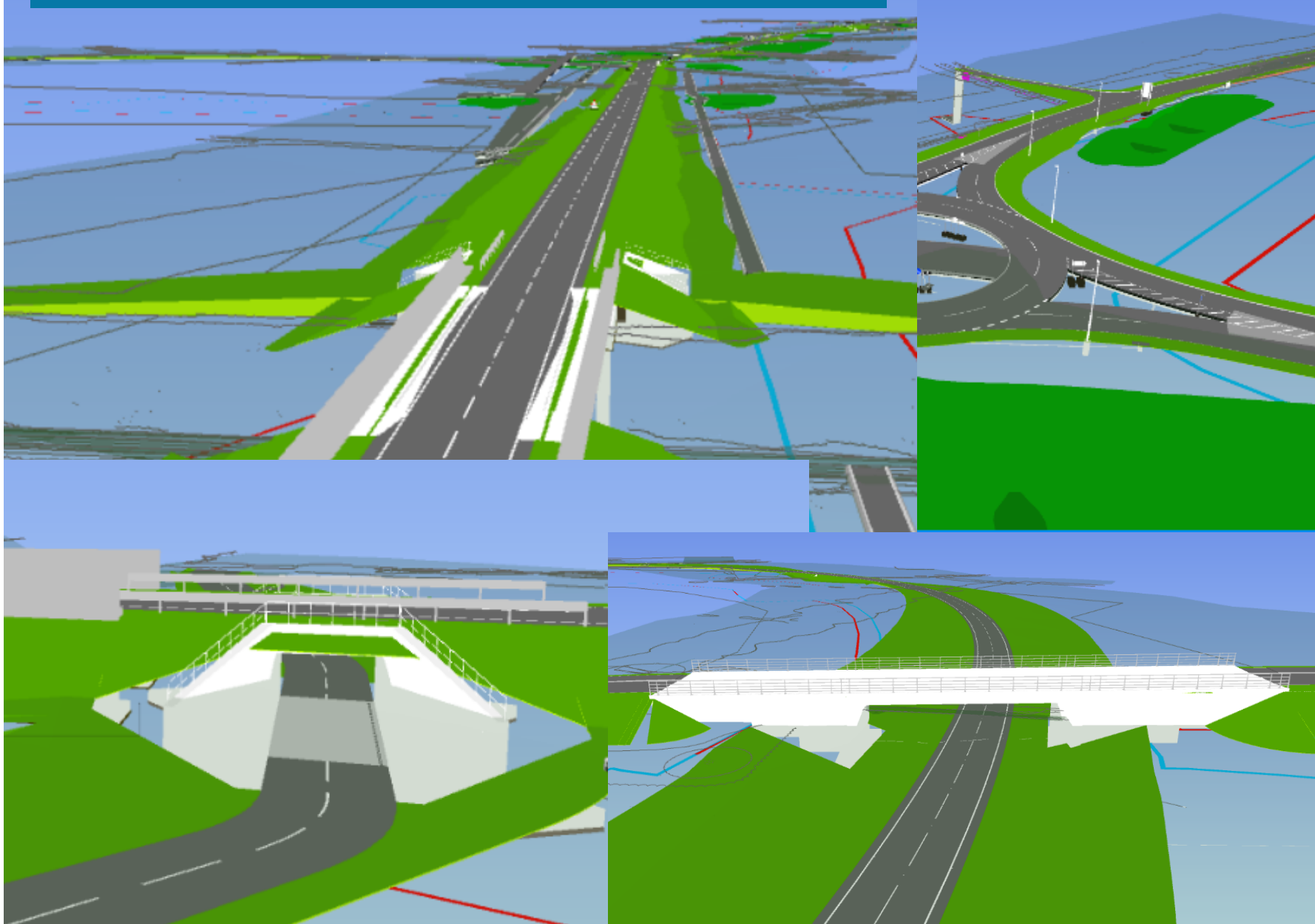



Jan 2024 Update

- Detail design ongoing. working with SCC Highways to develop opportunities
- Archaeology clearance for access to Rail overbridge
- Ecology clearance required for access
- Main construction to start in 2025
- Land will be transferred to SCC as adoptable highway.
- Utility works planned pre-construction

Sizewell Link Road

STAGE 1 – SITES 7, 8 & 9

-  - Spoil storage
 -  - proposed compound location
 -  - plant compound
- Note these are not to scale

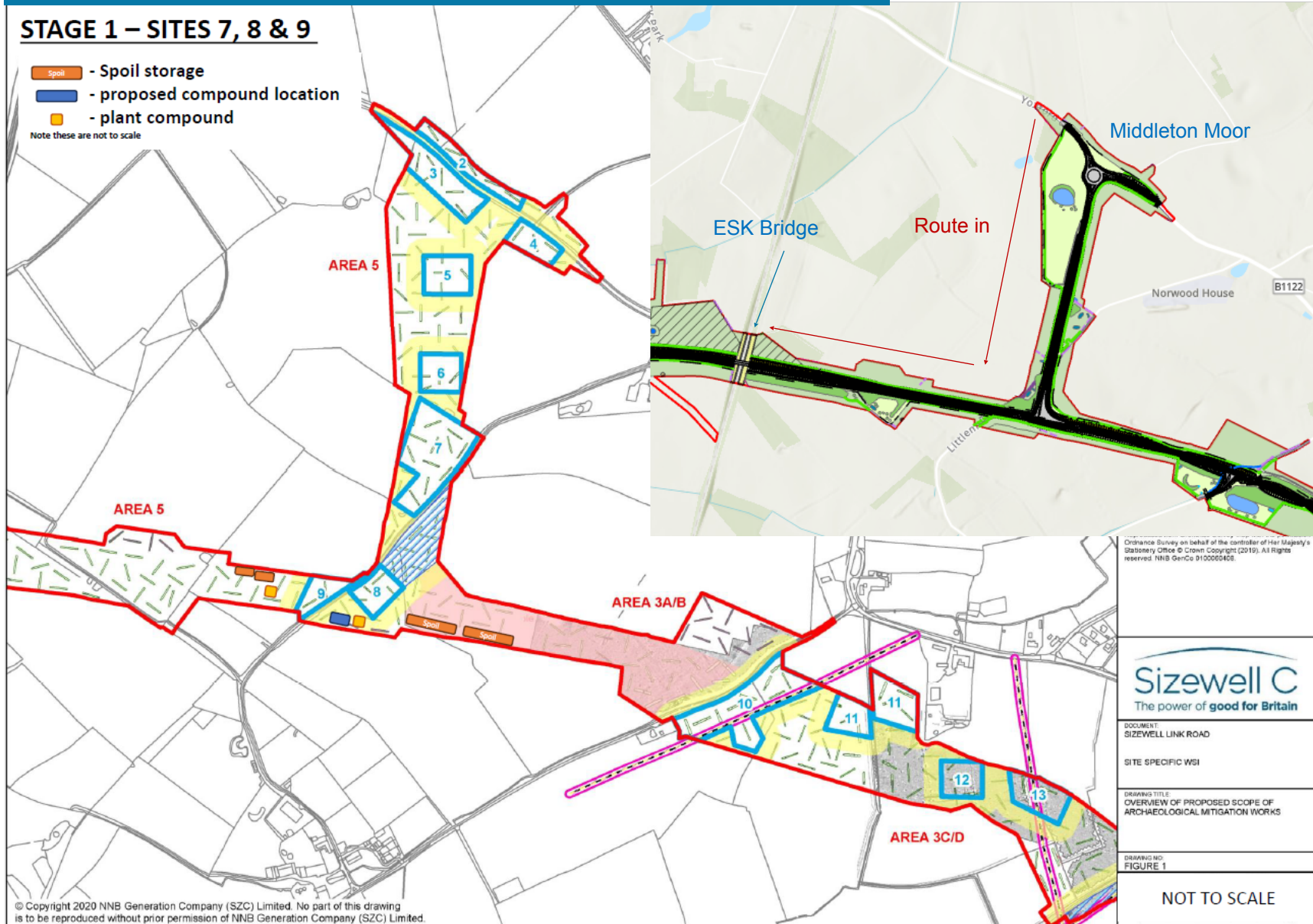

© Copyright 2020 NNB Generation Company (SZC) Limited. No part of this drawing is to be reproduced without prior permission of NNB Generation Company (SZC) Limited.

Site Works in 2024

- Archaeology clearance for access to Rail overbridge
- Circa 10 months' work to set piece excavations
- Ecology clearance required for access
- Overbridge is project critical

Yoxford Roundabout

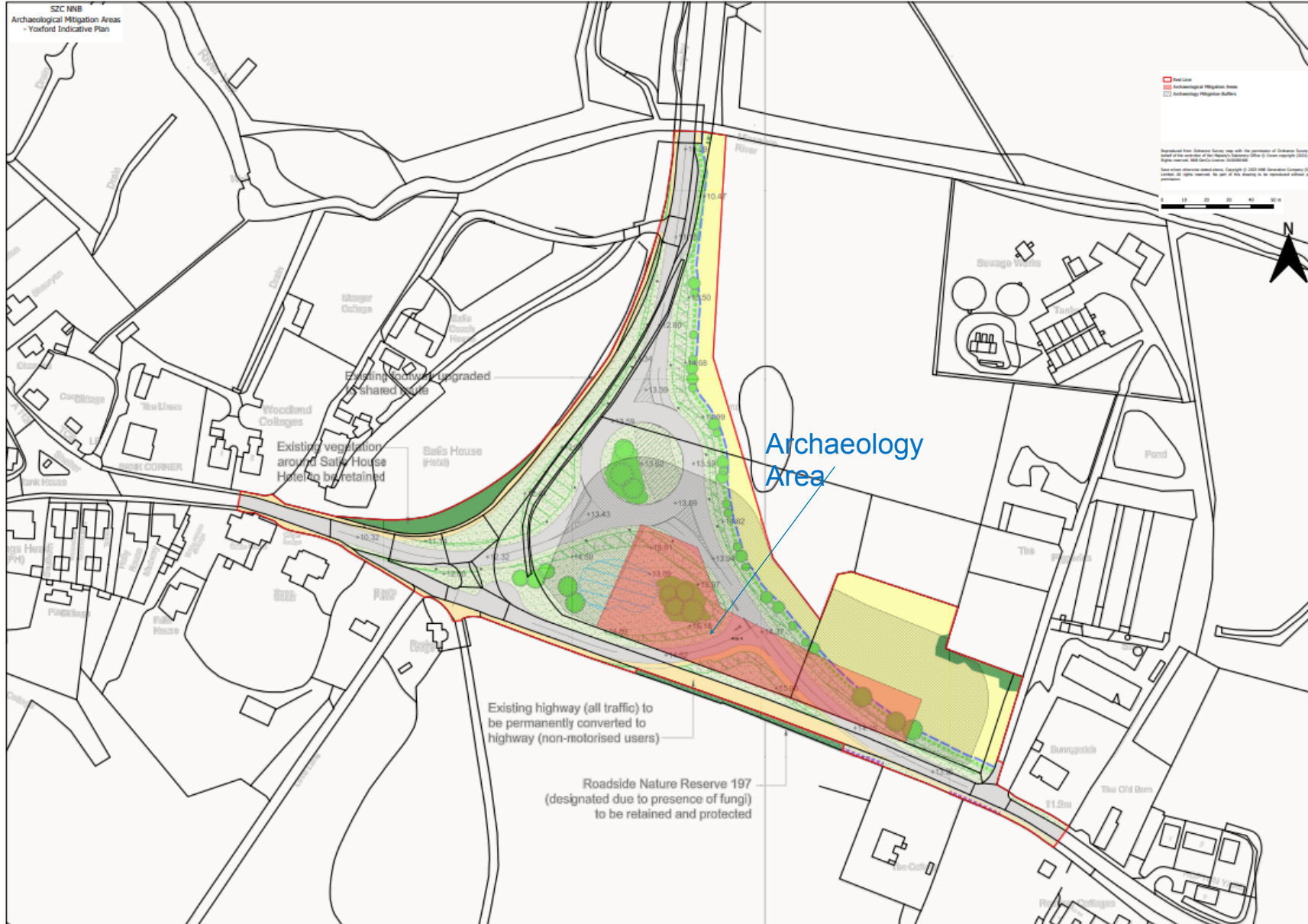

Yoxford Update

- Yoxford is a key early years' mitigation and safety improvement
- Detail design is complete and now with SCC for comment and approval
- Archaeology clearance for access to build roundabout expected Summer 24
- Minor ecology clearance required for access to fields
- Circa 8 weeks' work to set piece excavations depending on finds
- Utilities diversions required to Openreach and Essex & Suffolk water apparatus prior to main works. Dates to be agreed.
- Land will be transferred to SCC as adoptable highway.
- Main construction to follow on in late 2024 early 2025.
- Construction period expected to be nine months. To be agreed with contractor once appointed.
- Tie in to A12 to be managed avoiding the need for long duration disruption to the network.

Northern Park and Ride



Key activities and timescales

- Detailed design underway and to be completed by Q3-24.
- Ongoing engagement with SCC-Highways for public road designs
- Limited-extend on-site surveys planned for Q1/Q2-24
- Construction of temporary site access and temp. site establishment works (in support of Archaeology and Vegetation Clearance works), planned for Q2-24
- On site early works (archaeology, ecology) will last 5-7 months; to be completed by end of 24.
- Utility Diversions (Telecom, Power, Water) planned for Q3/4-24. Detailed schedules and plans are being developed in collaboration with statutory undertakers.
- Main construction works to commence in Q1-25.
- Construction period expected 12-15 months.
- North Park & Ride to be operational early-2026. (Opportunity for earlier partial operation is examined, if necessary)
- Working closely with the Rail-projects and Network Rail with regards to the Darshan Level Crossing upgrade.

Noise Mitigation Scheme

- **Noise Mitigation Scheme** is secured in the Deed of Obligation (DoO) Schedule 12, Annex W.
- Mirrors the government **Noise Insulation Regulations** (1975 (as amended 1988):
 - - Secondary glazing and mechanical ventilation
- More precautionary in that:
 - - Regs only apply to new or amended roads (kerb line)
 - - NMS includes existing roads – to be equitable
 - - Regs do not have a separate night-time threshold, NMS does

Eligibility for NMS

- The B1122 Properties as listed in the DoO Schedule, Annex G
- Others refreshed noise assessments agreed with ESC / SCC (road traffic only)
- Look at absolute levels and change in levels using agreed traffic data from the ES / forecast construction noise

NB:

- Not time limited – properties remain eligible while source of noise which gives rise to eligibility remains (assuming time remains for insulation)
- Welcome feedback from Parish Councils – any residents that may need extra support / any issues arising in the Community

How it Works

- Actions Sizewell C undertakes
- Actions the property owner undertakes



B1122 Vibration Scheme

- In response to consultation and the link road being built in the early years (rather than pre-commencement)
- Applies to the list of **The B1122 Properties** listed in Annex G of the DoO only (residential scheme only)
- Secured in second deed of variation to the DoO
- Invitation letters sent December 2024, reminder sent January 2024
- Time limited – response by 31 January 2024
- Surveys by May 24 – to be repeated following opening of Sizewell link road

Q & A

- Darsham Parish Council
- Kelsale-cum-Carlton Parish Council
- Theberton and Eastbridge Parish Council
- Middleton-cum-Fordley Parish Council

- Yoxford Parish Council
- Thorington Parish Council
- Sibton Parish Council
- Peasenhall Parish Council
- Saxmundham Town Council
- Westleton Parish Council
- Blythburgh Parish Council

- Suffolk County Council
- East Suffolk Council

Northern Transport Forum

DATE OF NEXT MEETING

Wednesday 8th May 2024
19:00 – 20:30

Stratford St Andrew Riverside Centre
Great Glemham Road
Stratford St Andrew
IP17 1LL

Thank you