



Sizewell C Northern Transport Forum

Wednesday 5th February 2025

Darsham Village Hall

Agenda



Item 1: Welcome and Introduction of the Chair and Panel – (Chair)

Item 2: Meeting note and matters arising from Northern Transport Forum **6th November 2024** – (Chair)

Item 3: Report back from: Main Development Site Forum (**15th January 2025**) and Southern Transport Forum (**13th November 2024**) – (Richard Knight)

Item 4: Community Relations – (Marjorie Barnes)

Item 5: Road and Rail Updates – (Dave Peacop, David Seal, Stephen Keighley)

- Northern Park and Ride Site
- Yoxford Roundabout
- Sizewell Link Road
- Other highway improvement schemes
- Rail Overview

Item 6: Specialist update – Landscaping and Ecology (Dr Stephen Mannings and Luke Stevens)

Item 7: Traffic and Transport – (Rebecca Quigg – WSP and Steve Merry – SCC)

Item 8: Q&A – via Town and Parish Council Representative – (Chair)

Item 9: Dates of Future Meetings – (Chair)

Item 1: Welcome and Introductions

Sizewell C Panel

David Peacop	Site Operations Director
David Seal	Offsite Delivery Manager
Marjorie Barnes	Head of Regional External Affairs and Development
Richard Bull	Head of Planning
Richard Knight	Senior Community Relations Manager
Stephen Keighley	Senior Project Manager – Rail
Rebecca Quigg	Transport Co-Ordinator
<u>Specialist Leads</u>	
Dr Stephen Mannings	Water, Ecology and Land SME
Luke Stevens	Land Management Lead
<u>Advisors</u>	
Zoe Botten	Community Relations Manager
Jez Porter	Stakeholder and External Roads Lead
Tim Newton	Site Security Manager
Darren Benford-Brown	Community Safety Officer

Item 2: Meeting note and matters arising from NTF 6th November 2024

Chair

Northern Transport Forum Report

February 2025



Request for notice boards

Working to identify locations and content for information noticeboards

Request for details regarding
archaeology finds

Oxford Cotswold Archaeology developing a programme of exhibition
to showcase some of the finds. Dates to be shared in due course

For Parish Magazines to be used to
update the community

Yoxmere Fisherman and the Tide Collection magazines will be
publishing community updates

Request for Suffolk Constabulary to
become a member of the forum

Independent chair has written to the Chief Constable and received a response to be shared
at the forum

Item 3: Report back from previous Forums

Richard Knight

Item 4: Corporate and Community Relations

Marjorie Barnes, Head of READ

Over the last year we've awarded over £100m in local contracts and have made significant headway in early manufacturing of key components for the power station.



Supporting local businesses

- Sizewell C has signed multiple contracts with businesses across Suffolk, covering everything from construction and aggregates to building supplies and energy systems.
- Today we announced further regional contracts including a £19m contract for Ipswich-based business, Jackson Civil Engineering, who will deliver some of the local roads schemes that you will hear more about tonight.
- New contracts with local third sector partners include agreements with Royal British Legion Industries and a two-year licence to run the Sizewell C site coffee shop for Combat2Coffee, a community interest company which invests profits to benefit veterans, ex-uniformed personnel, their families and communities.



Supporting local employment

- We've now got around 1,000 people driving this project forward both on our main development site and off-site infrastructure, and we'll have around 2,000 people by the end of the year.
- We have 61 apprentices with 52 from local high schools. We will double the number of apprenticeships across this year.
- **As a project we've delivered our key project milestone for the year keeping the project on schedule and budget.**



Supporting local people

- £23m Sizewell C Community Fund with £2m available to local organisations each year for ten years.
- In the first round of awards, nine charities and not-for-profit groups which deliver services in East Suffolk received grants amounting to more than £300,000 with the next group of successful applicants to be announced later this month.



Sizewell C Workforce survey

- Sizewell C's first Site Based Workforce Survey was completed.
- Its objectives are to evaluate accommodation and transport arrangements, assess workforce satisfaction and understand the impact of the project on the local community.

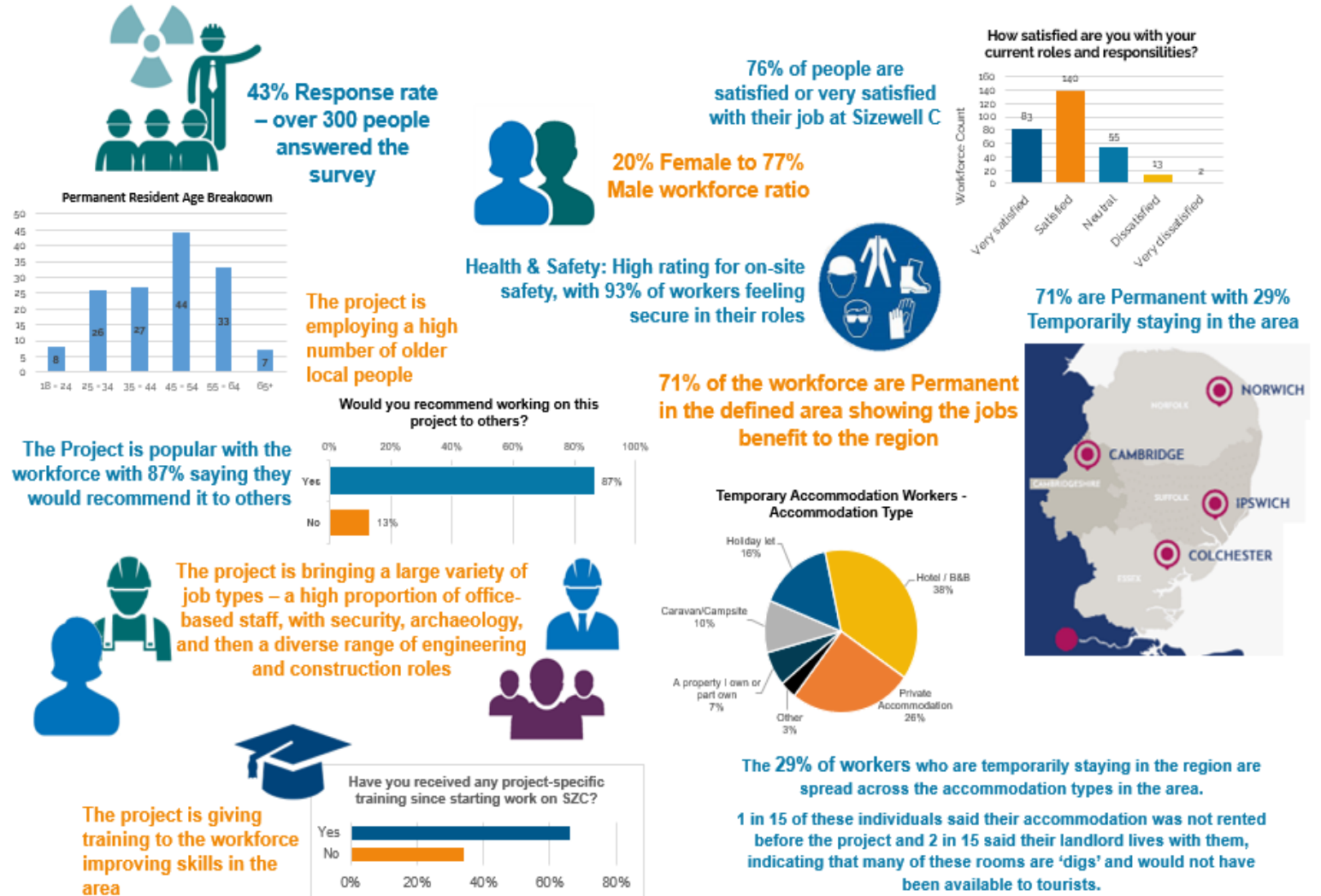

On a scale of 1 - 10, how satisfied are you with the way the forums you attended were conducted?

1 being very unsatisfied and 10 being highly satisfied? (please select one)

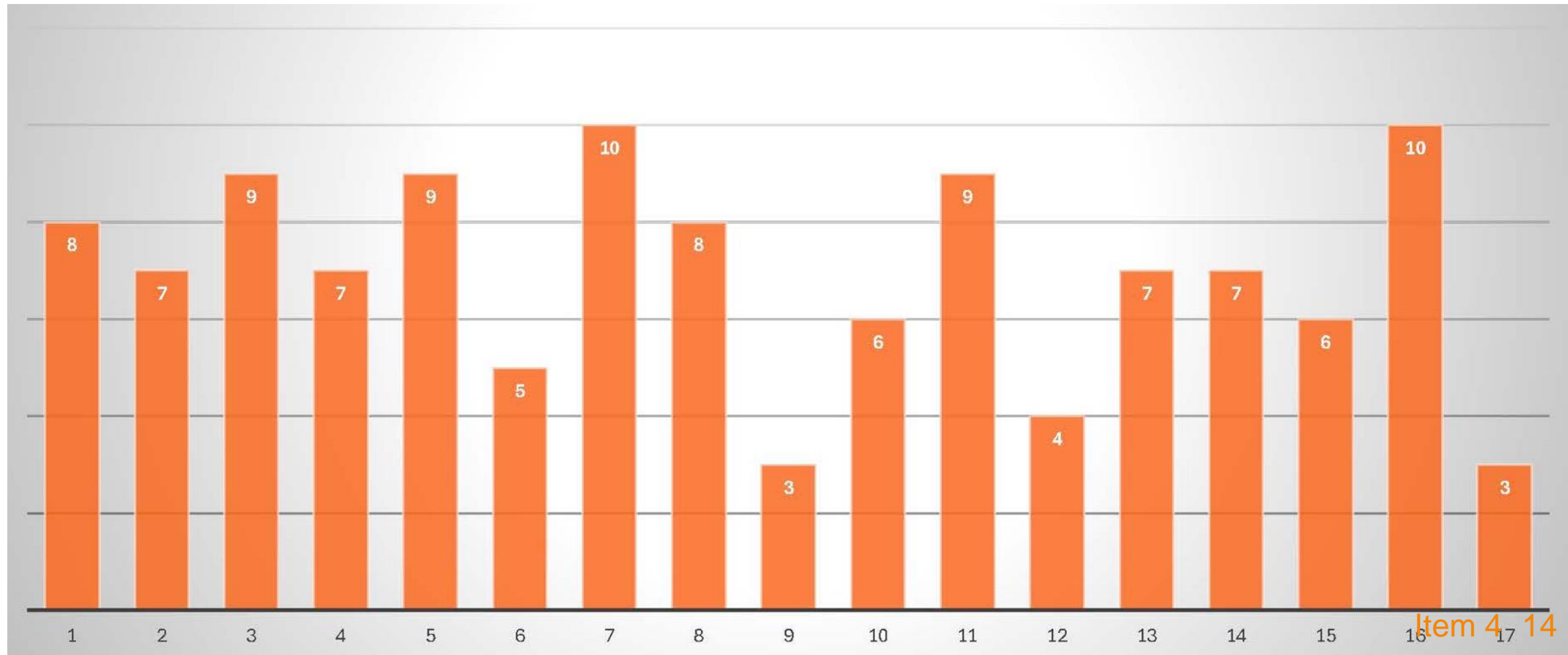

OPEN DAY **22-23 FEB**

ACTIVITIES • ARTEFACTS • TALKS SAT 22 @ 10-4 SUN 23 @ 10-3

**ARCHAEOLOGY
OF SIZEWELL C
DEVELOPMENT SITE**

**WATERLOO CENTRE,
WATERLOO AVE.,
LEISTON, IP16 4HE**

FREE admission to Sizewell C archaeology exhibition

OCA Oxford Cotswold Archaeology

Sizewell C
The power of good for Britain

Item 5: Road and Rail Update

David Peacop, David Seal, Stephen Keighley

Site Delivery Lookahead

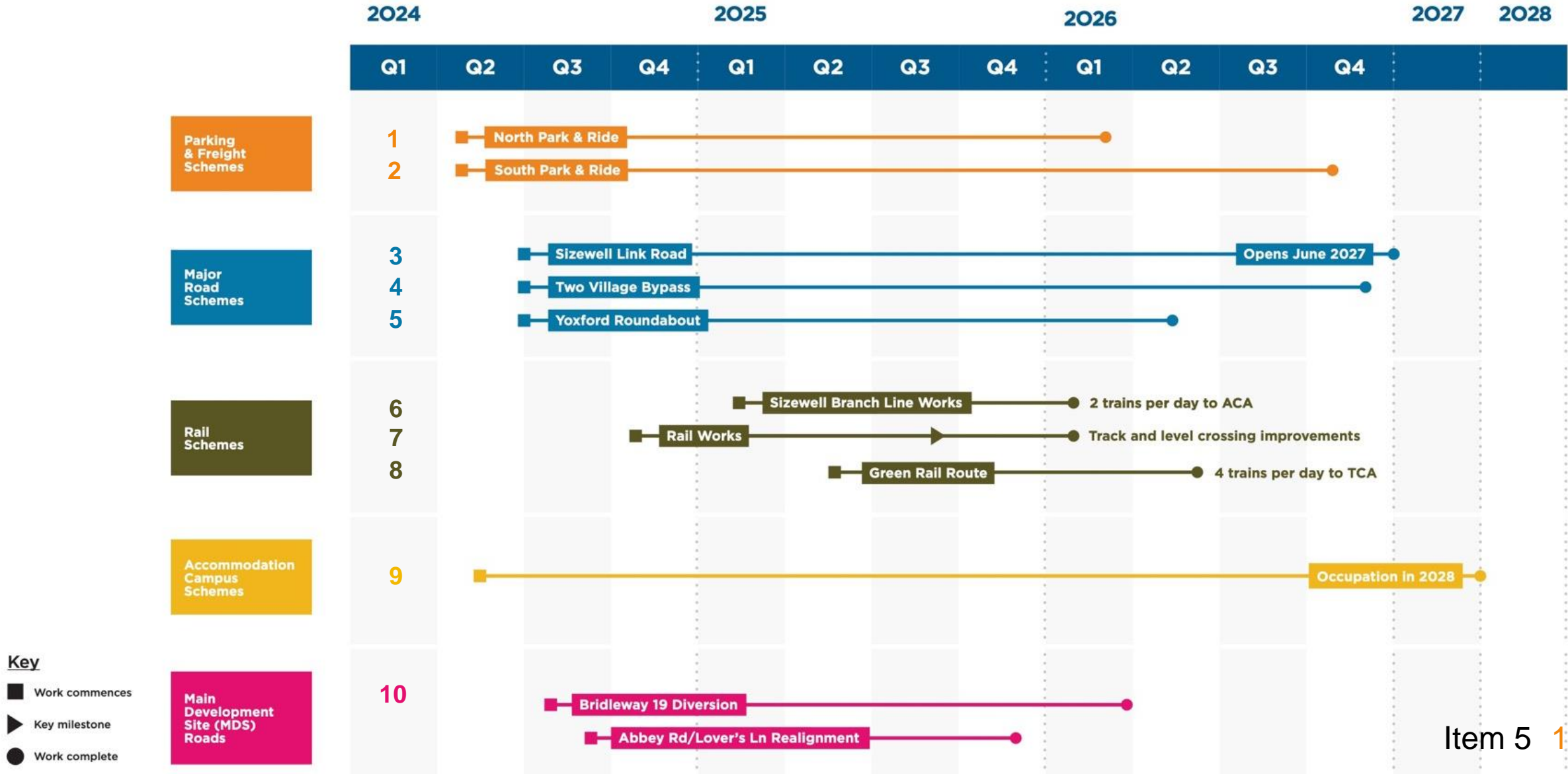

Countywide Highways Signage – Semi Permanent Q1/ Q2 25



Average Speed Cameras Q1/Q2 2025

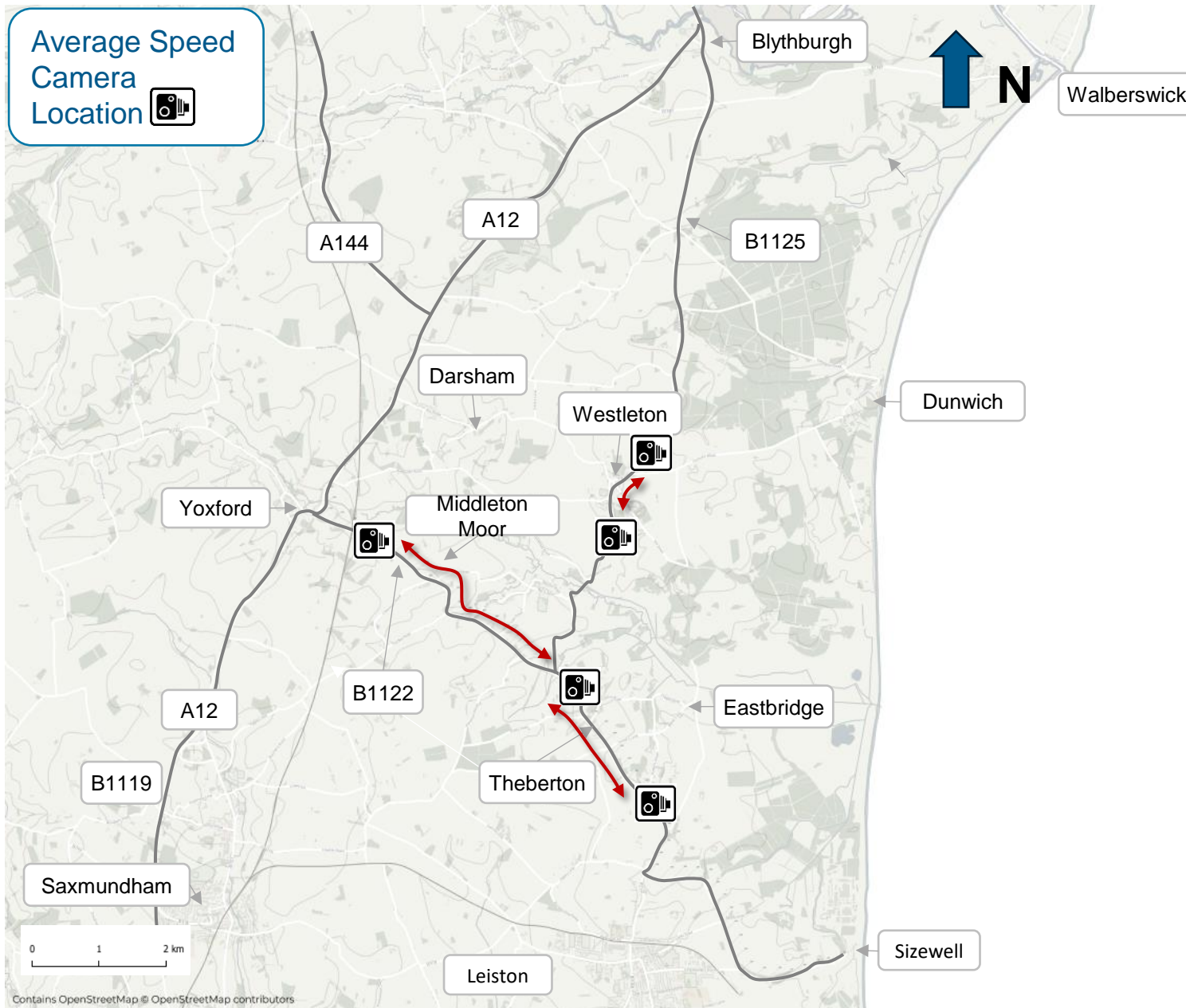

Average Speed Camera Enforcement

- B1122 from Yoxford to Eastbridge Road / Sizewell C main site access.
- B1125 through Westleton.

Next Steps

- Installation is targeted for Q1.
- There will be communications in advance to let people know, and explain how the cameras will work.
- Data from the cameras will be collected by the police, and will be reported via their channels.

Northern Park and Ride (NPR) Early Works Q1 + Q2 25

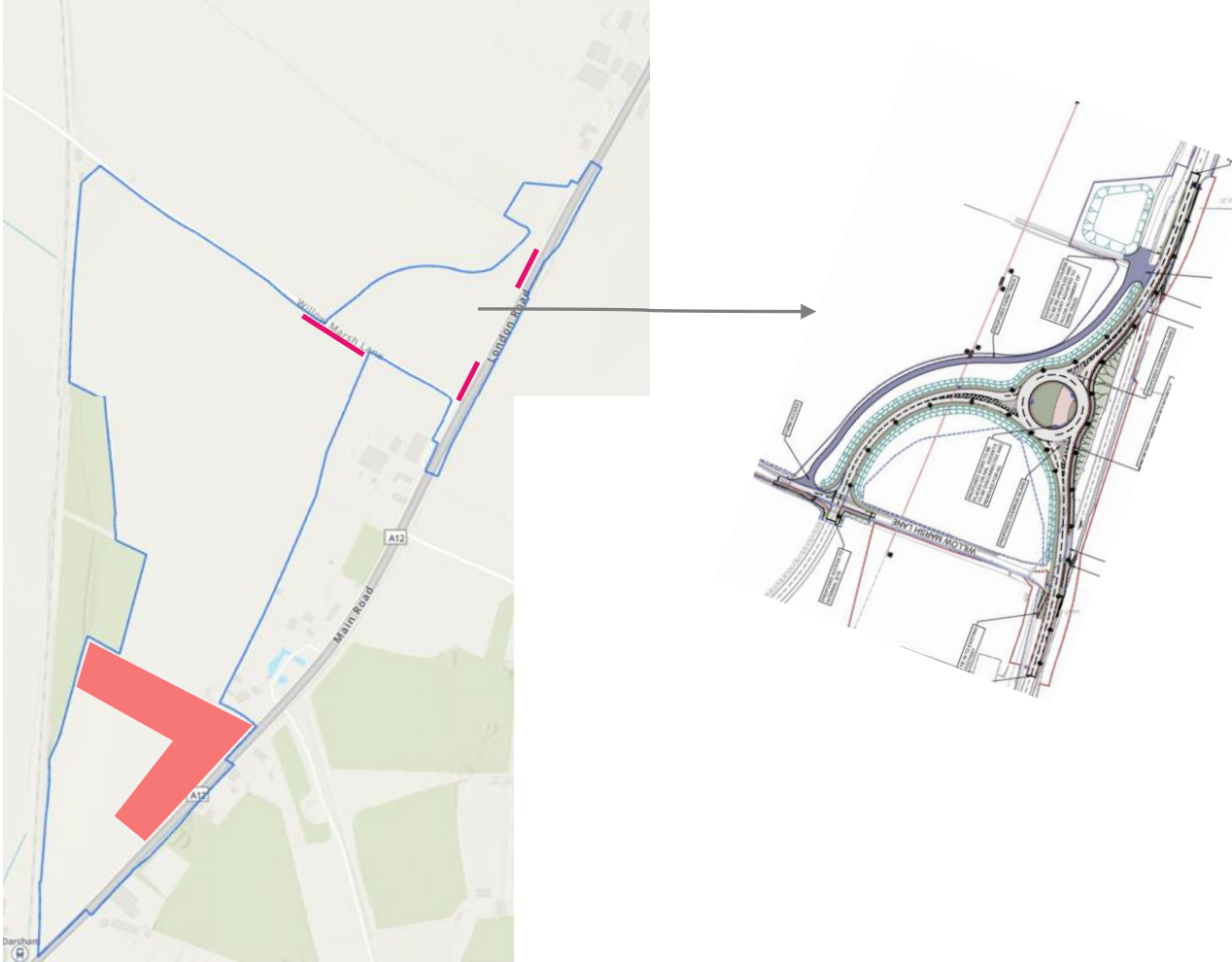

Q4-24 (Completed)

- Vegetation Clearance (Willow March Lane)

Q1-25:

- Temporary site Access from Willow March Lane – started Jan 25 (Completed)
- Archaeology (ca. 3-months) - starting March 25
- Vegetation Clearance (along A12 – roundabout tie-in points)

2025 onwards:

- Roundabout works (Q2-25)
- Main Works (Q2-25 till Q3-26)
- Partial operation (Q3-25)



Sizewell C
The power of **good for Britain**

Walpole Rd

Bramfield House School

Bramfield

Thorington Road

A144

Sibton Green

New Road

Willow Marsh Lane

A12

To Yoxford

Priory Paddocks Nursing Home

Darsham

The Street

Fox Lane

River Yox

A1120

0.6km

Pease

Worth Road

North Road

Footpath



Ordnance
Survey extract
- showing
footpaths

Yoxford Roundabout Early Works Q1 + Q2 2025

Pre-Construction Activities at Yoxford Roundabout

- Vegetation Management
- Archaeology Mitigation (Completed Jan 25)
- Site Security & Fencing (Completed Nov 24)
- Utility works planned Q1 2025

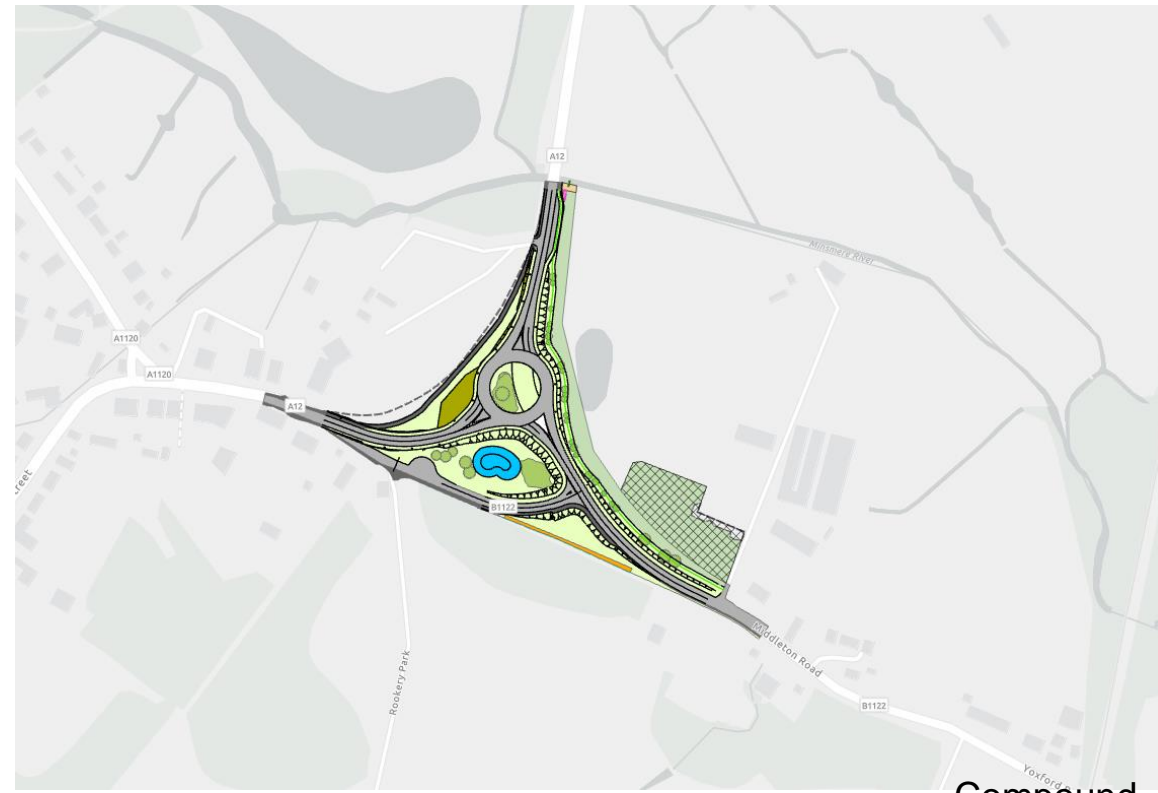
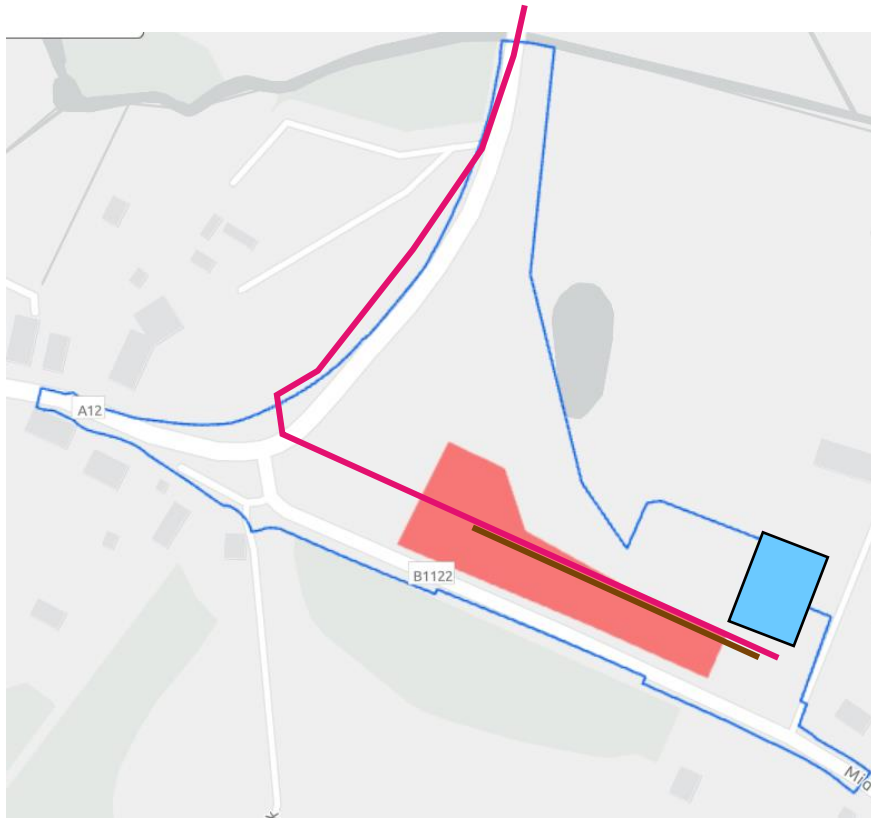

NOT PROTECTIVELY MARKED | © 2023 Sizewell C Limited. All rights Reserved.



Archaeology



Vegetation Clearance



Utilities



Compound

Item 5 22

NOT PROTECTIVELY MARKED | © 2023 Sizewell C Limited. All rights Reserved.

Sizewell Link Road Q1+Q2 2025

Pre-Construction Activities at Sizewell Link Road

Middleton Moor Spur: • Vegetation Management (Phase 1 complete in Dec 24, Phase 2 to start Feb 25) • Archaeology Mitigation • Site Security & Fencing (Complete to support Archaeology) • Main Works Commence Q2

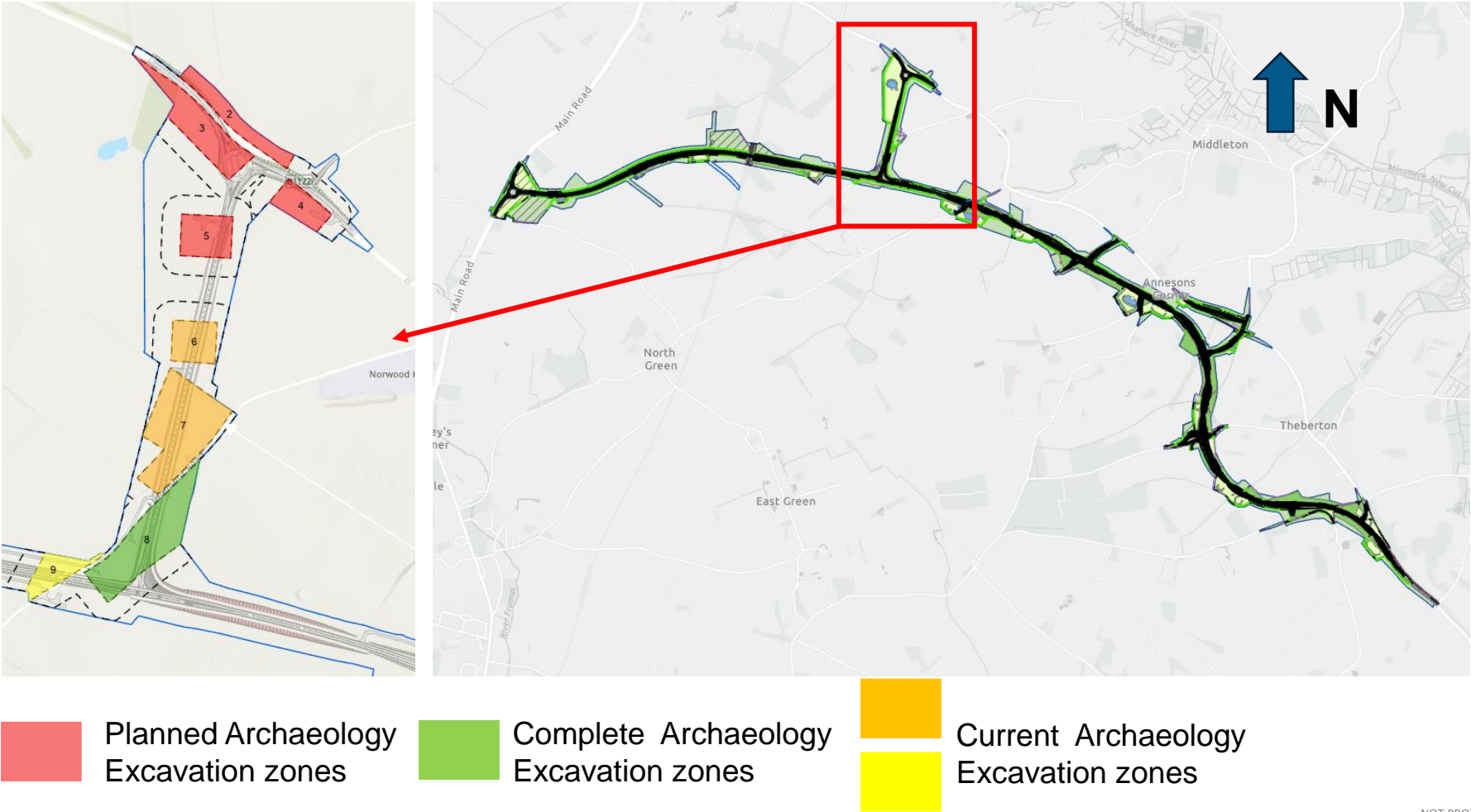

Sizewell Link Road Q1+Q2 2025

Pre-Construction Activities at Sizewell Link Road

Trust Farm: • Vegetation Management • Archaeology Mitigation • Site Security & Fencing - Main Works Commence Q2 2025

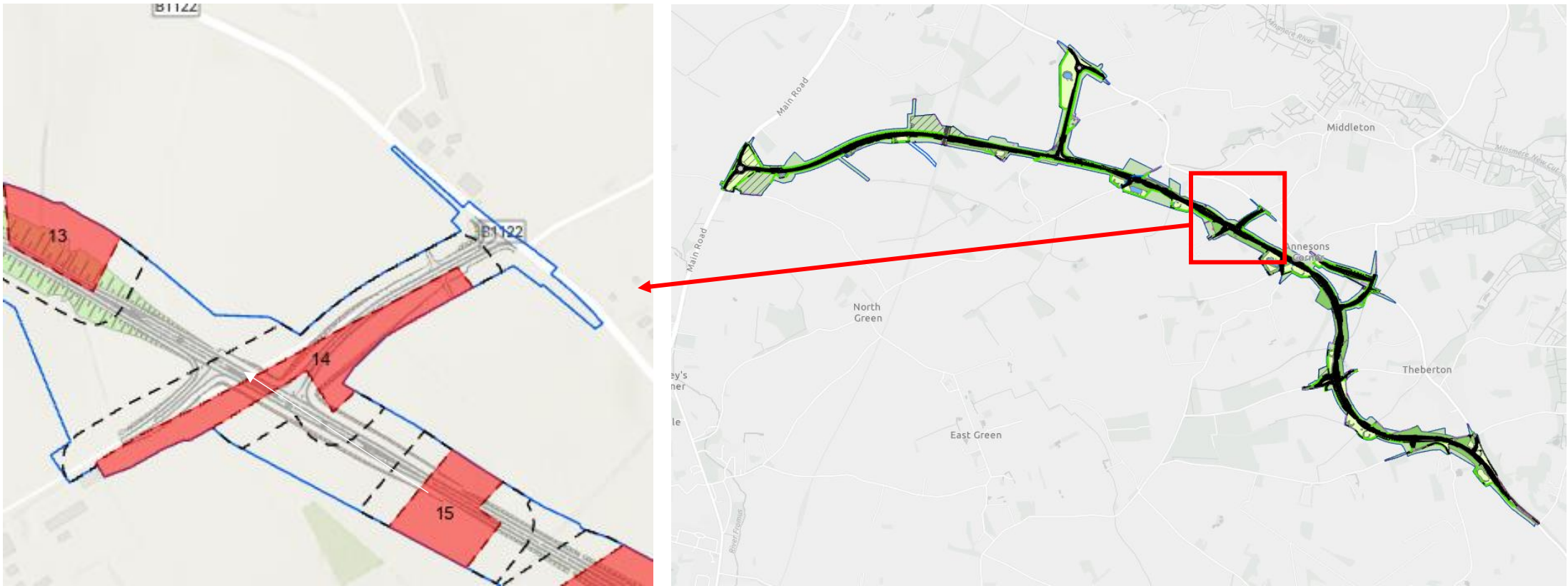

 Archaeology
Excavation zones

Sizewell Link Road - Main Works phasing – commencing Q2 2025

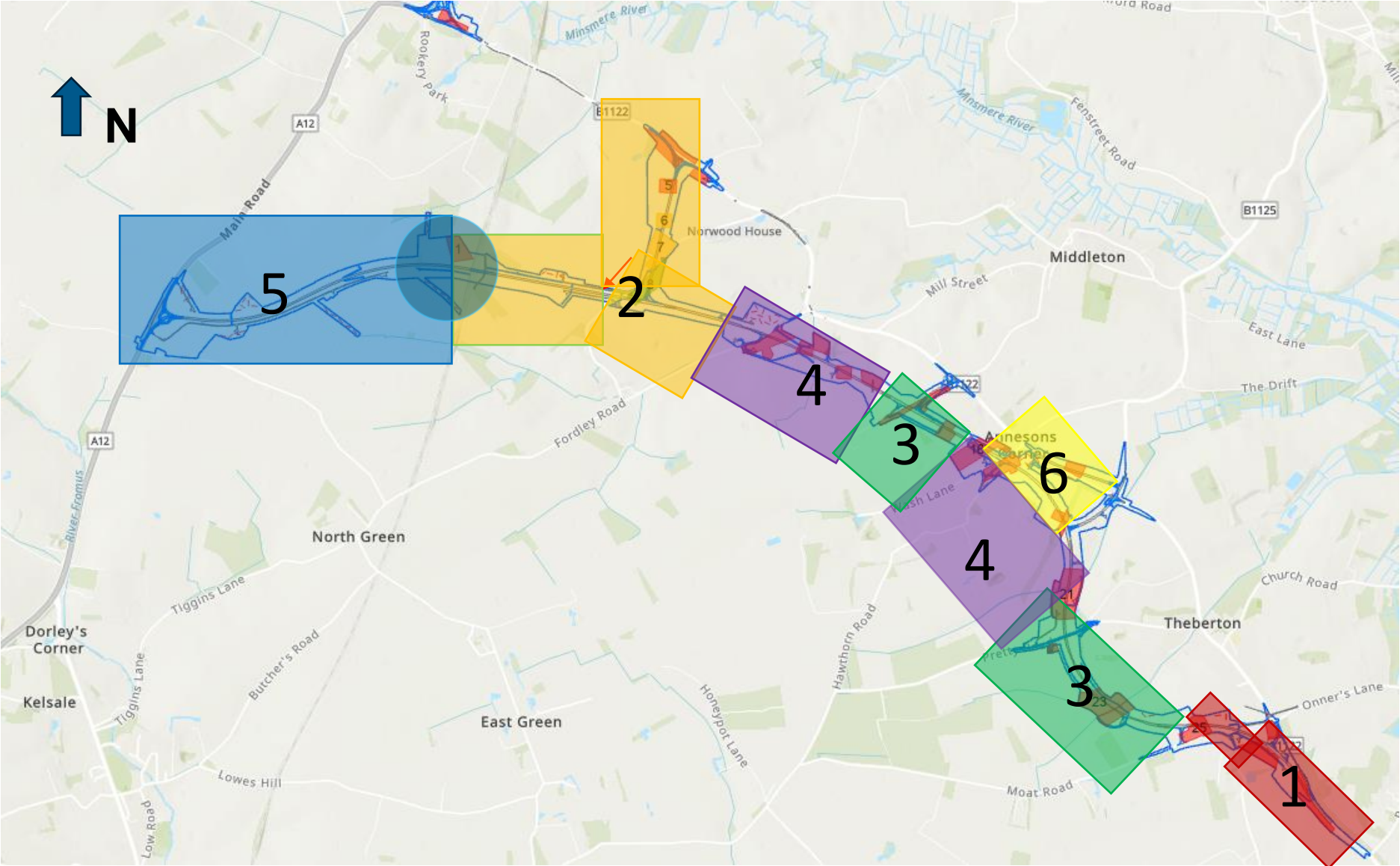

Main Development Site Roads Early Works Q1 + Q2 2025





- Key Road
- Green accesses – in place
- Red accesses – to be constructed
- Vegetation – indicative locations of clearance to be completed ahead of works in-line with ecological windows and seasonality.

Lover's Lane Utilities Diversion (Night Works)

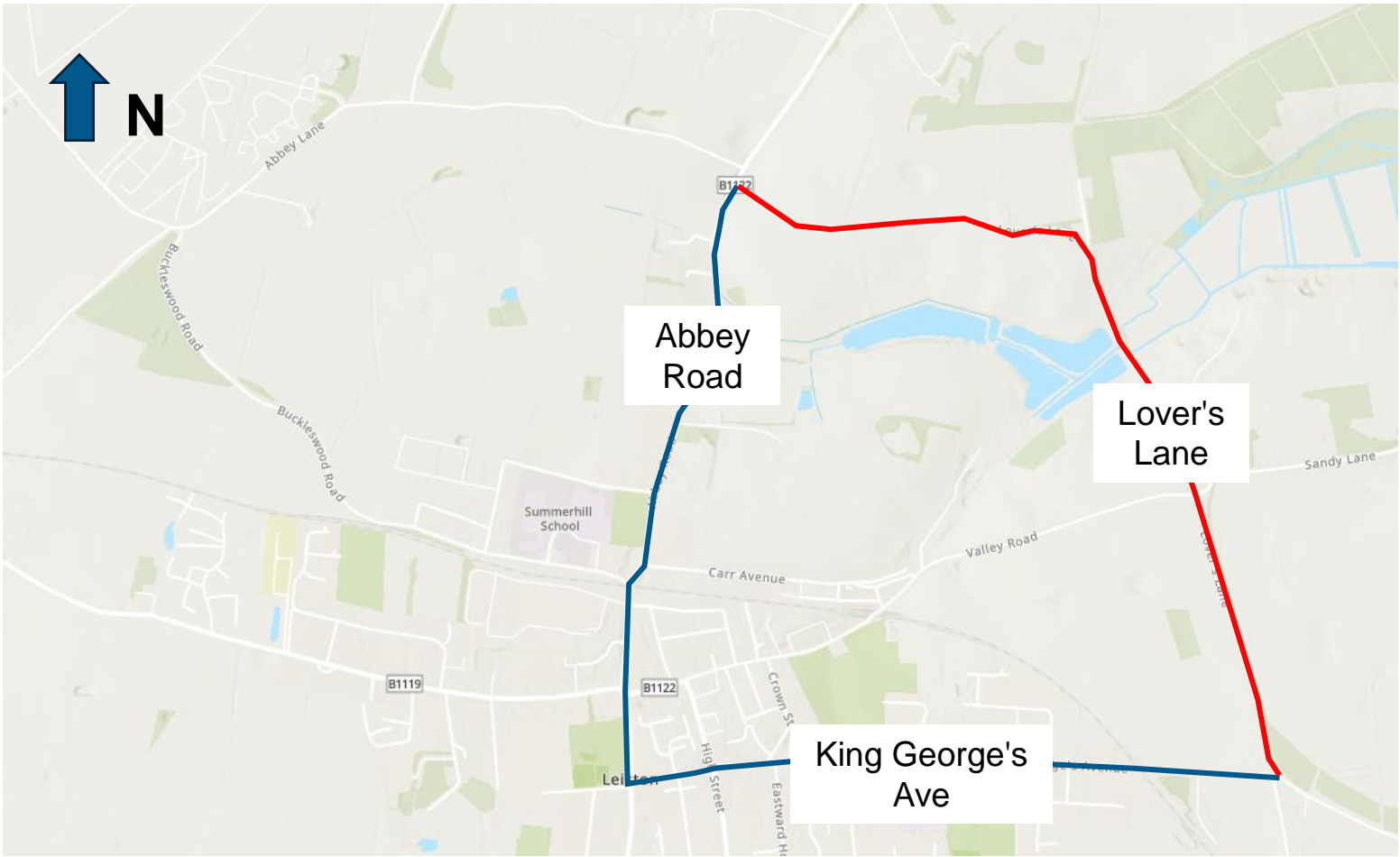
Enables Essex and Suffolk Water Diversion as well as UKPN and Openreach



Legend:

- Road Closure 
- Diversion 



6 January – 28 February
Night-time closure
Monday - Friday
20:00 - 05:00
Day-time traffic signals

Lover's Lane Utilities (Day and/or Night) - Q1 + Q2 2025

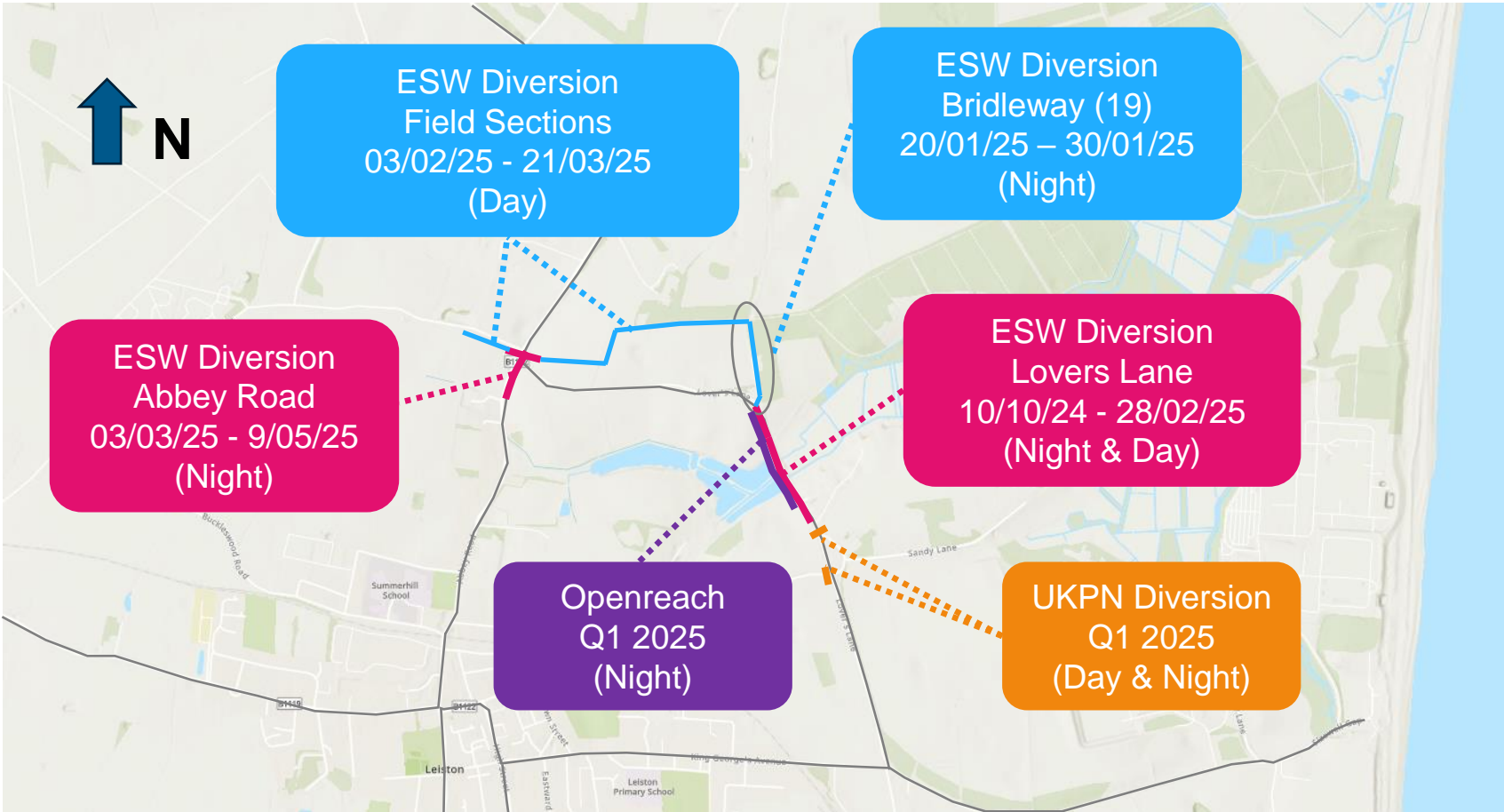

- Key Road
- Water main diversion off highway (private land)
- Water diversion in highway.



- Electricity diversion in highway

openreach

- Telecoms diversion in highway

Note: ESW Highway works need to be completed; then UKPN and Openreach can programme road space.

Abbey Road Non-Sizewell C Utilities Works (Day Works)

CityFibre Telecoms works which have been agreed by Suffolk County Council

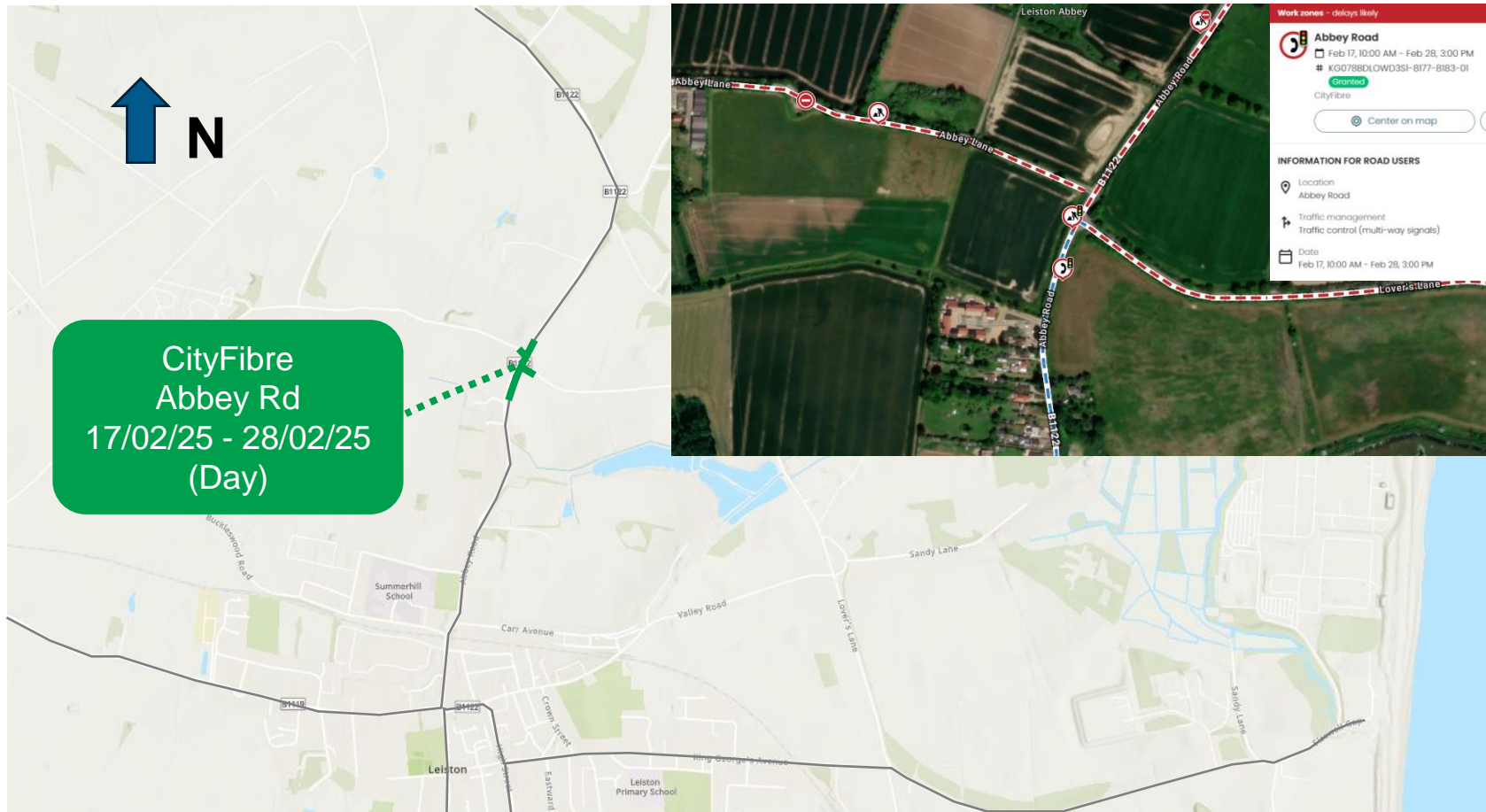

Key Road



Telecoms Delivery in highway

17 –28 February
Day Works 10:00 - 15:00

Day-time traffic signals

Item 5 29

Note: CityFibre works are **not being delivered** as part of Sizewell C project

Abbey Lane Green Rail Route (Road Closure)

To enable Green Rail Route and Main Development Site Roads Construction

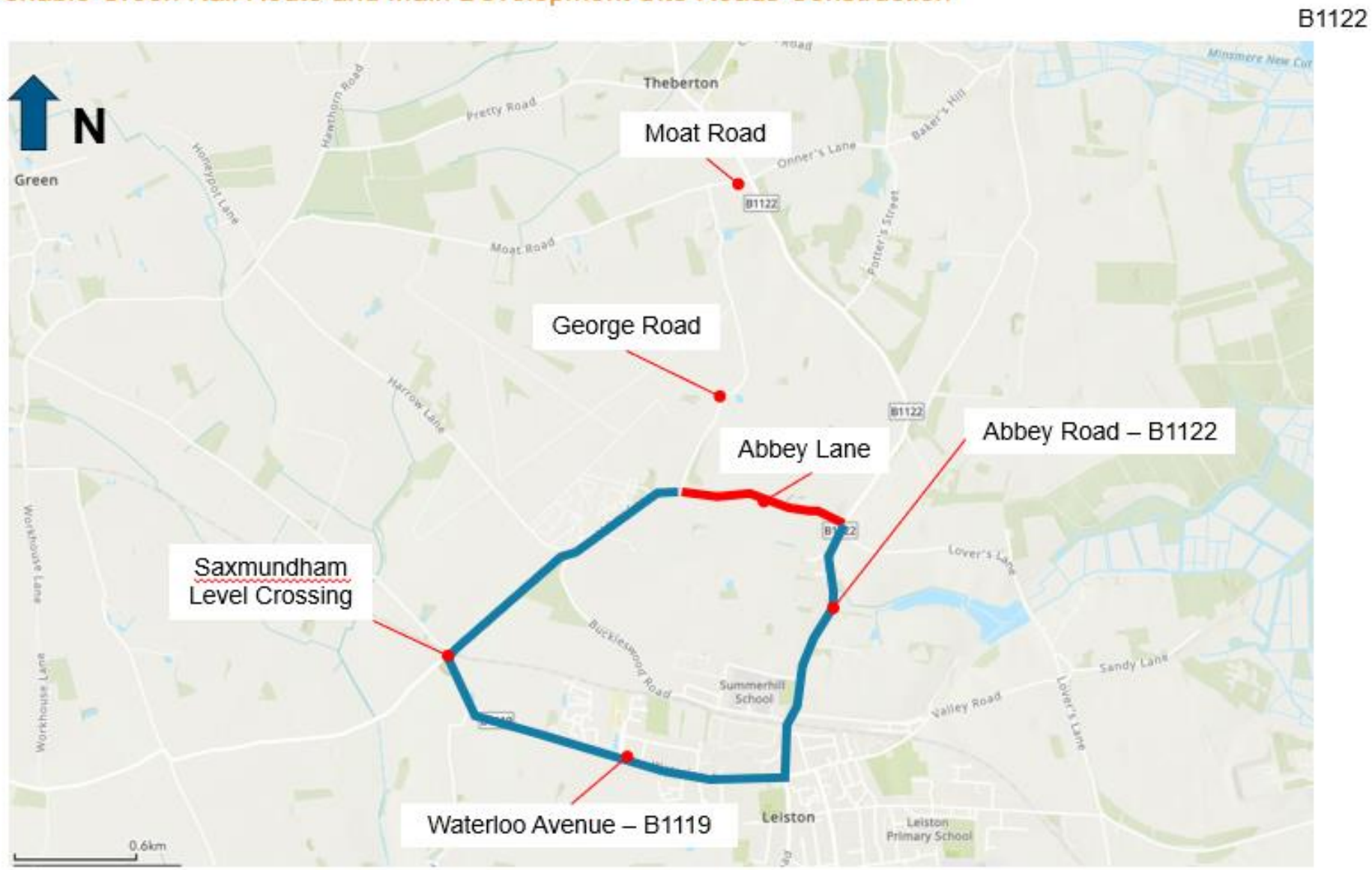

Legend:

Road Closure —

Diversion —

Full road closure from
27th January 2025 to
13th January 2027 for
construction of the Green
Rail route

Abbey Road – B1122 Utilities Diversion (Night Works)

To enable Essex and Suffolk Water diversionary works

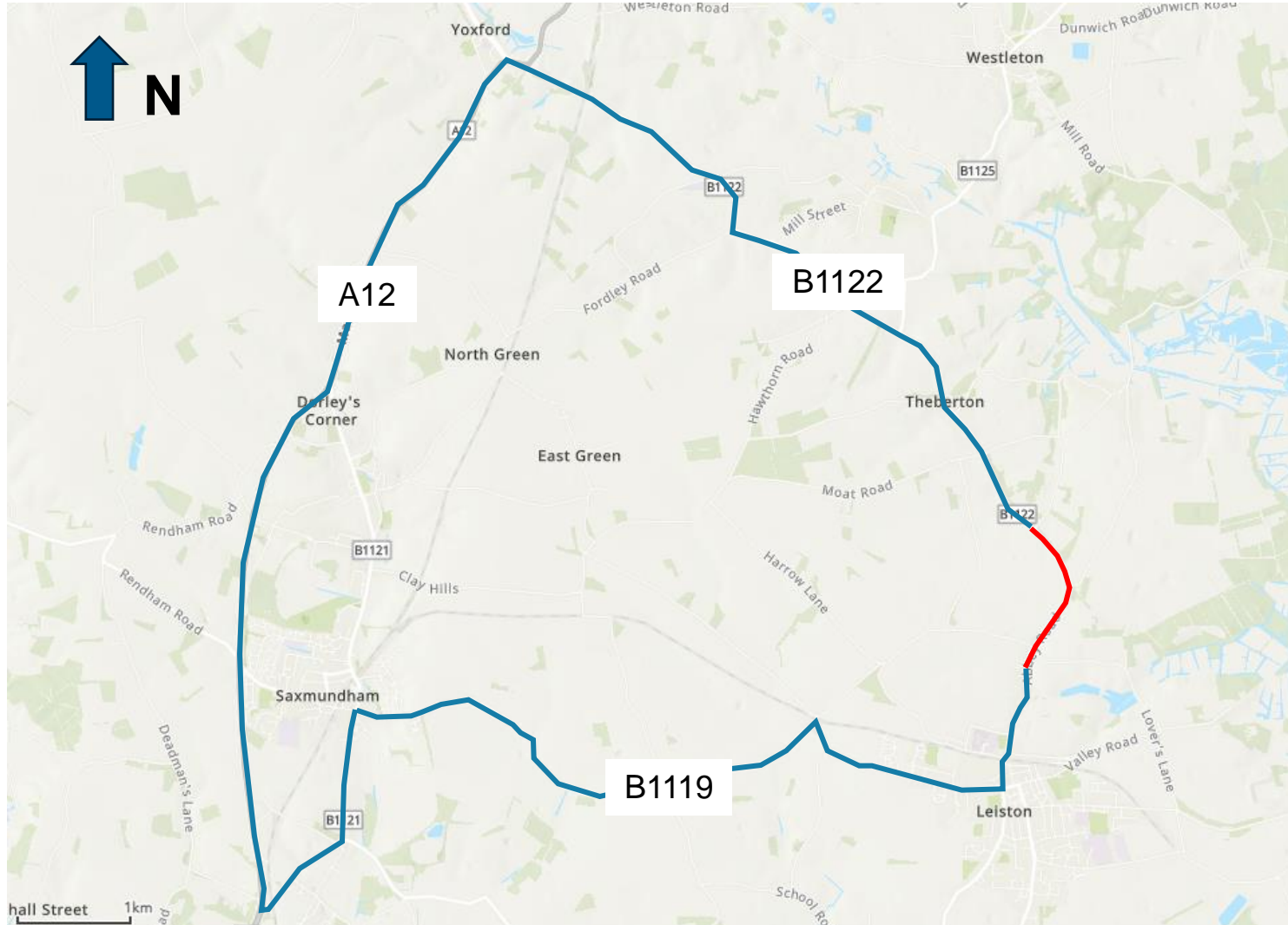

Legend:

Road Closure



Diversion



ESSEX&SUFFOLK
WATER *living water*

3 March – 9 May 2025

Night-time Closure

Monday - Friday

20:00 - 05:00

Eastbridge Road Utilities Diversion (Night Works)

To enable UKPN undergrounding of Overhead HV cabling

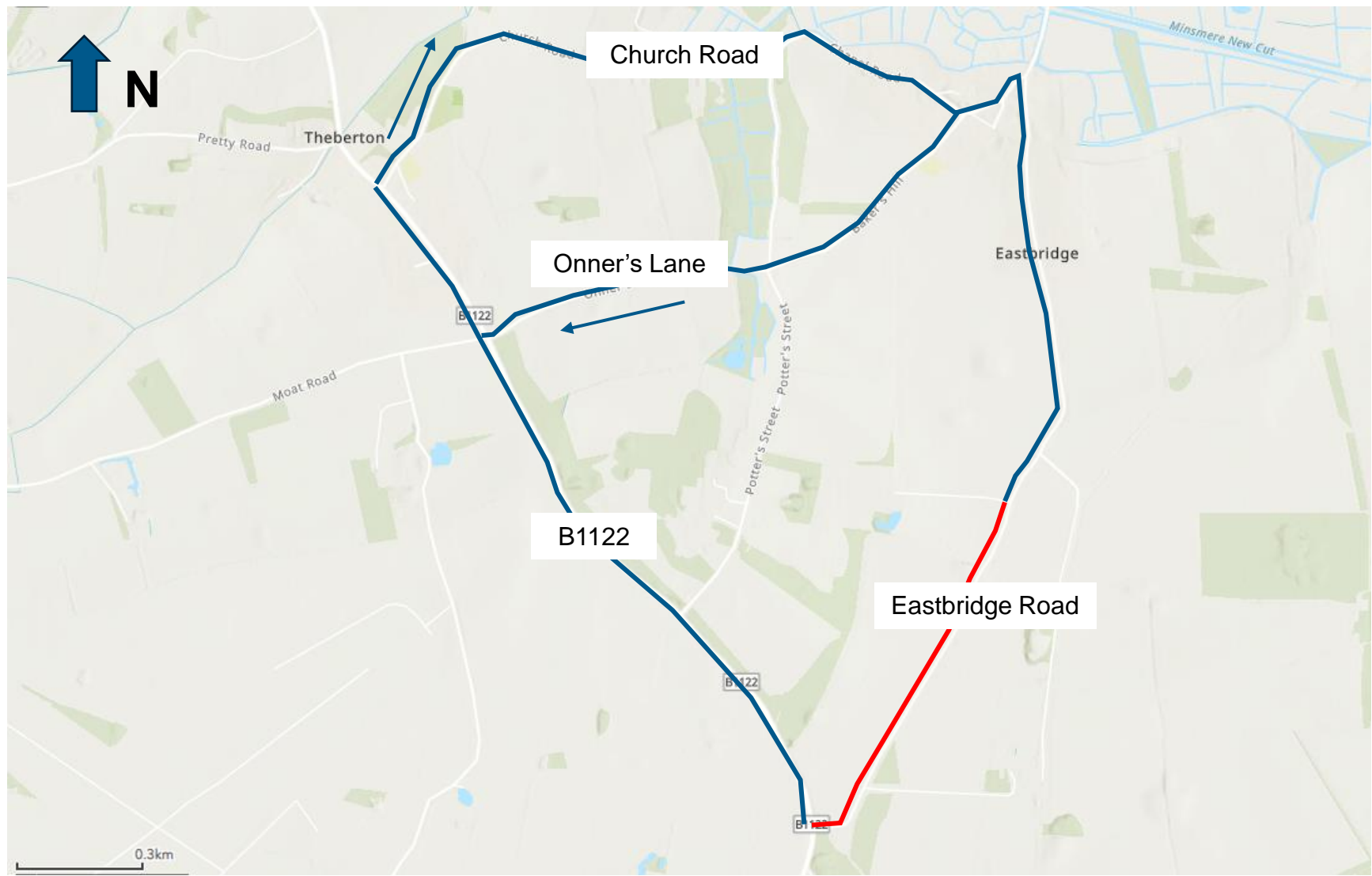

Legend:

- Road Closure
- Diversion



Night-time closure
20:00 - 05:00
UKPN Power diversion

UKPN are expected to undertake the works 17 February to 14 March 2025

Eastbridge Road Utilities Diversion (Proposed Design)

Current UKPN Delivery Design

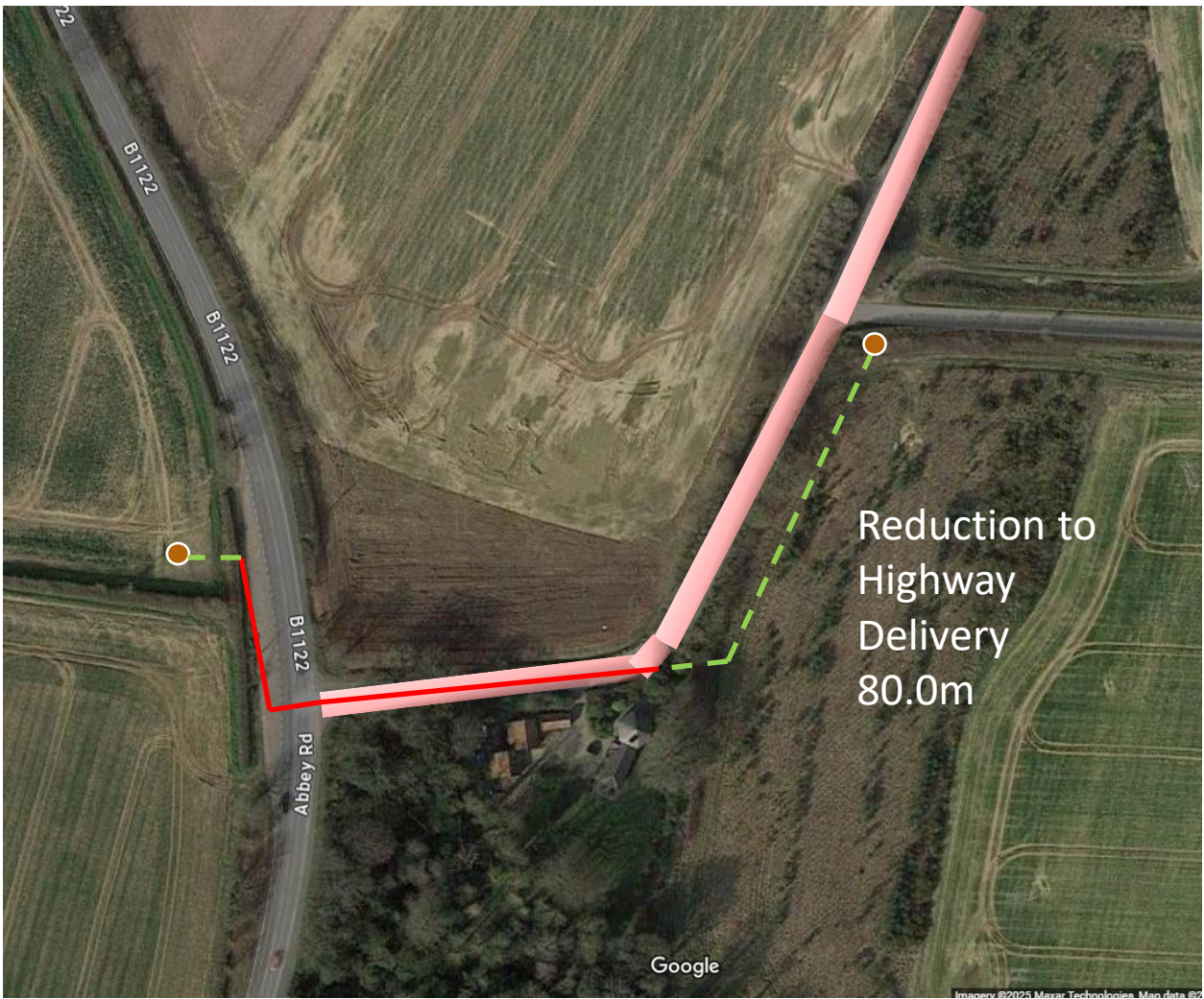

Legend:

Highway Delivery 

Soft Delivery 

Road Closure 



Orwell Logistics Park - Freight Management Facility Q1+Q2 2025



Hydrogen Buses



Single Deck Lower Floor Bus – 45 Seats

Seats Double Deck Bus – 66 Seats



Passenger Service Routes

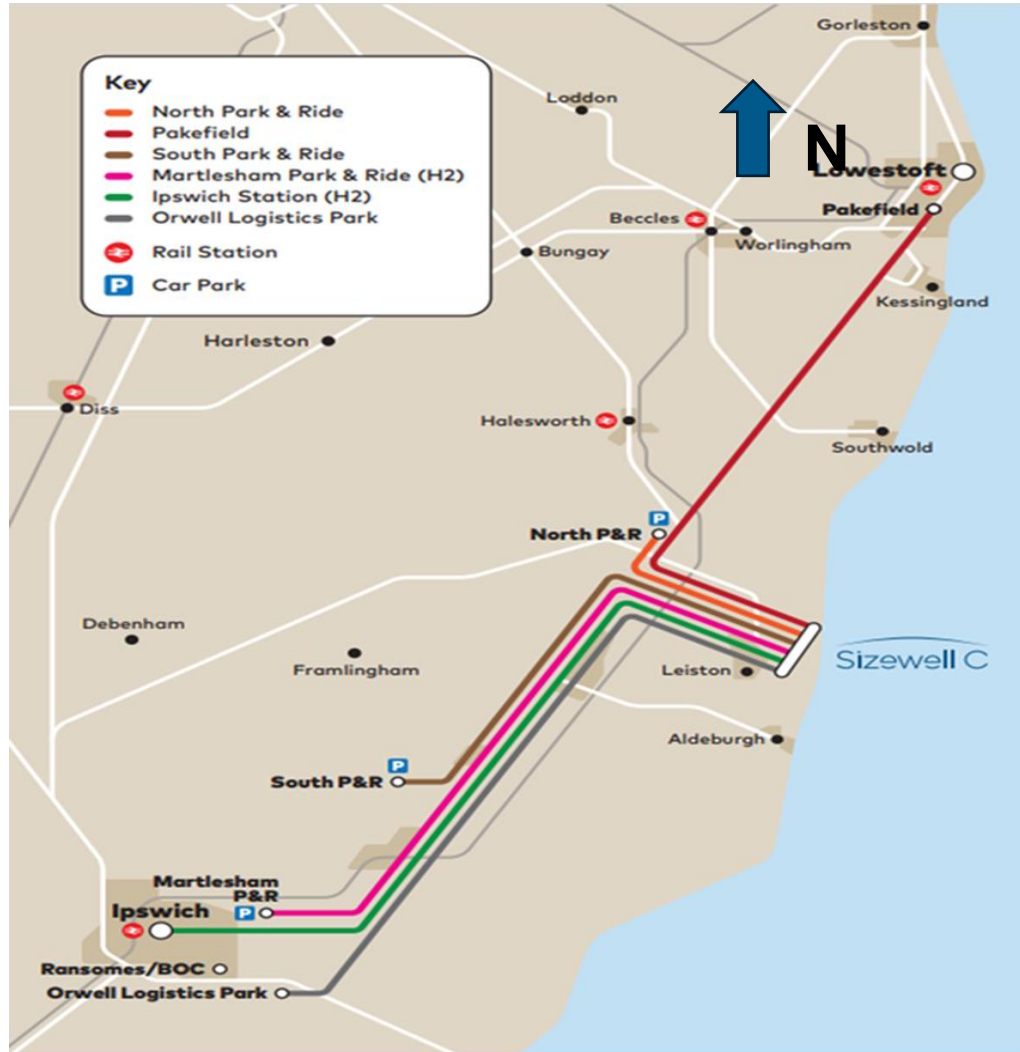

Passenger Services from

- Martlesham P&R
- Pakefield
- Orwell Logistics Park
- Ipswich Train Station
- Northern park and ride (Darsham)
- Southern park and ride (Wickham Market)
- Development of others is dependant on workforce location

Rail Delivery – Branchline Rail Drops (January 2025)

- 3 trains
- Total of 14km of rail dropped
- Enough for branchline upgrade



Rail Delivery – Branchline Enabling Works (January 2025)



Rail Delivery – Plan on a Page

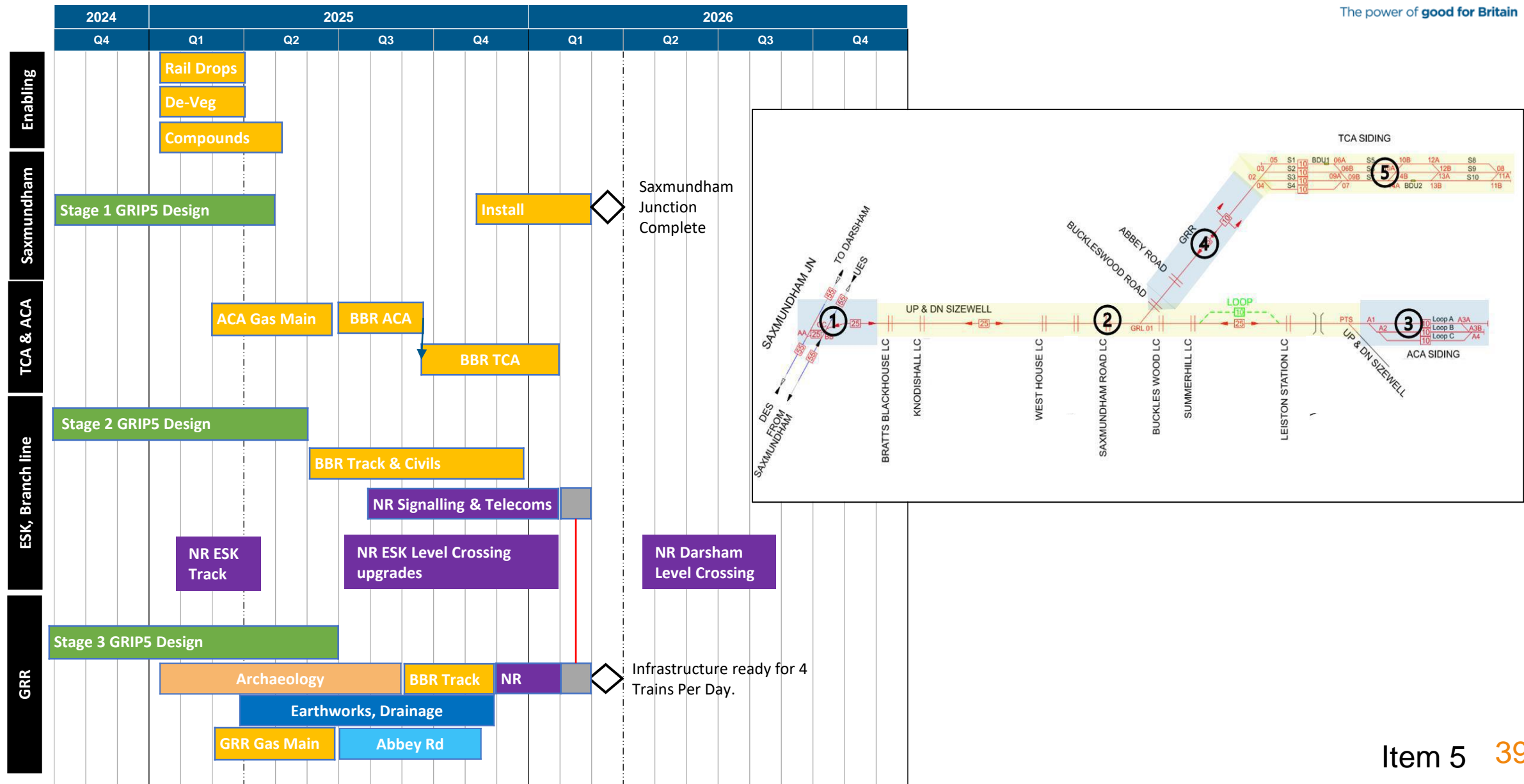

Rail Delivery – Branchline / GRR Level Crossings

Level Crossing	Type	Phase	Start	Finish
Leiston Station	Road	1	Aug 25	Oct 25
West House	Track	2	Oct 25	Oct 25
Summerhill	F/P	2	Oct 25	Oct 25
Knodishall	Road	3	Nov 25	Nov 25
Hodgson Ave	F/P	3	Nov 25	Nov 25
Saxmundham Rd	Road	4	Nov 25	Dec 25
Bratts Black House	Road	4	Nov 25	Dec 25

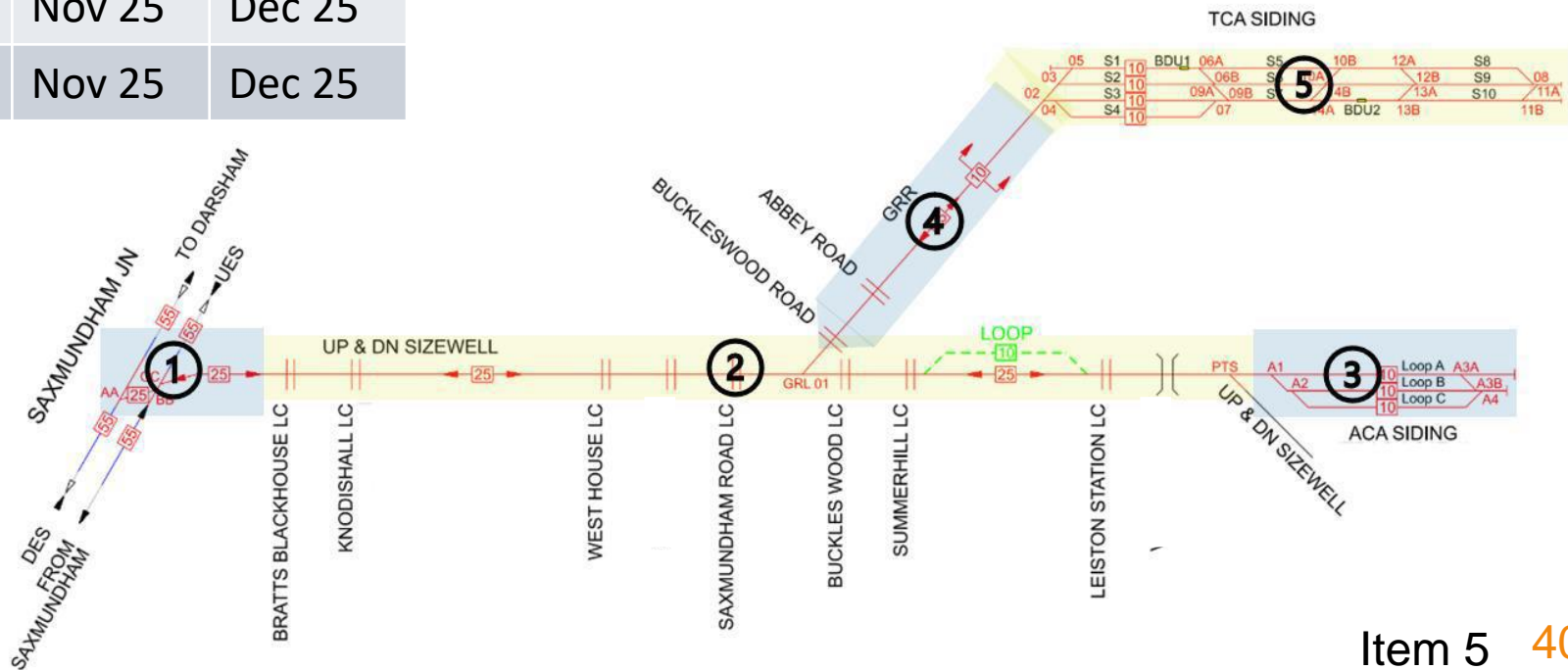

Item 6: Specialist update Landscaping and Ecology

Dr Stephen Mannings and Luke Stevens

Main Development Site

EDF Sizewell Estate Vision

[The vision for the Estate is to establish] the Suffolk Coast and Heaths AONB landscape in microcosm by creating a mosaic of some of its most valued landscapes such as extensive Suffolk Sandlings grasslands, areas of farmland, large scale forestry, coastal dunes and shingle ridges and the open sea... (DAS, paragraph 8.2.3).

Advanced Works

Habitat creation and screening



Advanced planting



Wild Studio



Wild Aldhurst



Marsh Harrier

Lovers Lane

- Tree and hedgerow removal unavoidable due to road/junction realignment
- Vegetation removal in accordance with approved site clearance plans
- Hedgerow planting to replicate the existing character of the road
- Detailed design/landscape scheme subject to technical approval/discharge of DCO Requirement 9. Planting in 2026/27 season

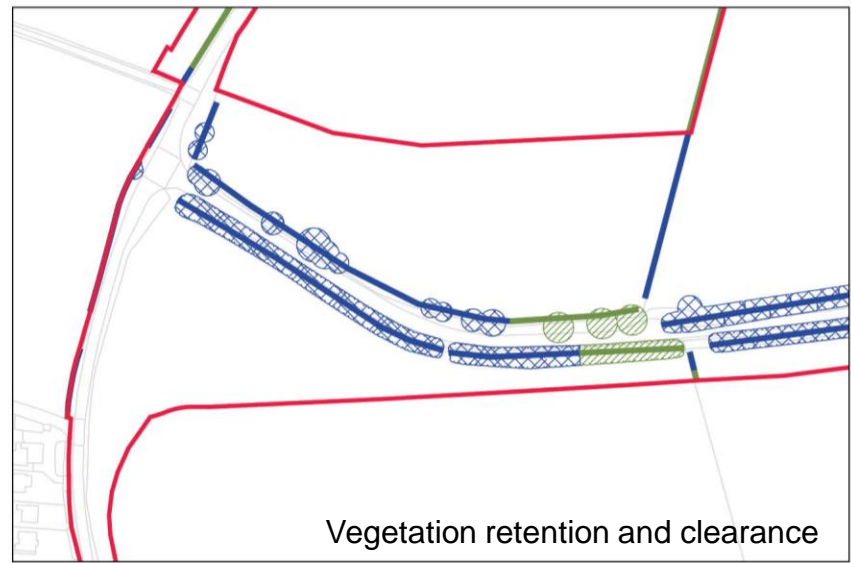

Off Site Infrastructure

Yoxford Roundabout

- Some tree and hedgerow removal unavoidable due to junction realignment.
- Retain existing woodland strip along boundary with Satis House
- Landscape design includes replacement hedgerow planting along the new road
- Incorporates sandlings mosaic in microcosm
- Design protects and enhances habitat for rare Sandy Stiltball fungus on roadside verge
- Considering further planting along eastern side

Vegetation for removal

Vegetation to be retained

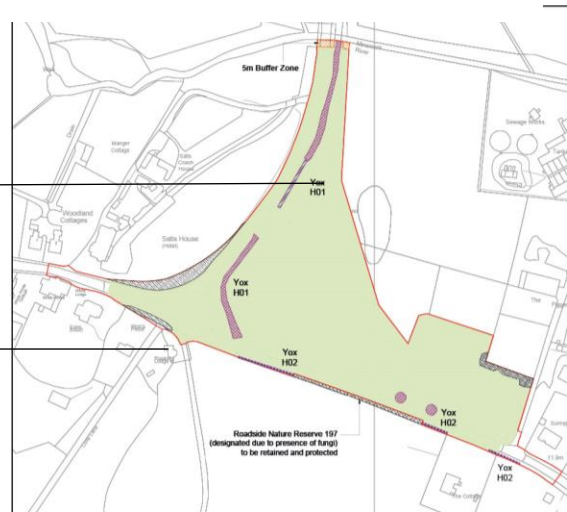

Vegetation to be retained / removed



Restoration scheme for Technical Approval

Off Site Infrastructure

Sizewell Link Road – Additional Retention

	Area – Additional Clearance (m / m2)	Area – Additional Retention (m / m2)	Net +
Hedgerow	596 m	842 m	+ 246 m
Woodland	2949 m2	3160 m2	+ 211 m2

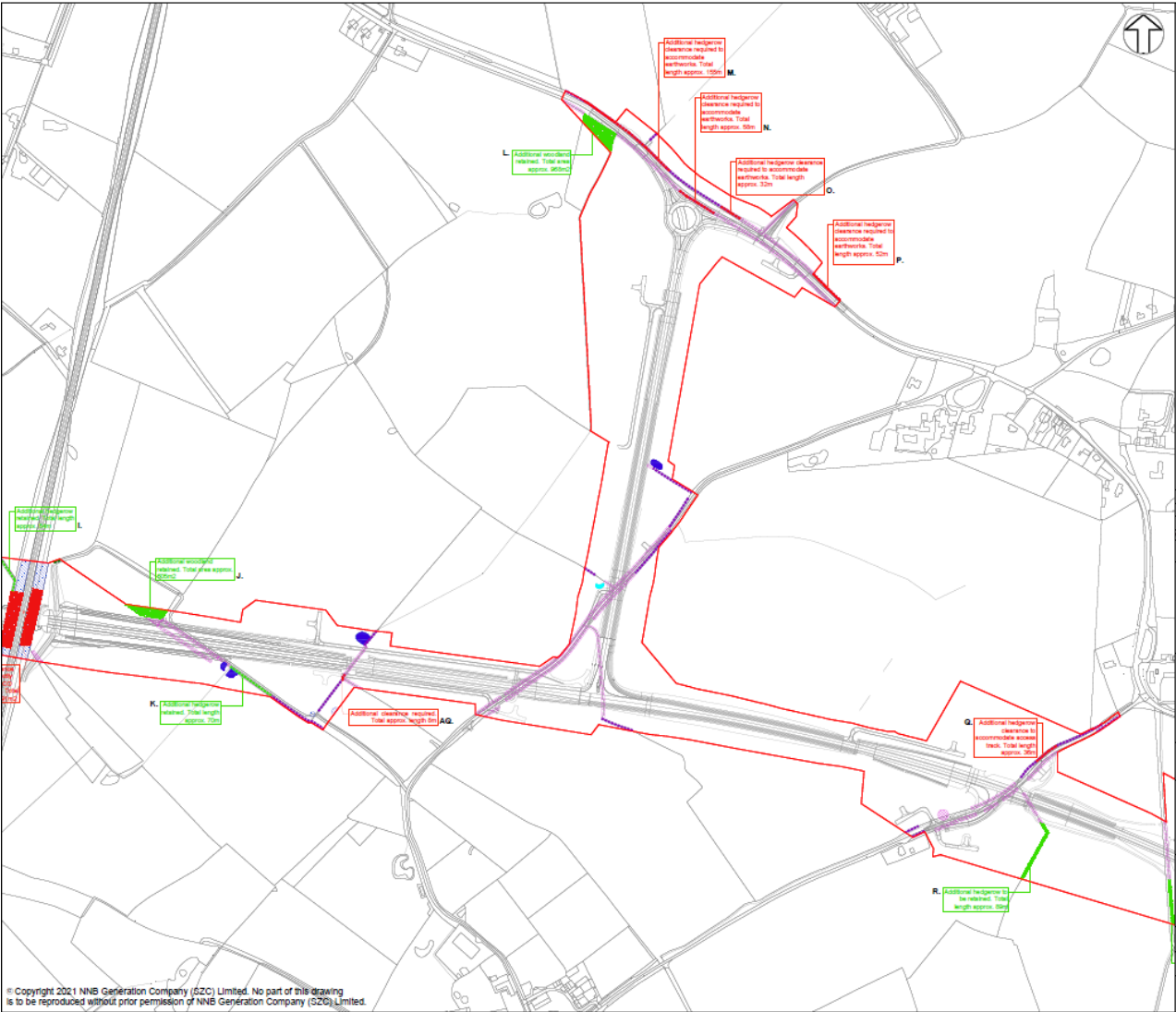

Approach to planting

- Plants of local provenance should be used where these are available
- Species mixes should replicate as far as practicable the makeup and pattern of planting typologies found within equivalent areas of the Estate and immediate hinterland.
- Species which maximise biodiversity and provide habitat for wildlife should be included within mixes (guided by local requirements and objectives – e.g. local BAP / AONB management plan etc).
- Species should be resilient to climate change impacts and disease / pests as far as is practicable and foreseeable.
- Smaller tree sizes (at initial planting) will typically be used in favour of mature stock as they are likely to establish more quickly and have a lower demand on irrigation.



Item 7: Traffic and Transport

Rebecca Quigg, Transport Coordinator

Steve Merry, Suffolk County Council Highways

Transport Monitoring Reporting Q4 2024

Average (Mean) and Maximum Daily HGV Movements

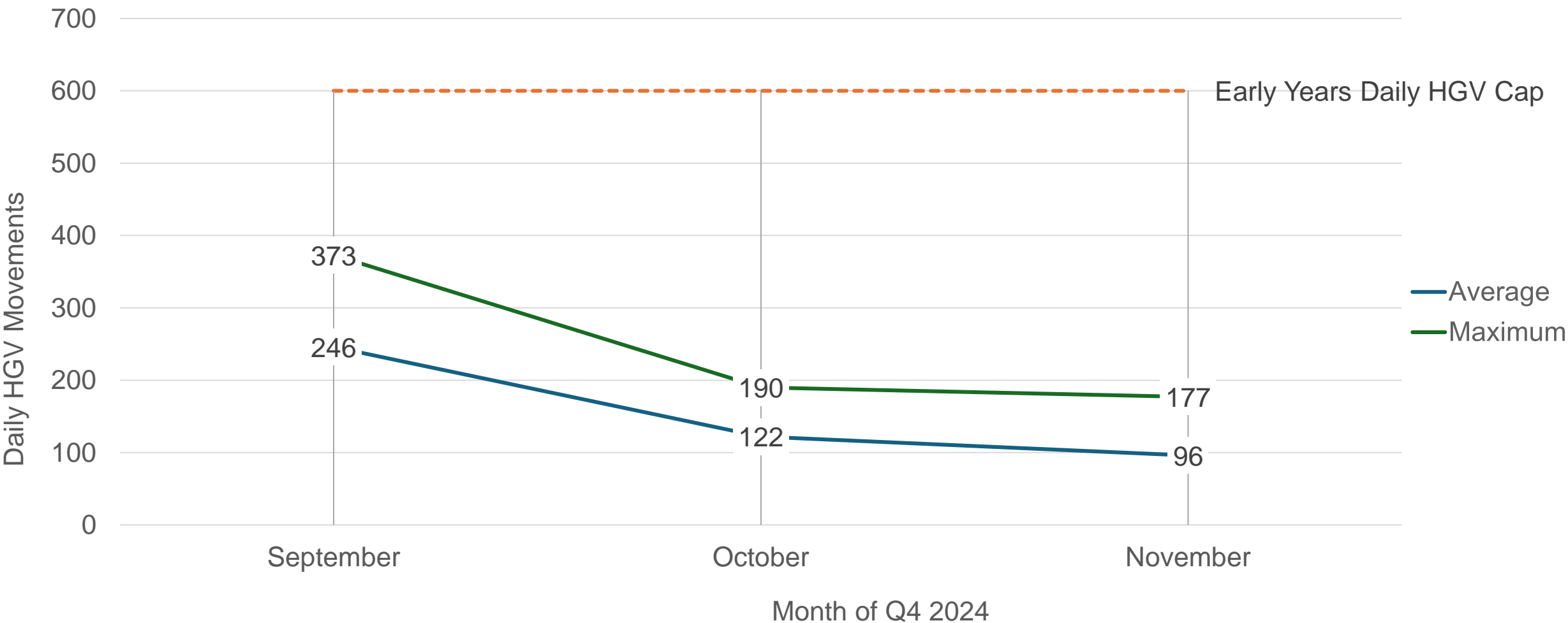

Transport Monitoring Reporting Q4 2024

Average (Mean) and Maximum LGV Movements

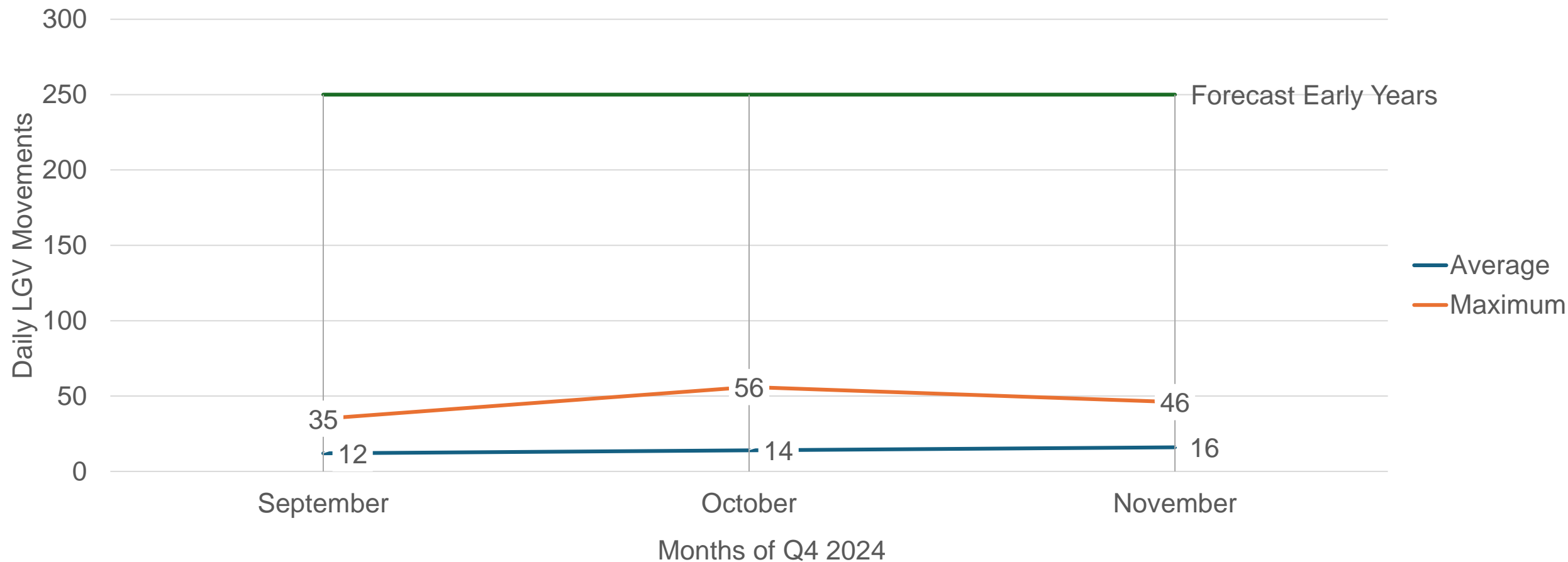

Transport Monitoring Reporting Q4 2024

Directional Split of HGV Movements

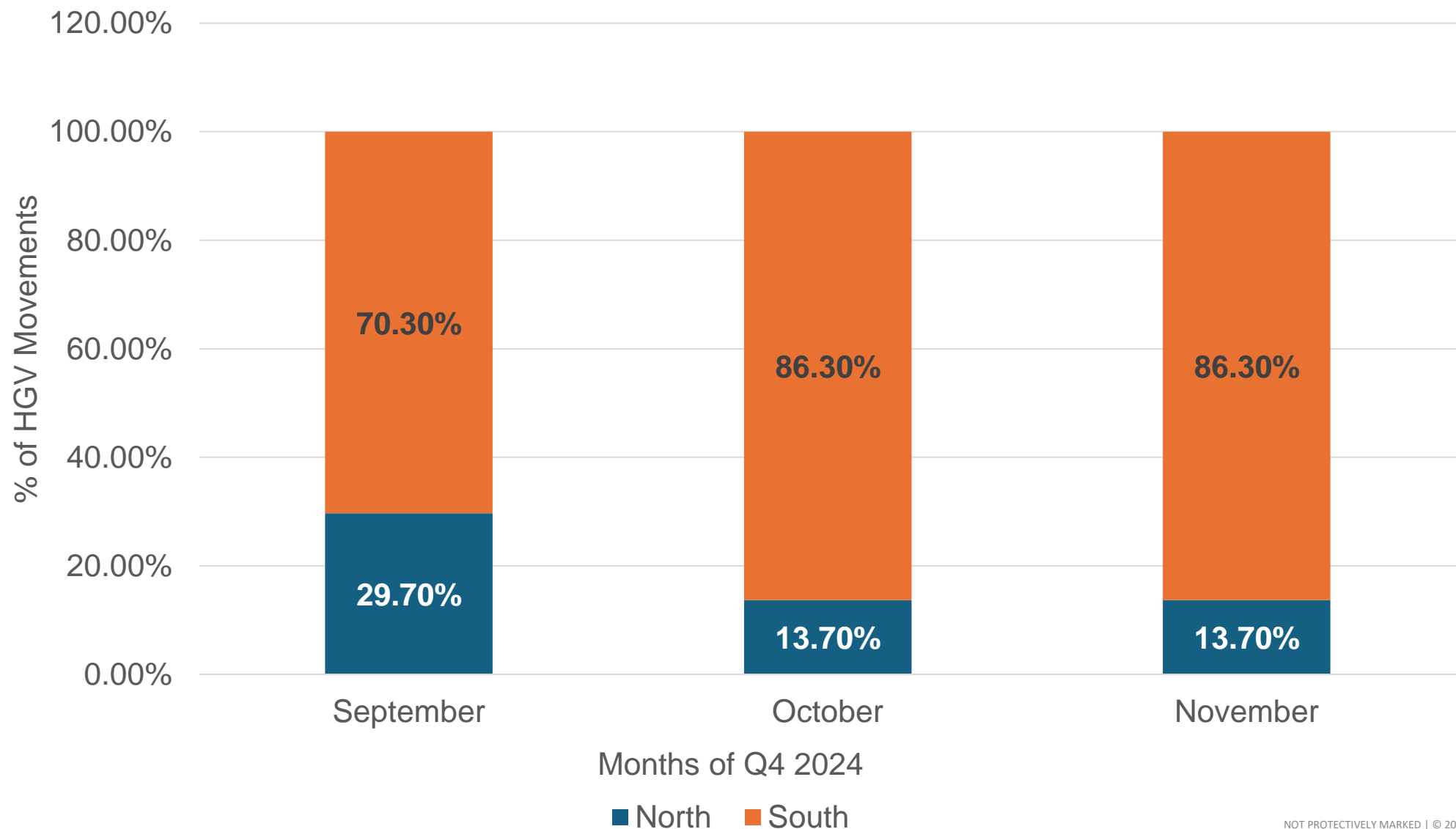

Wider Traffic Monitoring

Traffic count sites

- Traffic Monitoring Surveys are mentioned in the Deed of Obligation as a potential measure to respond to traffic issues
- In consultation with Parish Councils, traffic counts implemented proactively
- First round of monitoring completed in Oct 24, and presented to Parish Councils in December
- Report sent to ESC for upload to the website

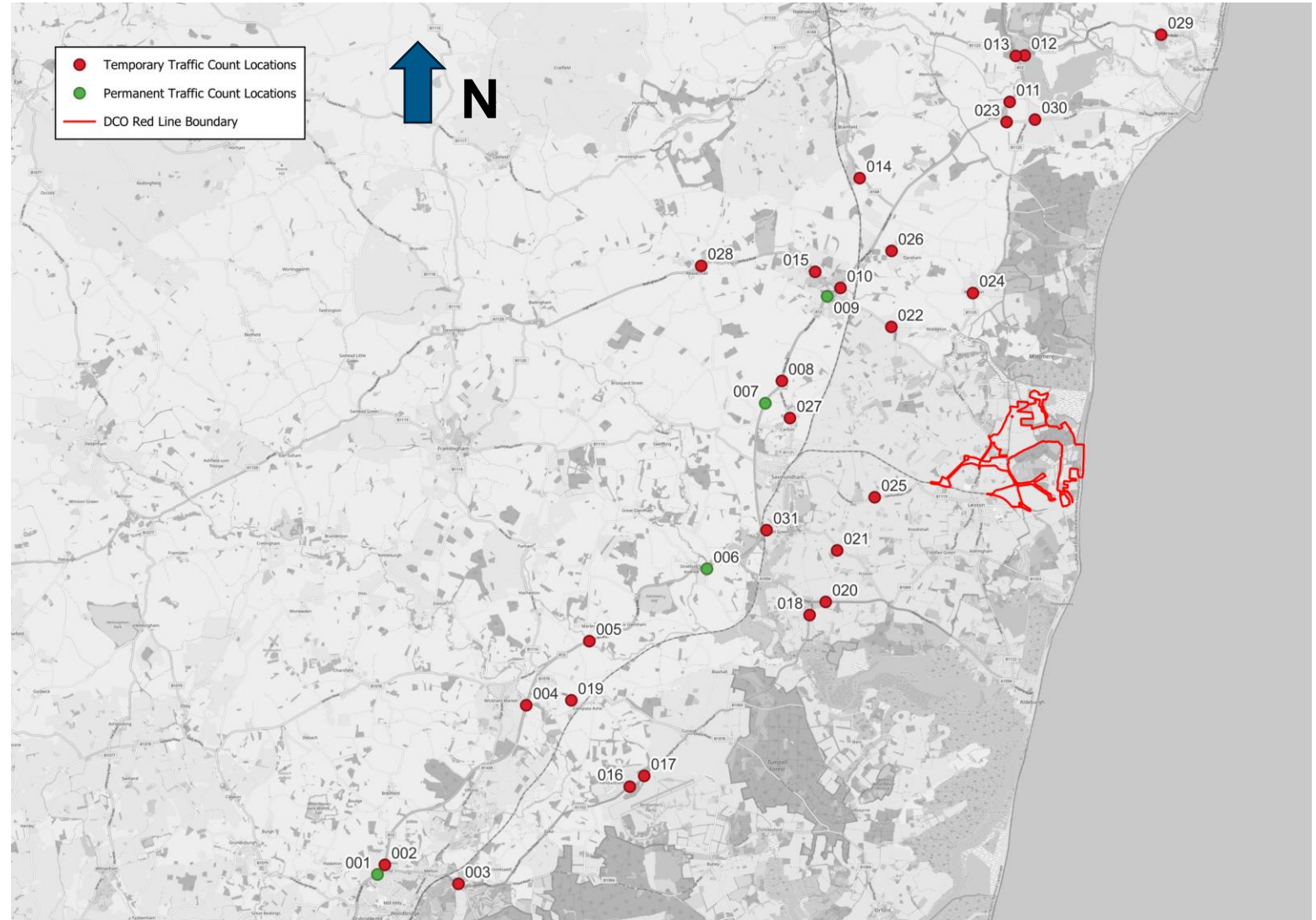

Wider Traffic Monitoring

Wickham Market

- One traffic counter on the outskirts and to the west of the village on the B1078
- Second counter on High Street between Border Cot Lane and Rackhams Bridge

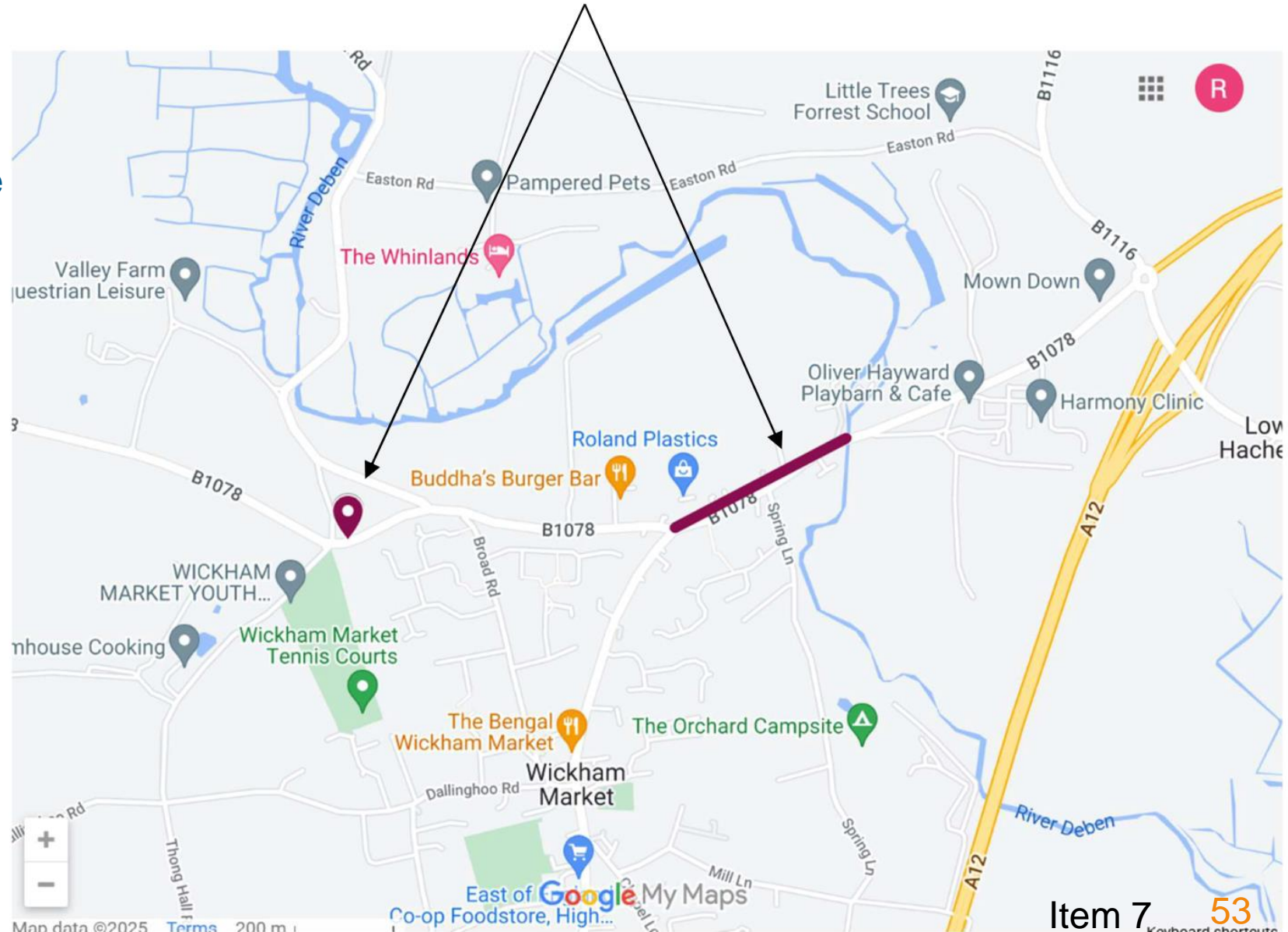

Wider Traffic Monitoring

Kelsale-cum-Carlton

- One traffic counter on Clayhills Road (location approximate)

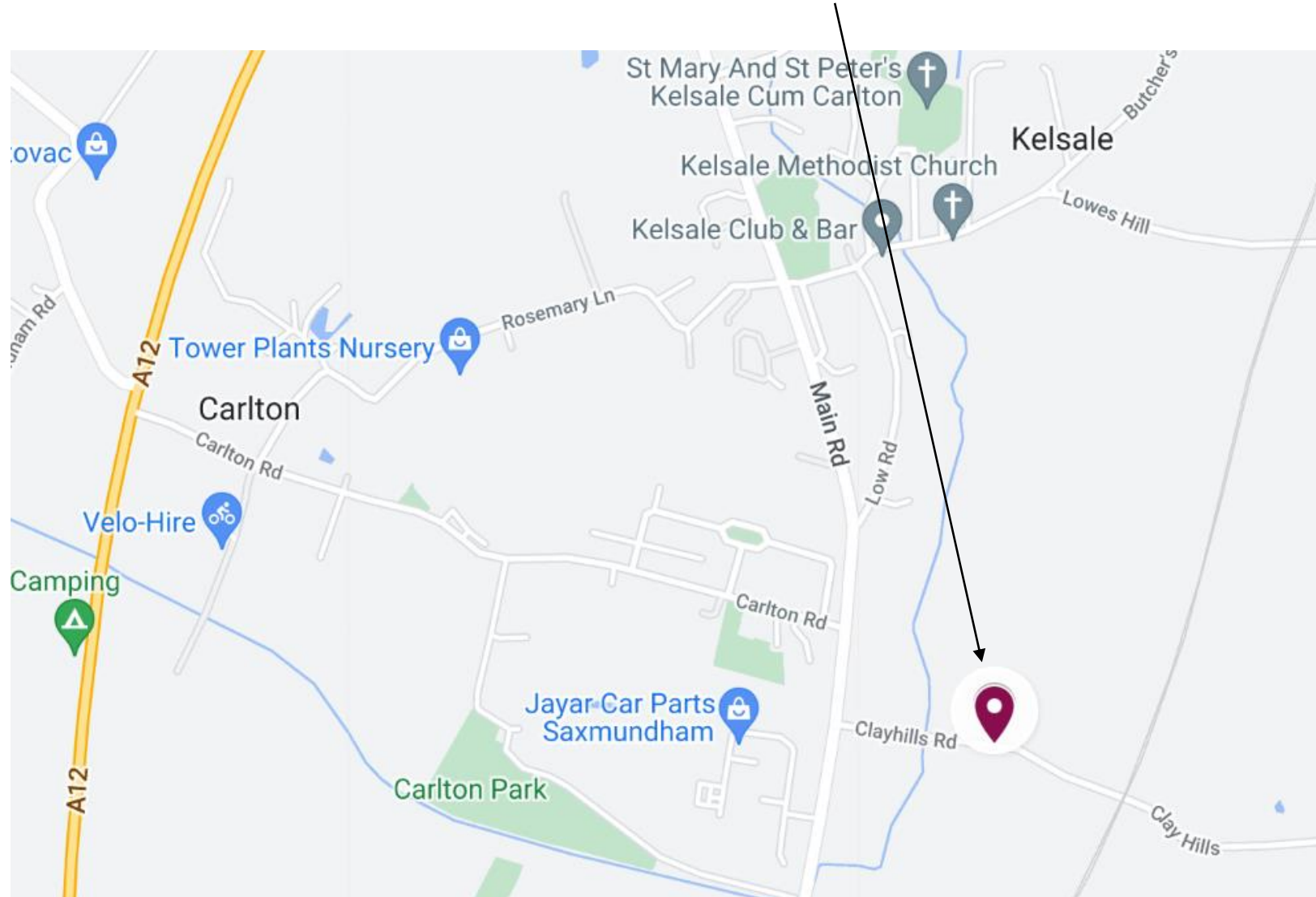

Wider Traffic Monitoring

Westleton

- Change of traffic counter location to better represent speeds through the village
- Either one counter on The Street, alongside the village green
- OR one counter on Blythburgh Road near the adventure playground
- Location to be confirmed, but alteration agreed

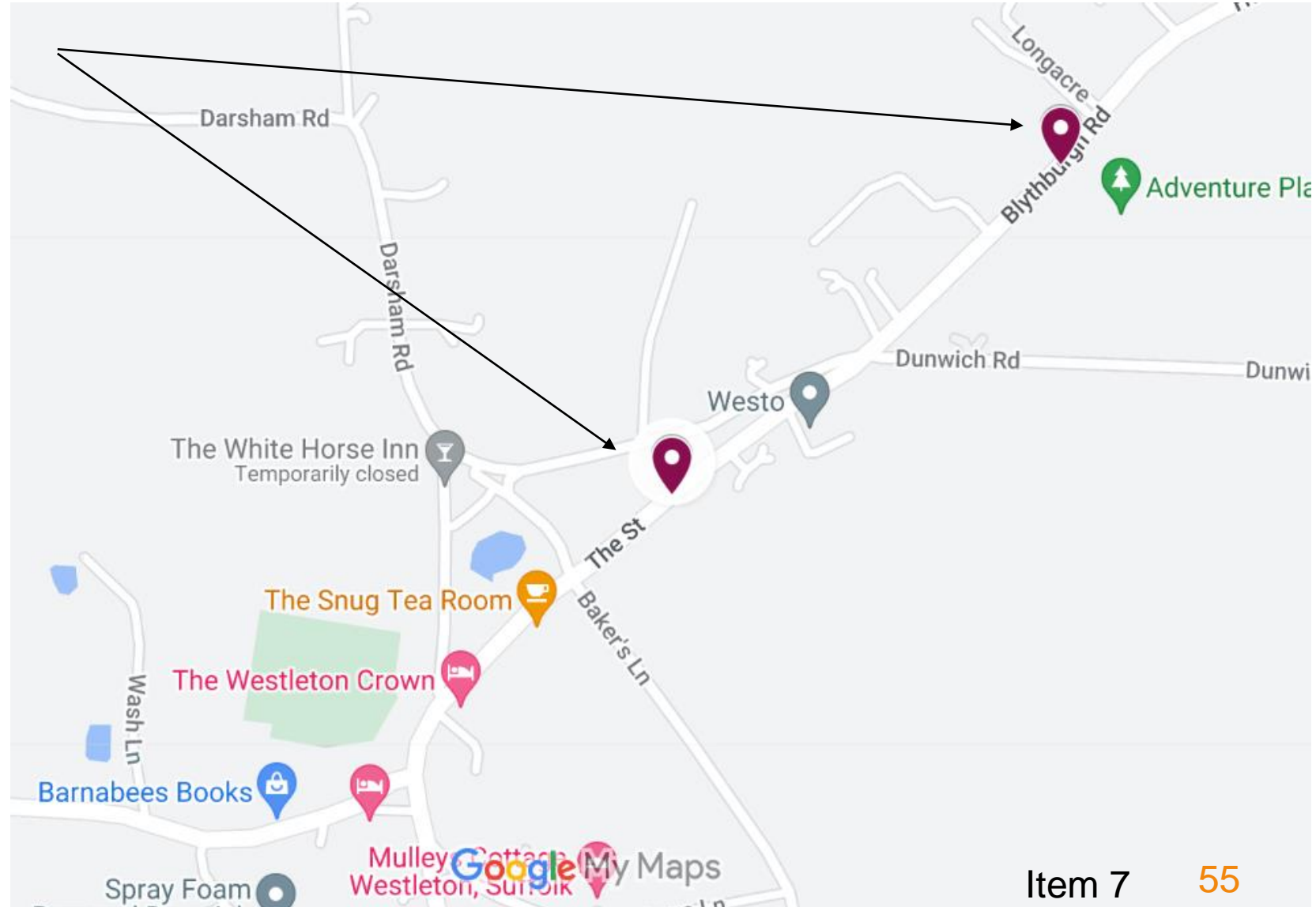

Wider Traffic Monitoring

Ufford

- One traffic counter agreed on Bridge Road
- One traffic counter being discussed further with Ufford Parish Council

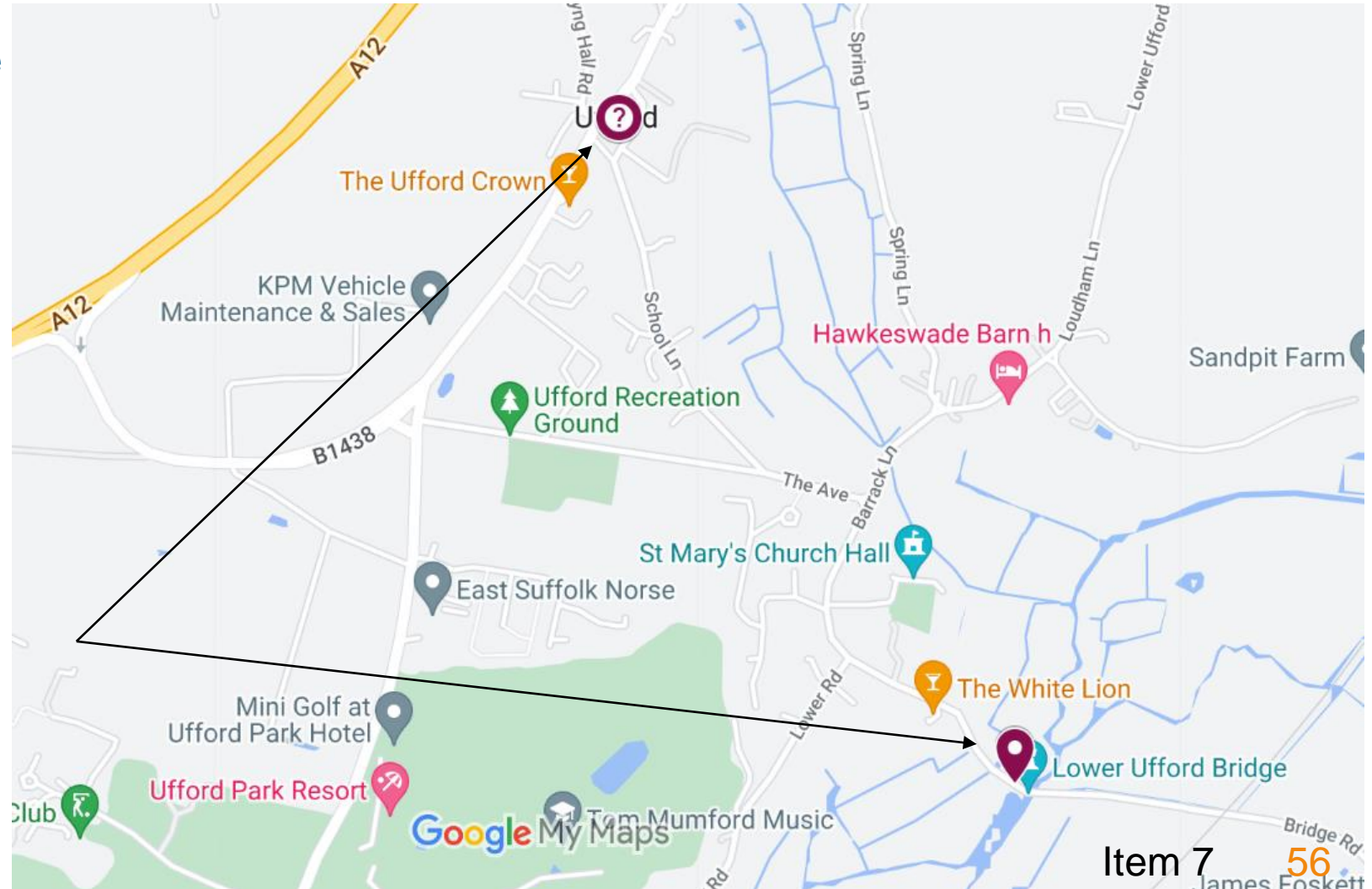

Wider Traffic Monitoring

Knodishall B1069

- One traffic counter agreed on B1069



Wider Traffic Monitoring

Leiston

- Traffic counters agreed on:
 - Abbey Road
 - Cross St (near Sylvester Road)
 - Seaward Avenue
 - Aldeburgh Road
- B1069 traffic already monitored by agreed Knodishall point

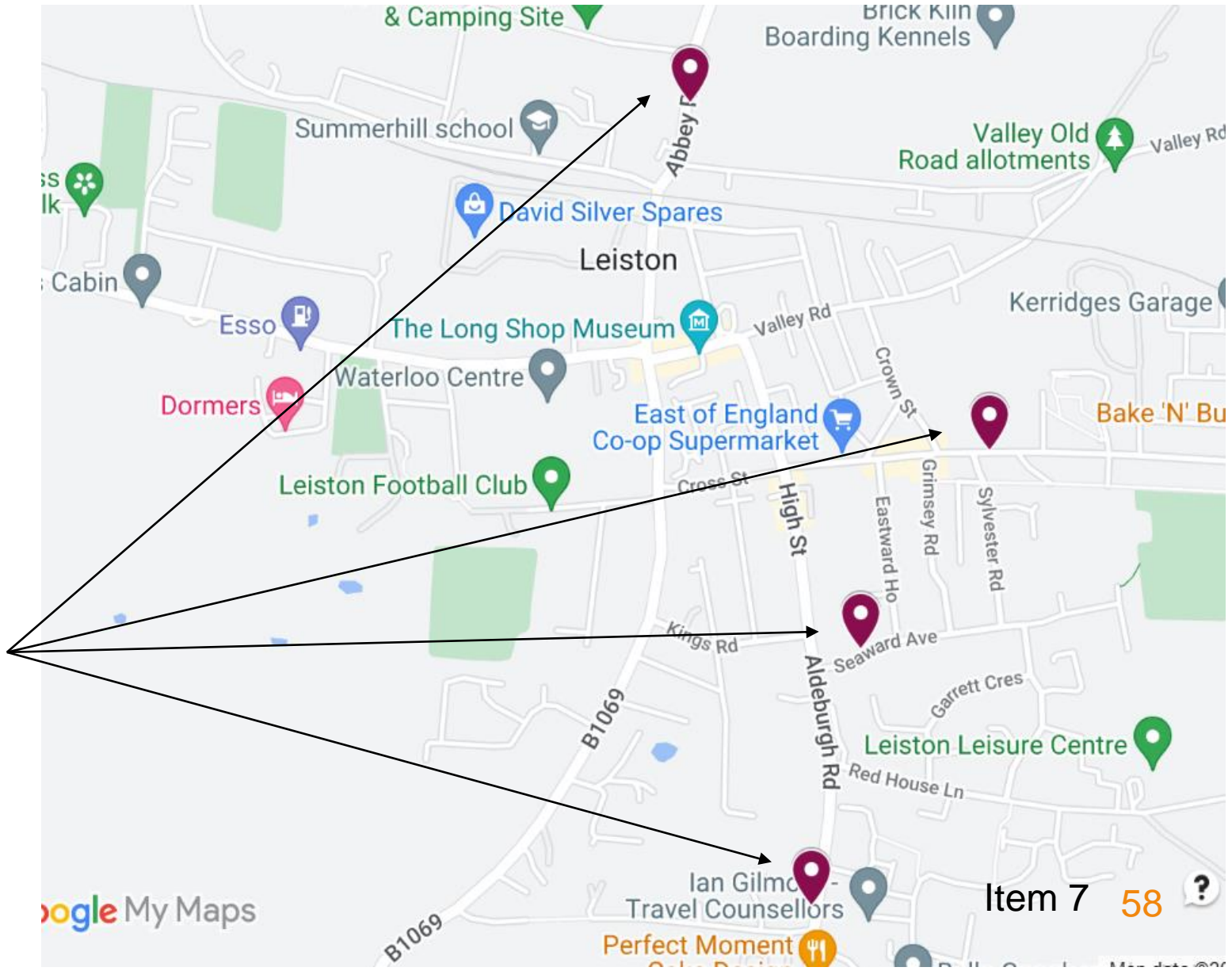

Local Roads Schemes

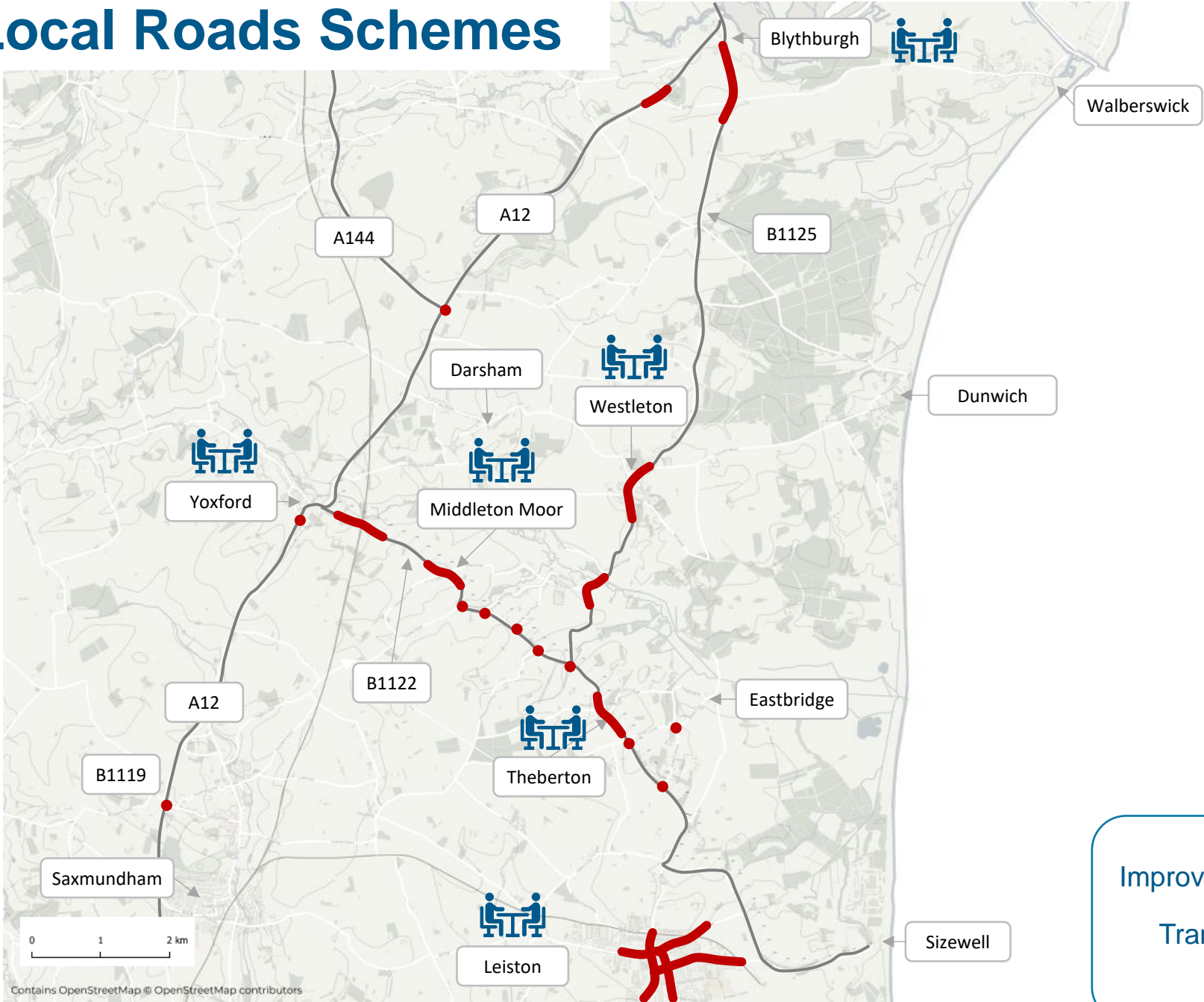

Typical improvements

- New and enhanced pedestrian footways and crossings
- New road surfacing
- Village gateways
- Safety improvements and side road visibility

Improvement scheme

Transport Working Group



Transport Working Groups

Update on Transport Working Groups



Working Group	Next Steps
Leiston	<ul style="list-style-type: none">• Designs with Suffolk County Council for review• Public exhibition of scheme elements Q1 2025• Next meeting: 27 February 2025
B1122	<ul style="list-style-type: none">• Meeting held on 30 January. Designs progressing• Next meeting: 22 May 2025
B1125	<ul style="list-style-type: none">• Designs progressing• Positioning of Westleton average speed camera confirmed• B1387 discussion ongoing• Next meeting: 13 February 2025
Marlesford & Little Glemham	<ul style="list-style-type: none">• Designs progressing• Next meeting: 27 March 2025
Wickham Market	<ul style="list-style-type: none">• Meeting held on 23 January. Designs progressing• Next meeting: 15 May 2025
Yoxford	<ul style="list-style-type: none">• Designs for pedestrian crossing progressing• Next meeting: 13 March 2025

Item 8: Q&A

Via Town and Parish Council Representative
Chair

Submitted by Darsham Parish Council

Q.1 . At the 7th August Northern Transport Forum Darsham Parish Council asked for a review of the speed limit along the A12 between the Park and Ride entry onto the A12 and the Street at Darsham. Can you please confirm what steps have been taken to review this point?

Q.2 With the likely increase in traffic volumes over the coming years as a direct result of the Sizewell construction works, it is inevitable that traffic will displace onto the rural road network and in particular through villages adjacent or near to the A12. Darsham Parish Council is therefore requesting that SZC give due consideration to this concern and as a deterrent support the implementation of a 20mph speed limit through Darsham Village.

Submitted by Saxmundham Town Council

Q1. Greater Anglia car park, Saxmundham Station and Network Rail contractors parking:

Balfour has its compound to the rear and now railway contractors working on the Sizewell C line upgrades are also using the station car park. This leaves scant space for rail users resulting in various implications for Saxmundham and its residents.

- The paucity of parking affects vulnerable passengers with limited mobility and people returning on late trains who fear walking in the dark to reach their cars.
- The lack of space is likely to deter passengers using Saxmundham station and reduce passengers supporting the town businesses by purchasing refreshments and newspapers prior to their journeys.
- Without available parking, drivers will resort to parking in narrow side streets, private car parks and even the Council Office car park.

Can a solution for this problem be found that works for all parties

Submitted by Yoxford Parish Council

Q1. Please explain the reasons why Willow Marsh Lane needs to be closed for two years or more, rather than the six months mentioned last term we heard about it.

Q2. What compensation will be offered to those affected by the closure?

Submitted by Blythburgh Parish Council

Q1. A question from Blythburgh PC - what attempts have been made to get Suffolk Constabulary to engage with this forum and what are they (apparently) proving unsuccessful. The reason for the question (based on the agenda for the forthcoming meeting) is that the police will be crucial to enforcement of many of the traffic mitigation measures but do not seem to want to engage with this exercise, at least at a senior leadership level.

Submitted by Theberton and Eastbridge Parish Council

Construction of the Sizewell Link Road (SLR) is scheduled to start at the end of Q2 2025 and open end of Q2 2027 based on information provided by Sizewell C.

The current plans being developed and proposed are piecemeal and have no overall strategy to ensure that residents and workers in the area will be able to travel easily cross country (not on the A12 or B1119 from the Saxmundham area towards Eastbridge, Theberton, Sizewell, Middleton or Westleton or vice versa).

- The development timeframes for the SLR overlaps with the 1-2 year proposed closure of Abbey Lane
- Presently all roads south from the B1122 between the A12, at Yoxford, and Lovers Lane are due to be closed to traffic either permanently, or in one case possibly temporarily (Pretty Road), at some point during construction

It is good that George Lane is now seen as not suitable for Abbey Lane diversions coming from Saxmundham direction but overall the extensive closures that are inevitable as a result of B1122 works and SLR construction need a carefully planned set of diversions and constraints that are placed upon any contractors assigned to these projects to ensure that reasonable access between to and from the B1122 and Saxmundham is maintained

Q1. Will SZC share their integrated plans for these road developments, closures and diversions and ensure that their contractors hold to those plans ensuring at least one cross country route is available at all times during the construction/alteration period whilst the SLR is put in place and opened.

Submitted by Kelsale-cum-Carlton Parish Council

Q1. With the volume of traffic (80%) passing on A12 through Kelsale-cum-Carlton what mitigation measures are available to residents with properties in Curlew and North Greens and those alongside A12.

Has extra glazing or any kind of noise insulation been offered as an example

Submitted by Leiston-cum-Sizewell Town Council

Q1. As the project progresses, Leiston is witnessing increasing pressure on the town centre and the surrounding residential roads from domestic vehicles and LGVs. The most recent being the decision to divert traffic from Abbey Lane through the town. If traffic studies show a marked increase, please explain how the project will address what is already an uncomfortable amount of traffic. The situation will rapidly worsen this year and there is no set date for completion of the town centre traffic and transport scheme or the park and ride facilities.

Q2. Please can you confirm if traffic monitoring through the town centre has been agreed by the Transport Review Group as it wasn't included in the original plan.

**Submitted by Middleton-cum-Forley Parish
Council**

Q1. Please state when the planned electronic traffic warning sign at the junction of the B1122 and Mill Street, Middleton will be active. At the Northern Transport Forum on 7 August it was stated that it could be erected at the same time as the permanent 30 limit signs during Q4 2024.

Q2. Please state approximately how many trees have been felled so far across all sites.

Forum Schedule

2025

All forum timings:
18:30 - 20:30 (arrival from 18:00)

Our forums are open to local people to attend as observers – and they're another great way for you to hear about our latest work.

Main Development Site Forum	Wednesday 15 January 2025	Leiston Town Athletic Association
Northern Transport Forum	Wednesday 5 February 2025	Darsham Village Hall
Southern Transport Forum	Wednesday 12 March 2025	Stratford St Andrew Riverside Centre
Community Forum	Thursday 27 March 2025	High Lodge Darsham
Main Development Site Forum	Wednesday 2 April 2025	Leiston Town Athletic Association
Northern Transport Forum	Wednesday 7 May 2025	Darsham Village Hall
Southern Transport Forum	Wednesday 4 June 2025	Stratford St Andrew Riverside Centre
Main Development Site Forum	Wednesday 2 July 2025	Leiston Town Athletic Association
Northern Transport Forum	Wednesday 6 August 2025	Darsham Village Hall
Southern Transport Forum	Wednesday 3 September 2025	Stratford St Andrew Riverside Centre
Main Development Site Forum	Wednesday 8 October 2025	Leiston Town Athletic Association
Community Forum	Thursday 23 October 2025	Sizewell Sports and Social Club
Northern Transport Forum	Wednesday 5 November 2025	Darsham Village Hall
Southern Transport Forum	Wednesday 3 December 2025	Stratford St Andrew Riverside Centre

**OPEN
DAY**

ACTIVITIES • ARTEFACTS • TALKS

**22–23
FEB**

SAT 22 @ 10–4

SUN 23 @ 10–3

**ARCHAEOLOGY
OF SIZEWELL C
DEVELOPMENT SITE**

**WATERLOO CENTRE,
WATERLOO AVE.,
LEISTON, IP16 4HE**

FREE admission to Sizewell C archaeology exhibition



Sizewell C
The power of good for Britain

Sizewell C
The power of good for Britain

Item 4 71



Thank you

