



# Sizewell C Southern Transport Forum

Wednesday 3rd September 2025

# Agenda

Item 1: Welcome and Introduction of the Chair and Panel – *(Chair)*

Item 2: Meeting note and matters arising from Southern Transport Forum  
*(Wednesday 4th June 2025) – (Chair)*

Item 3: Corporate and Community Relations – *(Marjorie Barnes)*

Item 4: Road and Rail Updates – *(David Peacop, David Seal, Ed Lennard and David Taylor)*

Item 5: Traffic Movements and Transport Review Group Update – *(Rebecca Quigg and Steve Merry)*

Item 6 : Q&A – via Town and Parish Council Representative – *(Chair)*

Item 7: Dates of Future Meetings – *(Chair)*

# Item 1: Welcome and Introductions

# Sizewell C Panel

<b>David Peacop</b>	Site Operations Director
<b>David Seal</b>	Offsite Delivery Manager
<b>Marjorie Barnes</b>	Head of Regional External Affairs and Development
<b>Richard Bull</b>	Head of Planning
<b>Richard Knight</b>	Senior Community Relations Manager
<b>Ed Lennard</b>	Rail Delivery Manager
<b>Rebecca Quigg</b>	Transport Co-Ordinator
<b>David Taylor</b>	Network Rail
<b><u>Advisors</u></b>	
<b>Zoe Botten</b>	Community Relations Manager
<b>Jez Porter</b>	Stakeholder and External Roads Lead
<b>Darren Benford-Brown</b>	Community Safety Officer
<b>John Craddock</b>	Senior Project Manager

# Item 2: Meeting note and matters arising from STF (4th June 2025)

Chair

# Item 3: Corporate and Community Relations

Marjorie Barnes, Head of READ

# Government Gives Sizewell C Green Light

The UK Government gave the go-ahead for Sizewell C on 10 June.

This is the first British-owned nuclear power station to be announced in over three decades, with HMG as a majority shareholder alongside EDF.

The Chancellor confirmed the funding at the GMB Congress ahead of the Government's spending review where £14.2 billion of investment will be allocated to the project.





# Final Investment Decision



Joint MDs Nigel Cann and Julia Pyke with Sizewell C Chairman, John Holland-Kaye, meeting Chancellor of the Exchequer, Rachel Reeves MP, Secretary of State for Energy Security and Net Zero, Ed Miliband MP and our new investors La Caisse, Centrica and Amber Infrastructure and EDF at Imperial College on Tuesday.

- Sizewell C has secured its Final Investment Decision, giving the green light to the nuclear plant
- The project is estimated to cost around £38 billion, with investors and the supply chain incentivised to deliver below this
- For the first time, the British public will be co-owners of a British nuclear power station, with the government the largest shareholder in the project alongside EDF, Centrica, La Caisse and Amber Infrastructure.



# Pre-2020

10 years of project development including

75,000 page environmental impact assessment

Multiple rounds of consultation

Development of the detailed HPC design

ONR agreements

Community engagement







Artist's impression: Aerial view of Sizewell C



# Community Projects Receive £2.4m Funding Boost

**The Sizewell C Community Fund will provide up to £23m over the next decade for charities, community groups and social enterprises which are delivering projects that benefit local communities in East Suffolk.**

The focus of the fund is on reducing the impact of the construction of Sizewell C nuclear power station and leaving a legacy of benefit in the most affected communities.

£490,000 awarded by the Suffolk Community Foundation in the fourth round of funding in June, bringing the total support awarded so far to over £2.4m.

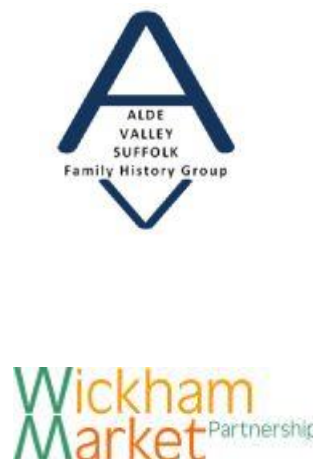

# College on the Coast

Plans for a new college in Leiston are progressing well and we will soon publish details for consultation. The new college in Leiston will strengthen local FE and adult training and create a lasting skills legacy.





# Opportunity for local area.

The post-16 college will be delivered in partnership with Suffolk New College, aiming to transform local access to Further Education and specialist vocational training.

The three main components of the plans are:

- **College on the Coast**

Delivering technical, vocational, and academic pathways aligned to the workforce needs of Sizewell C and the wider energy, infrastructure, and engineering sectors.

- **Apprenticeship and Trainee Hub**

a dedicated centre for supporting up to 540 local apprentices, part of Sizewell C's commitment to delivering 1,500 apprentices during construction.

- **Centre of Excellence**

purpose-built, temporary training infrastructure for Sizewell C's project-facing workforce, focused on 'Right First Time' skills in civils, mechanical, electrical and welding.



# College on the Coast designs

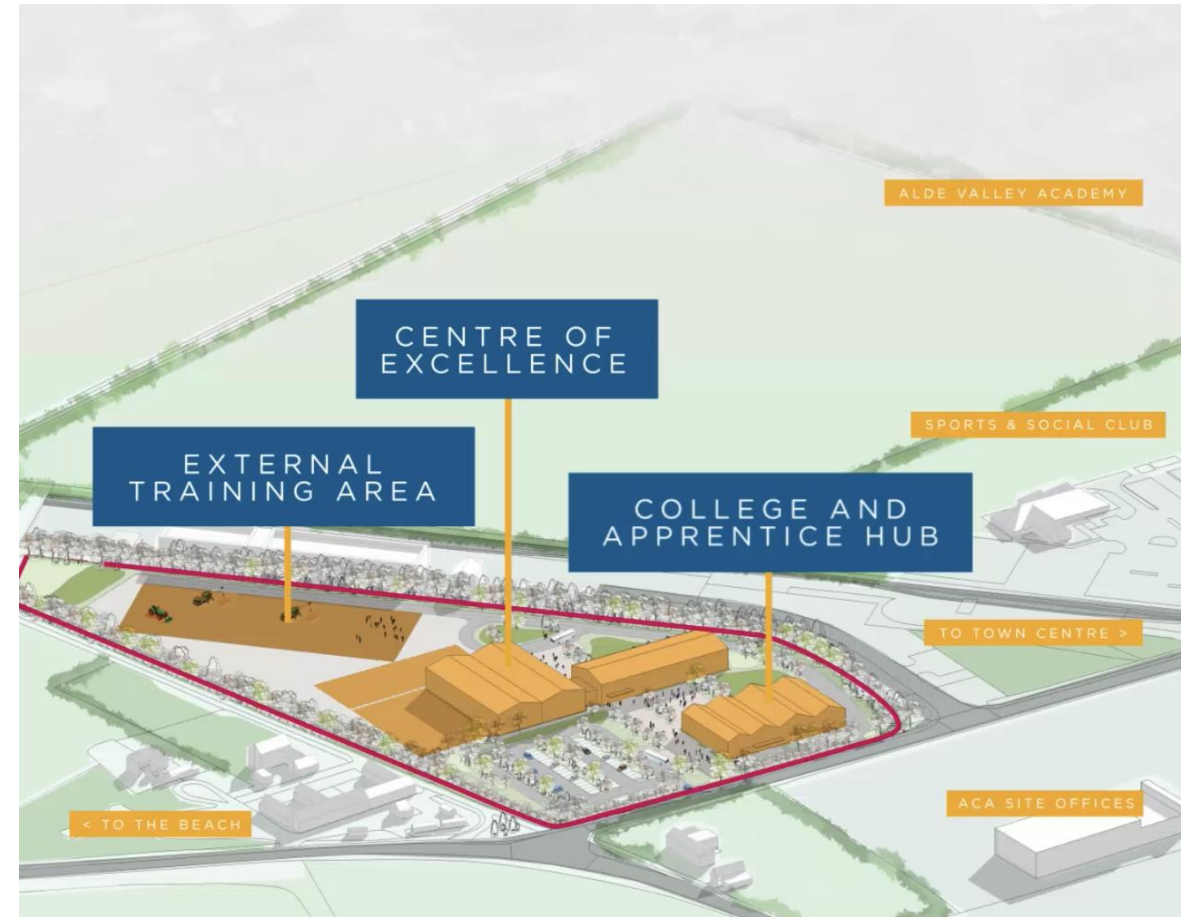
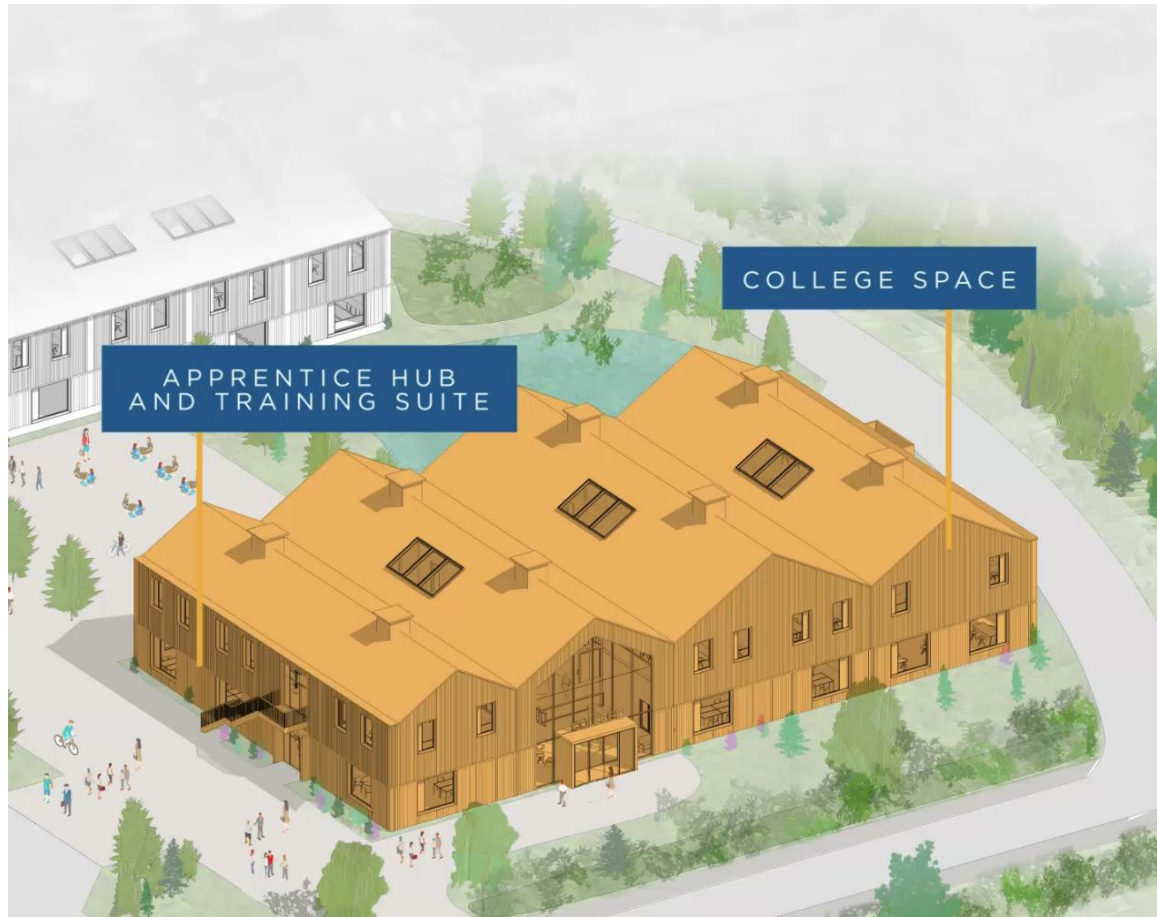





# Archaeology Outreach



## Our archaeologists will be sharing their finds at:

Stratford St Andrew Riverside Centre	25 October 2025
Yoxford Village Hall	21 February 2026
Therberton & Eastridge Village Hall	Date to be confirmed

## We are also planning a series of online webinars:

Reshaping the archaeological landscape: an introduction to the excavations associated with Sizewell C	8 October 2025
'1042 and all that': the contents and context of the Sizewell C coin hoard	3 December 2025
The Bronze Age	25 February 2026
The Medieval Landscape	29 April 2026



# Keeping communities updated

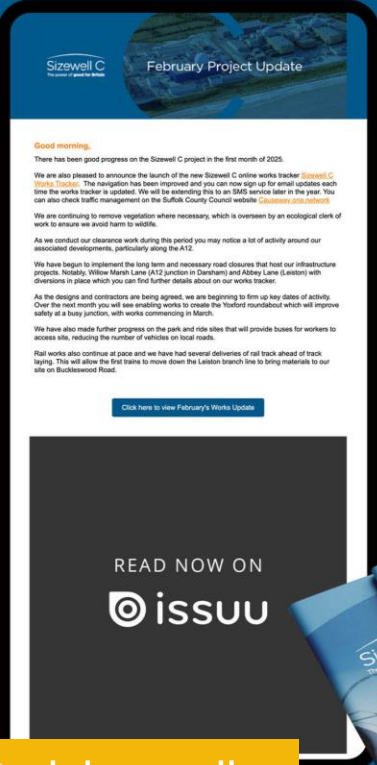

Parish emailer

Parish/forum meetings



Works Tracker

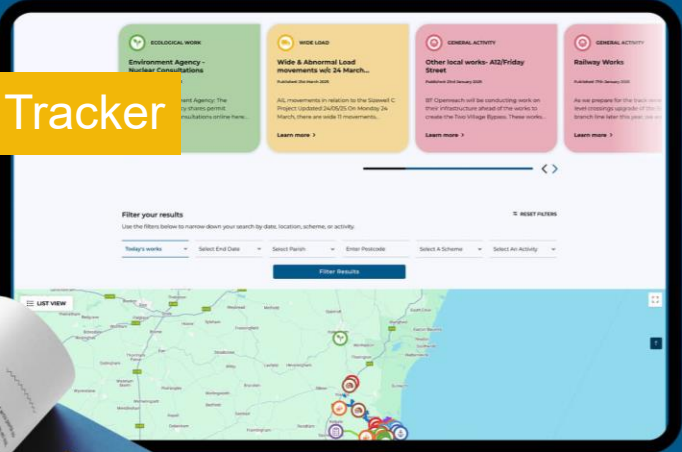

Newsletter



Parish magazines

# Item 4: Road and Rail Updates

David Peacop, Site Operations Director

David Seal, Offsite Delivery Manager

Ed Lennard – Rail Delivery Manager

David Taylor – Senior Construction Assurance Manager – Network Rail

# Site Delivery Lookahead

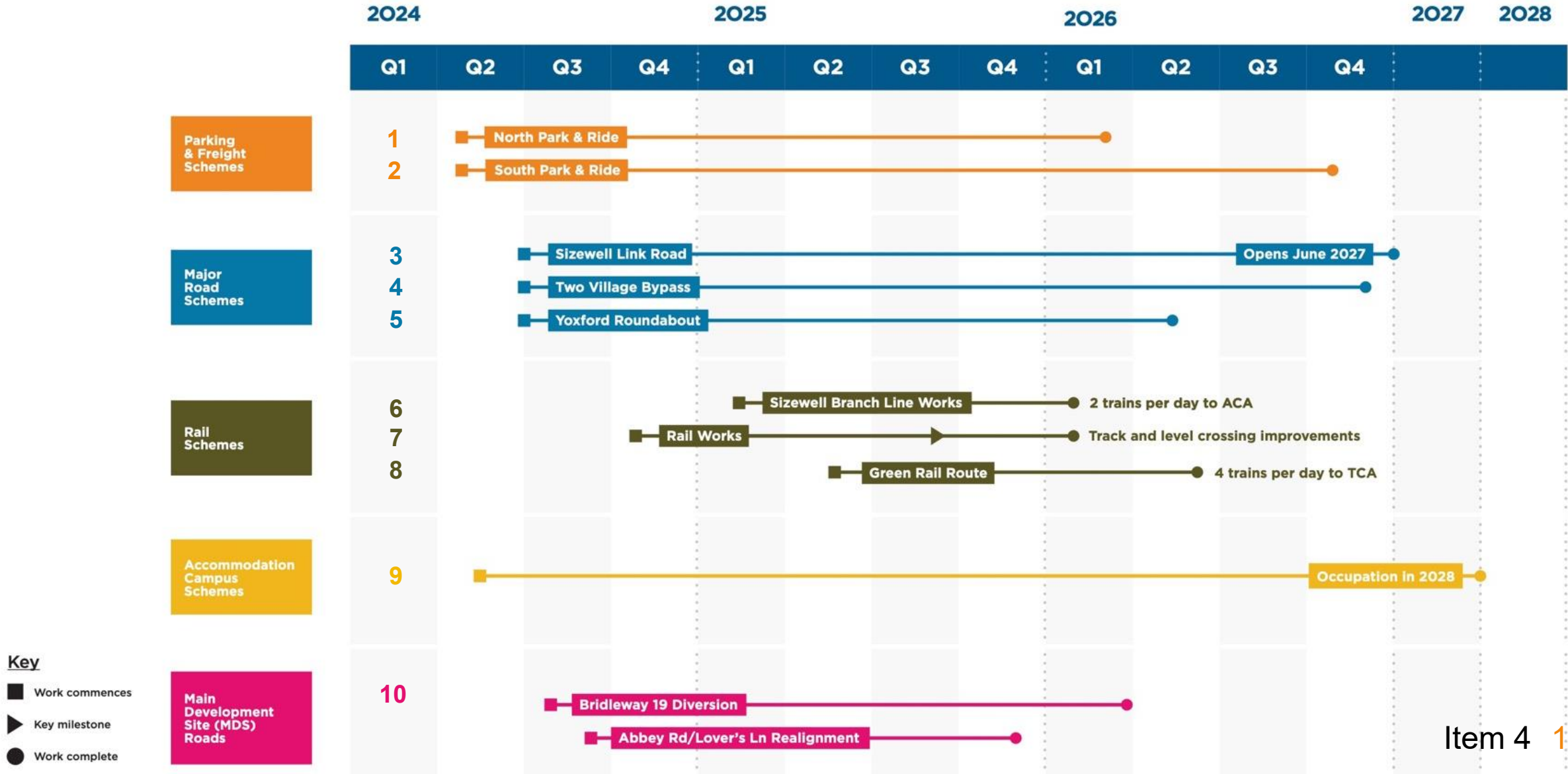

# Southern Park and Ride Q3-Q4 2025



- Contractor Galldris is on site and preparing to construct with aim to have 25% of SPR operational by the end of the year.
- Construction of footpath along the slip road to commence mid November and will require traffic management, road repairs including resurfacing and road markings. Traffic management (lights) will be required this will be tied in with the Layby works completion in mid December. This will require nighttime road closures.
- Diversion of irrigation main within site nearing completion.
- Principal Contractor's main compound under construction.
- Earthworks preparation and early works commenced site wide.

## Utilities

- Power line into the Southern Park Ride that will run from connection point (outside the Farm Shop at Marlesford on the A12) to commence 15 September – 9 November. Traffic Management (lights) along A12 from the Farm Shop required at points. Marlesford Road to be temporarily closed whilst cable is laid. Precise dates tbc
- Ongoing cadent diversions and upgrades on slip road due to finish 19th Sept (slip road lane north bound slip) and the B1116 until 10 October which includes traffic lights



# Local Roads

## 2025 Anticipated Commencement Dates

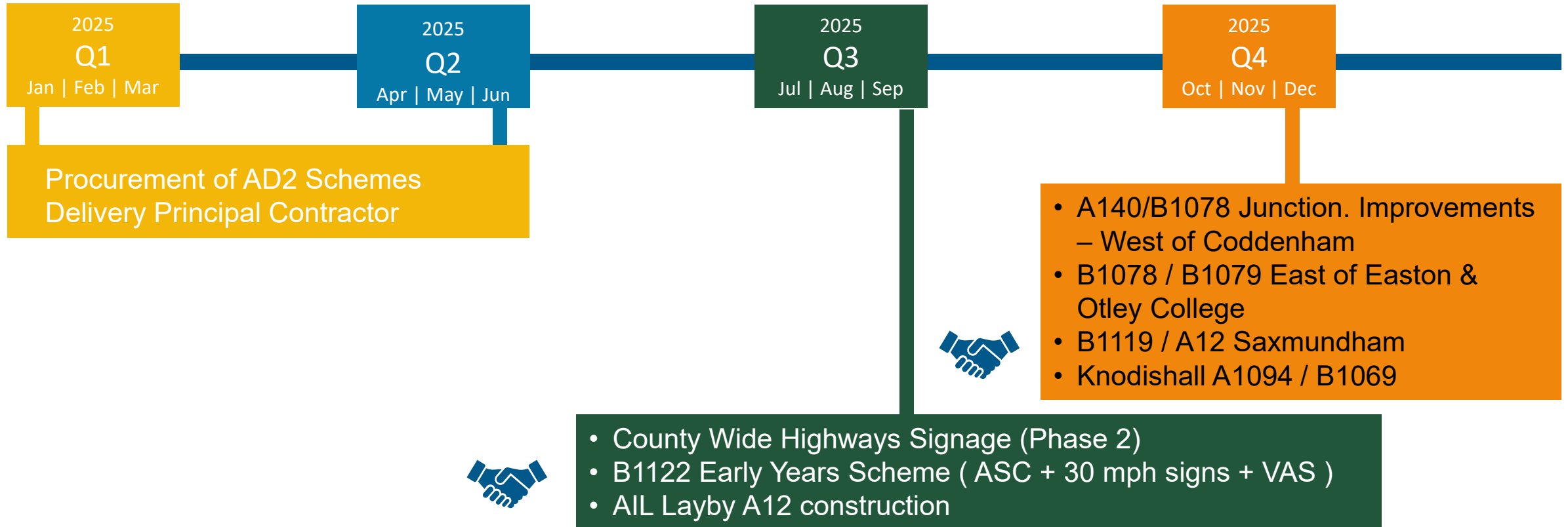

Collaboration with Scottish Power Renewables



# Countywide Highways Signage Phase 2 – Q3 / Q4

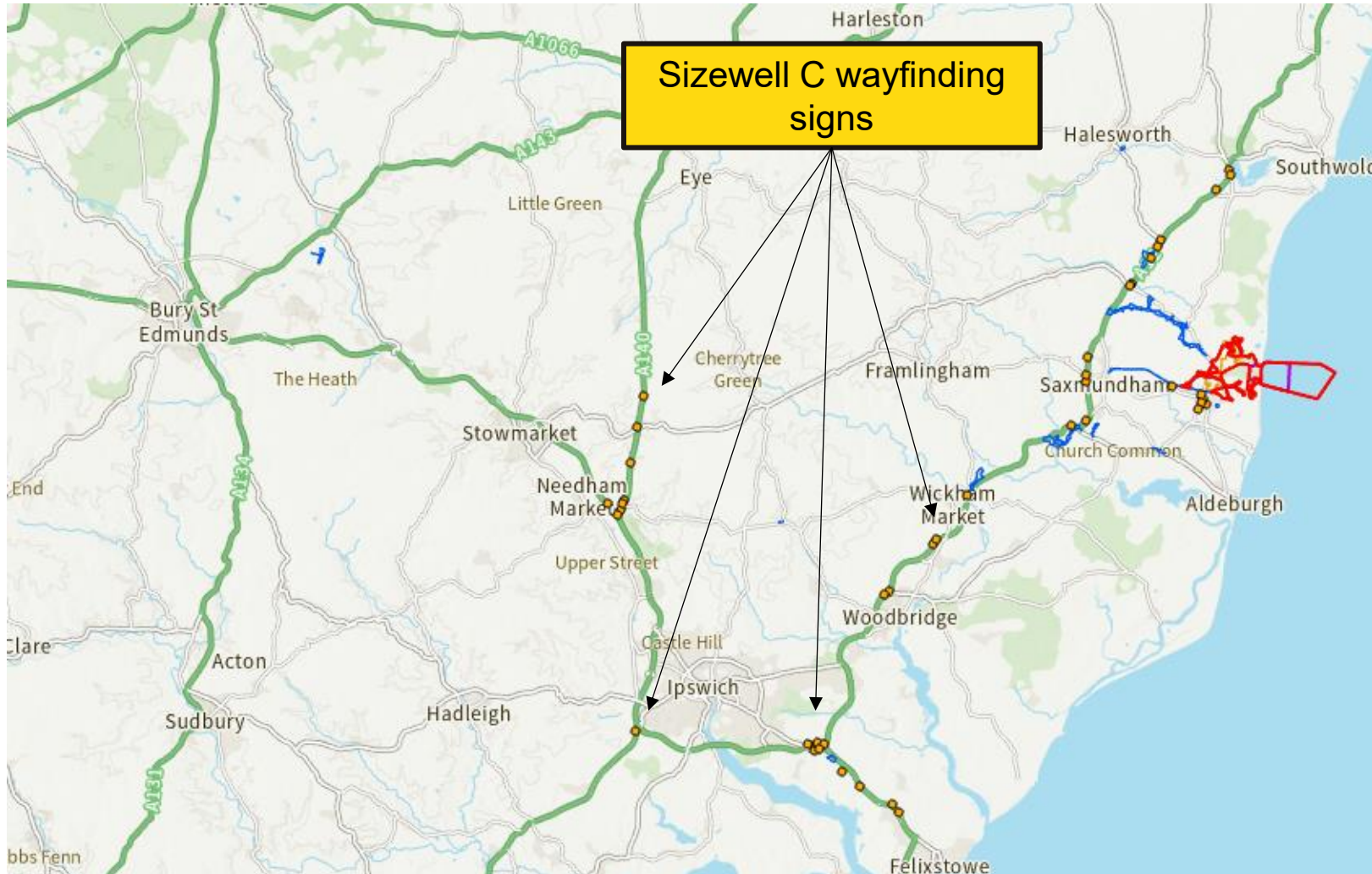

## Scheme Overview

- Phase 2 sees the replacement of temporary A-frame signs installed during Phase 1 of CWHS.
- Phase 3 will see way finding signs for the P&Rs and FMF.

Example sign face:



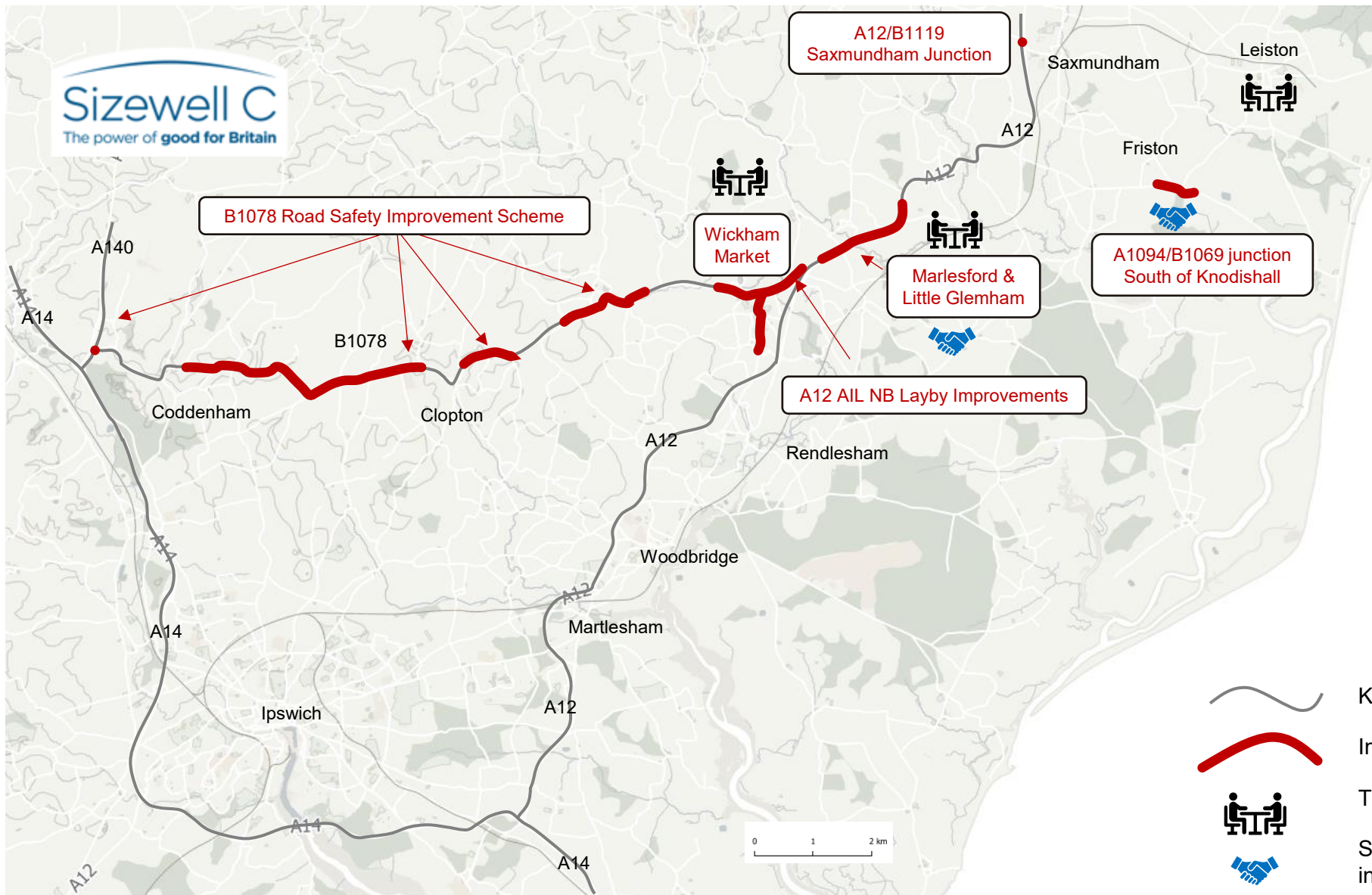

## A12 Improvements & Local Roads Schemes – South



### Typical improvements

- New and enhanced pedestrian footways and crossings
- New road surfacing
- Village gateways
- Safety improvements and side road visibility
- Reduced speed limits



Key road



Improvement scheme



Transport Working Group



Scottish Power Renewables scheme interface



# B1078 Road Safety Improvements November / December 2025

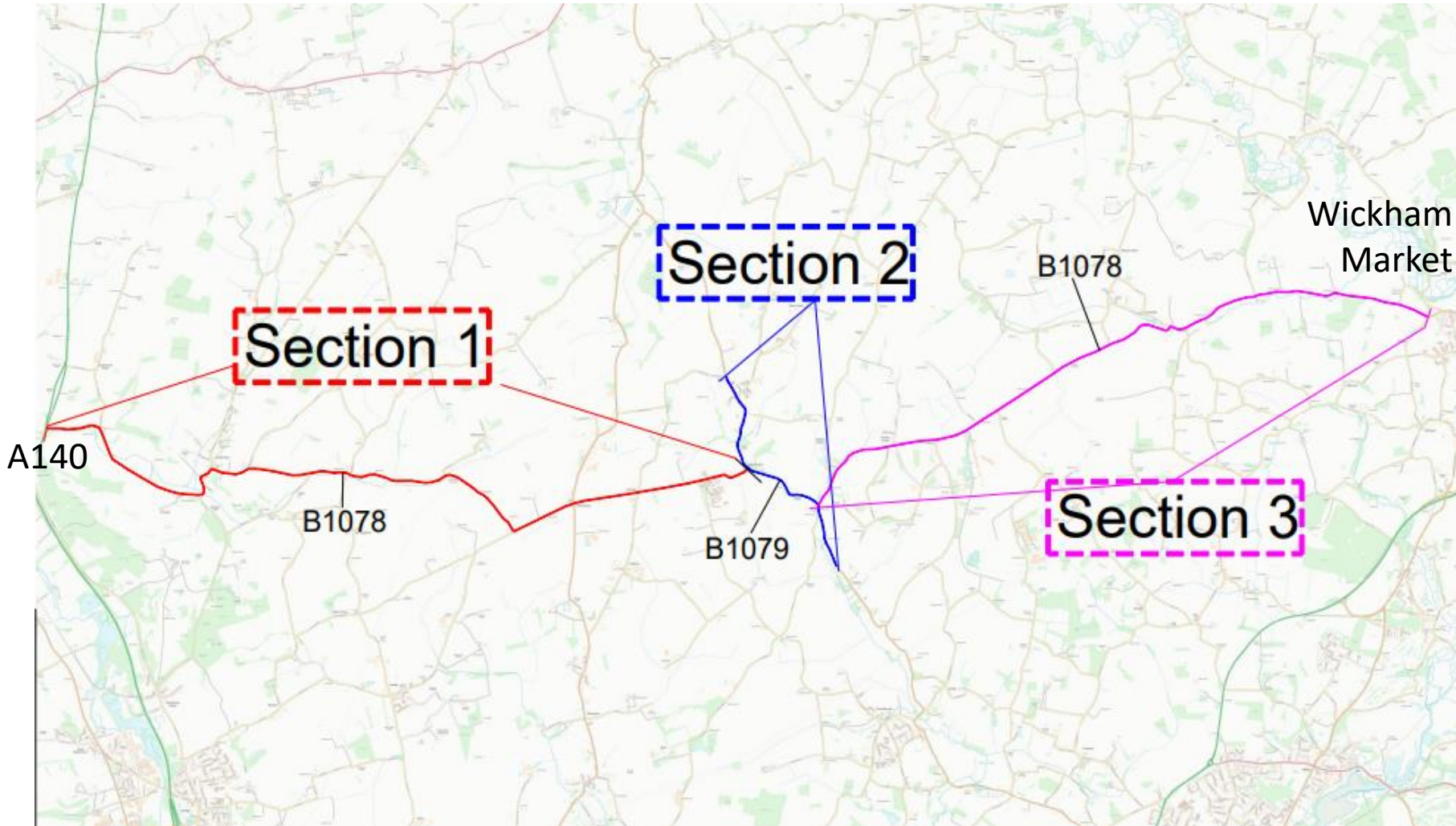

## Scheme Overview

- Road safety improvements between the A140 and Wickham Market.
- Scheme split into 3 sections for delivery.
- Each section will have its own diversion route.

## High Level Scope

- Speed limit reductions
- New signage
- Vegetation clearance for visibility splays
- Resurfacing.
- Consultation letters to residents and communities along B1078 will be sent out Wednesday 10 September

# B1078 Road Safety Improvements Nov / Dec 2025

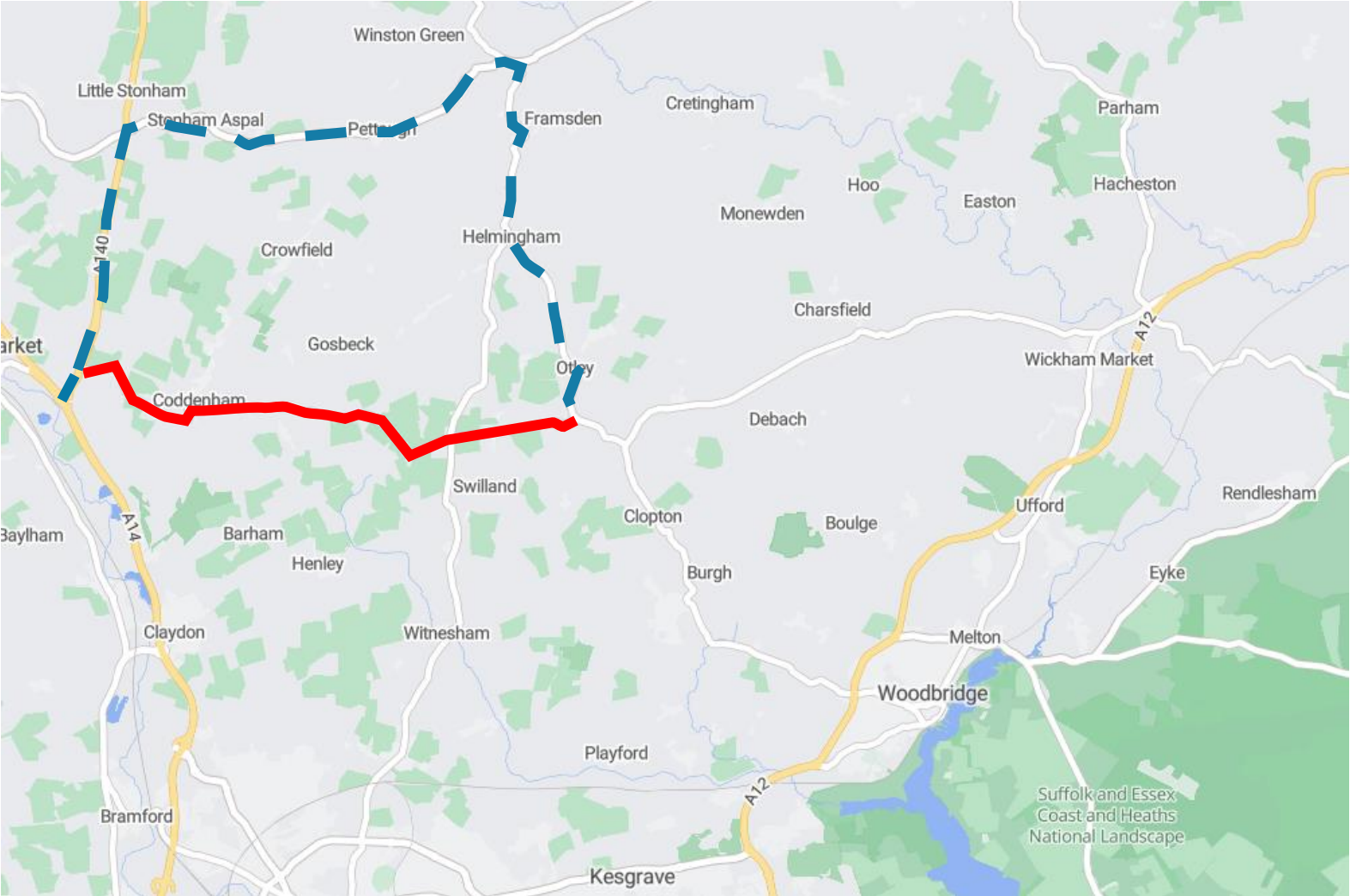

## Section 1

- Length of closure will vary slightly depending on work area.

## Potential Diversion route (TBC)

A140 – A1120 – B1077 – B1079

### Key:

Section/Closure area —

Diversion - -



# B1078 Road Safety Improvements Nov / Dec 2025

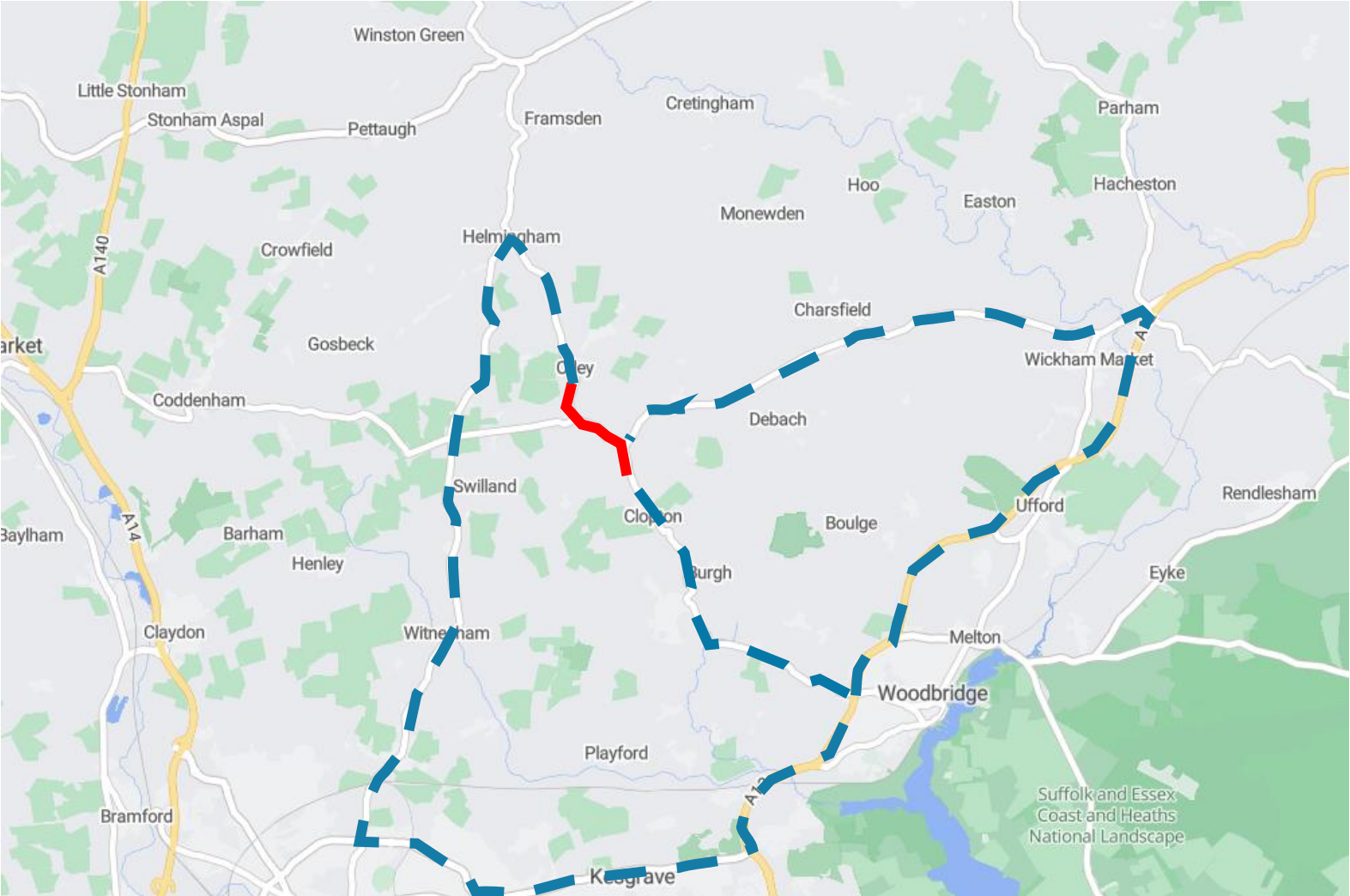

## Section 2

- Length of closure will vary slightly depending on work area.

## Potential Diversion route (TBC)

B1438 – A12 – A1214 – B1077

### Key:

Section/Closure area —

Diversion - -

# B1078 Road Safety Improvements Q3 2025

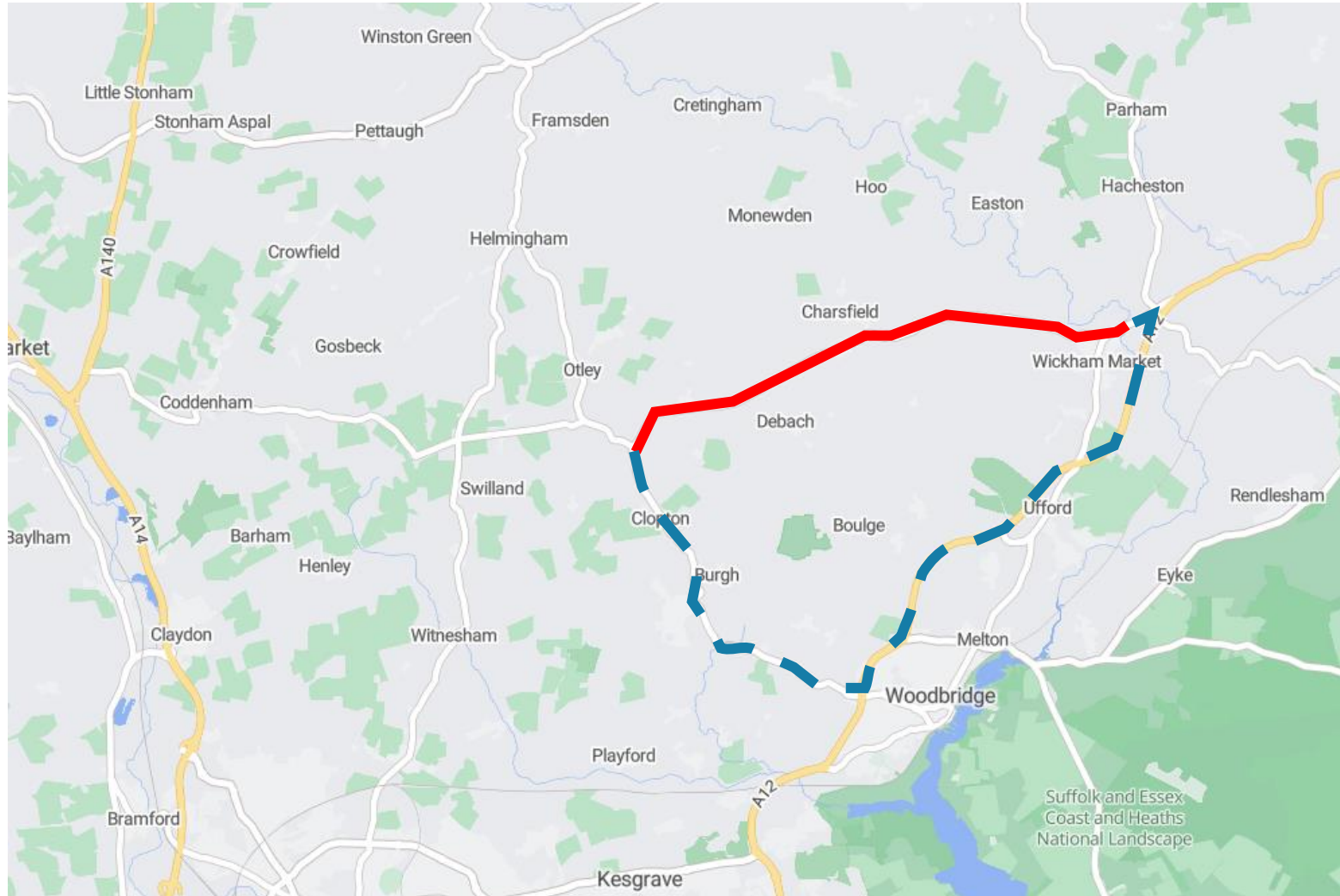

## Section 3

- Length of closure will vary slightly depending on work area.

## Potential Diversion route (TBC)

B1438 – A12 – B1079

**Key:**

Section/Closure area 

Diversion ■ ■



# Two Village Bypass - Update Sept 2025

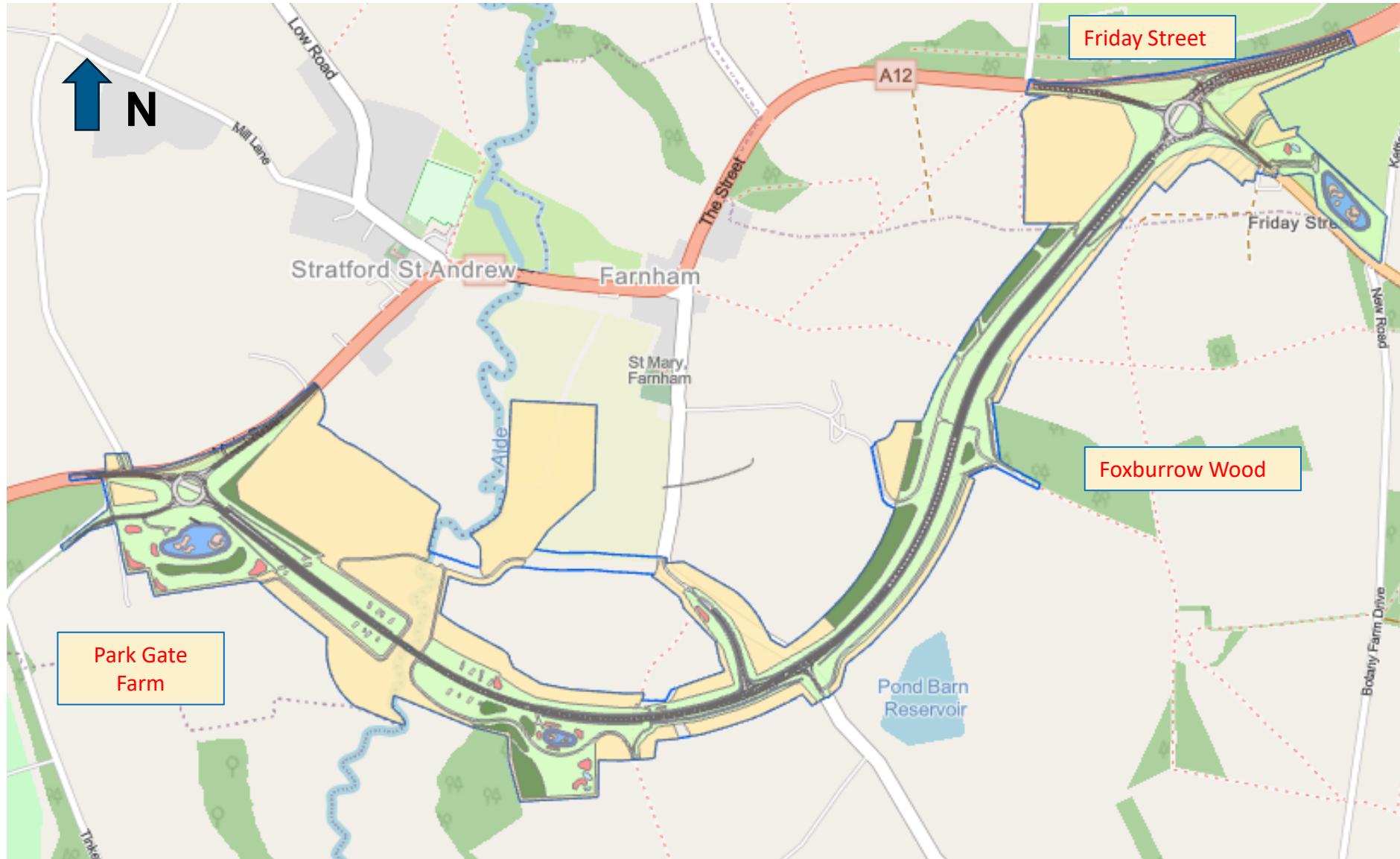

- Technical Approval granted
- Archaeology Clearance works ongoing (Tinker Brook, TVB Central and Foxborrow Wood)
- Tree and Ecology clearance completed. Ongoing maintenance schedule implemented.
- Tinker Brook Access works completed
- Friday St works started
- TVB early works started

# Two Village Bypass-West Roundabout Park Gate Farm





# Two Village Bypass West Roundabout –Q4 Park Gate Farm



## Progress:

- Detail design, SCC technically approved
- Vegetation & ecology clearance complete
- Principal Contractor setting up site
- Tinker Brook Lane access complete
- Archaeology nearing completion
- Main site compound and haul roads are being installed

# Friday Street Roundabout

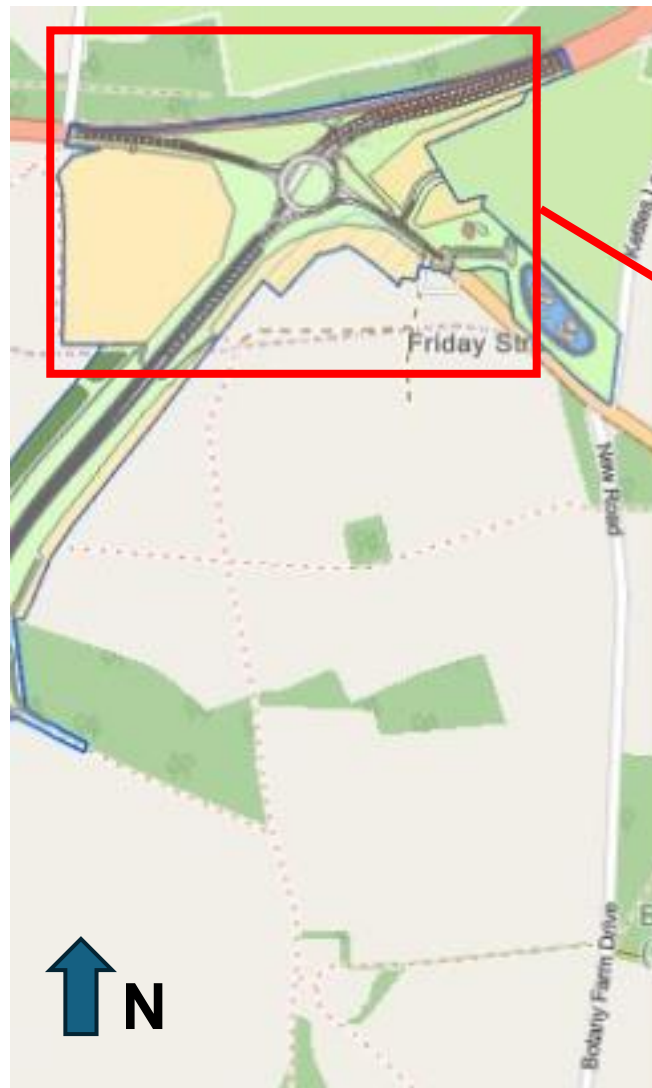



# Friday Street Roundabout



## Progress:

- Detail design, SCC technically approved
- Vegetation & ecology 98% clearance complete
- Principal Contractor fully mobilised and site established
- Utility diversion works 95% complete
- A12 North bound widening complete
- Main site earth-works and South bound A12 widening has started

# A12 AIL layby Q3 2025

## Scheme Overview

- Improvement of existing layby to support abnormal indivisible loads (AIL) during SZC construction.

## High Level Scope

- New sheet pile retaining wall
- Pavement construction
- Installation of new barrier/vehicle restraint system

## Current Progress

- Vegetation and topsoil clearance
- Grading of embankment and excavation in preparation for sheet piling.





# A12 AIL layby Q3-Q4 2025

## A12 AIL Layby Improvements Traffic Management and Temporary Traffic Regulation Orders

### Rationale of lane closure

- Improve traffic flow through works
- By continuing the one lane of the A12 Avoid bottlenecks where dual lanes merge.
- Improved safety for site staff.
- Utilisation of lane closure by SCC for routine maintenance.
- Assist abnormal indivisible works through works area.
- We have reduced speed limits including: 50mph from Bredfield to off-slip south of Layby and 40mph from Wickham Market off-slip to B1078 on-slip
- Duration of works and traffic management August – December 2025

On-going review & monitoring to confirm suitability of traffic management.

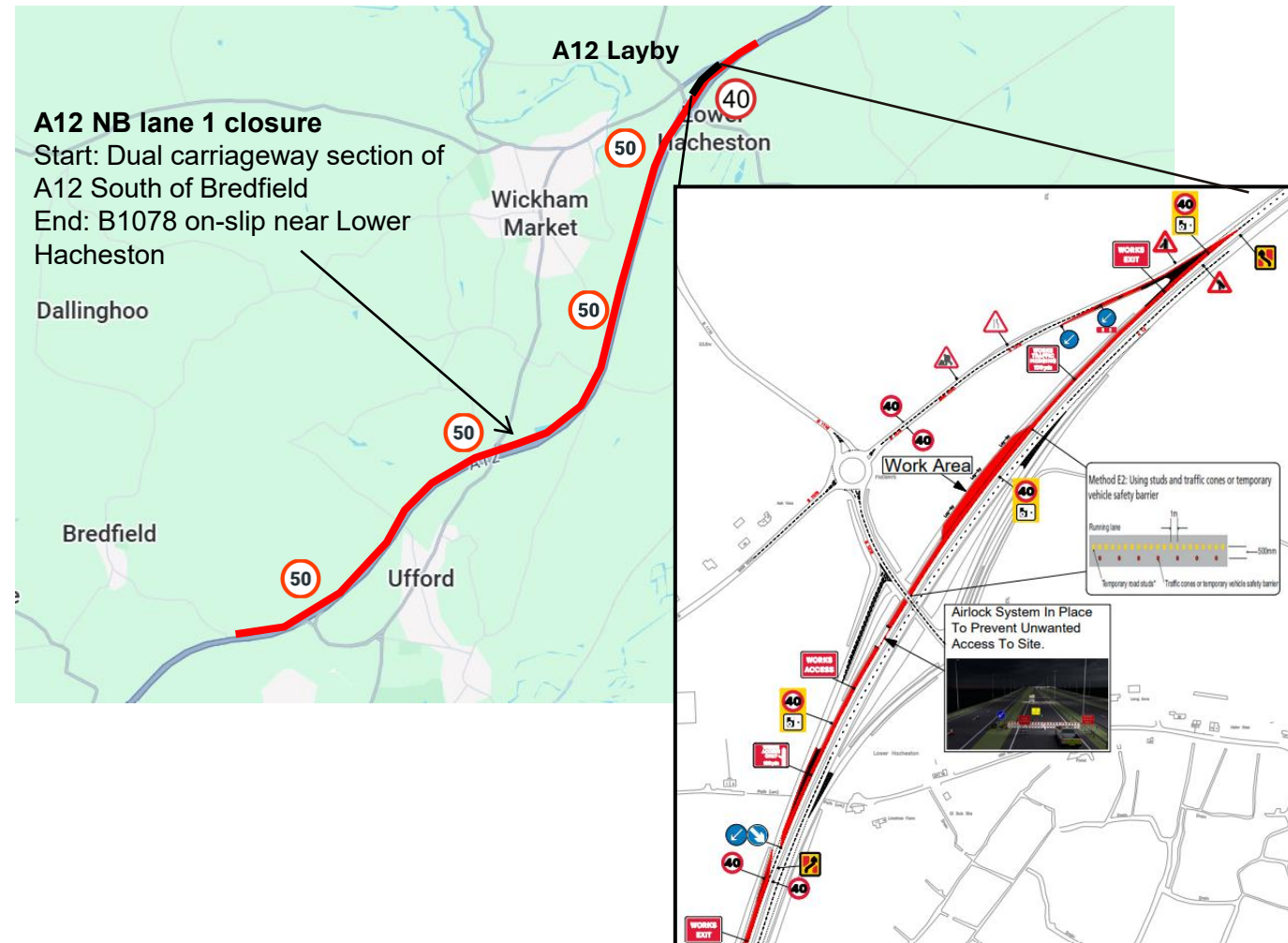

# Traffic Management Summary – September 2025

To enable Friday Street, TVBP and Southern Park and Ride.



## Legend:

- Day and Night Road Closure 
- Night-time Road Closure 
- Diversion 
- Lane Closure 
- Traffic Signals 

**September 2025**

# Traffic Management Summary – October 2025

To enable Friday Street, TVBP and Southern Park and Ride.

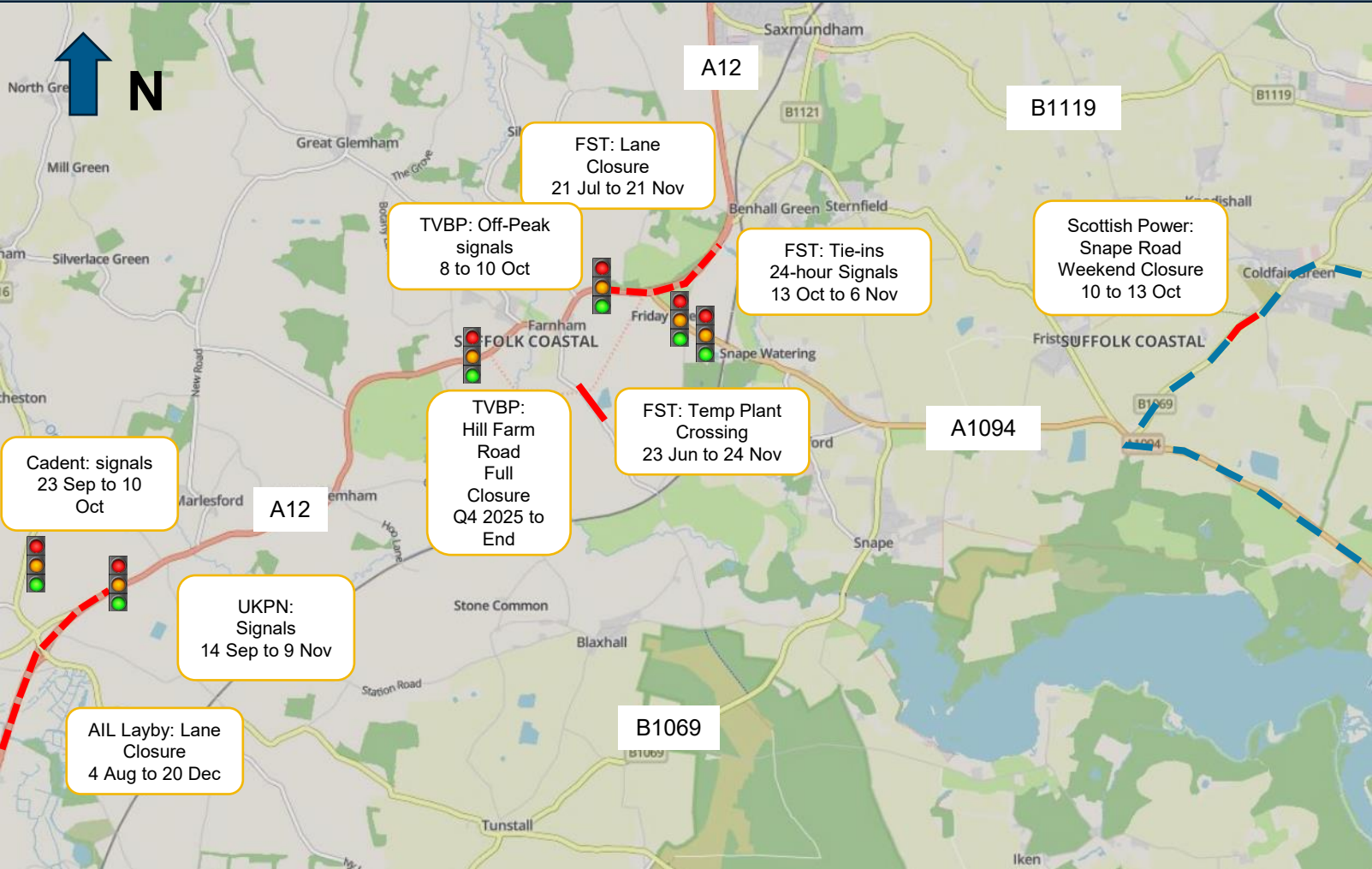

## Legend:

- Day and Night Road Closure 
- Night-time Road Closure 
- Diversion 
- Lane Closure 
- Traffic Signals 

**October 2025**



# Traffic Management Summary – November 2025

To enable Friday Street, TVBP and Southern Park and Ride.



## Legend:

- Day and Night Road Closure 
- Night-time Road Closure 
- Diversion 
- Lane Closure 
- Traffic Signals 

**November 2025**



# Water Strategy

## Short Term

- We are working with Anglian Water to supply water for required dust suppression and associated development construction
- Agreed extraction points are at Levington on the Felixstowe Road and Hawkers Road at Martlesham
- On site we have extraction points and water storage
- We monitor the water situation supply and demand with water companies.
- East Suffolk is rated 'Good' for water currently. Drought conditions have not been required this summer
- Residents and local businesses are priority if drought conditions declared

## Long Term

- Desalination plant, currently under construction at the Temporary Construction Site
- Further extraction points constructed storage at Orwell Logistics Park including storage
- Working with water companies for long term water supply and management. Investing in water pipe for the duration of operation of Sizewell C





# Orwell Logistics Park - Freight Management Facility Q1+Q2 2025







39

28



# Passenger Service Routes up and running

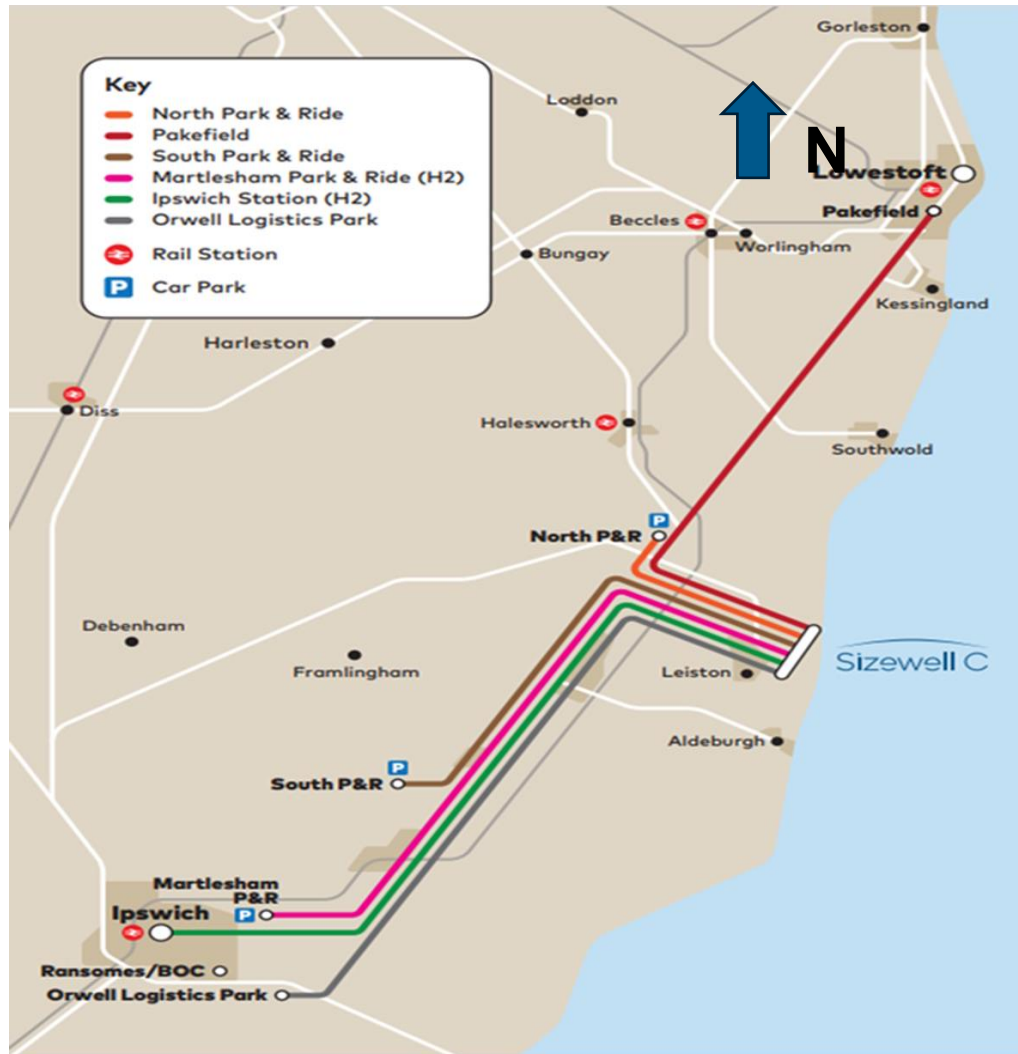

## Passenger Services from

- Martlesham P&R
- Pakefield
- Orwell Logistics Park
- Ipswich Train Station
- Northern park and ride (Darsham)
- Southern park and ride (Wickham Market)
- Development of others is dependant on workforce location

# Signs in Vehicles



# Sizewell C



**For more information call:**  
**0800 197 6102**

# Item 4 continued: Rail Updates

Ed Lennard – Rail Delivery Manager

David Taylor – Senior Construction Assurance Manager – Network Rail



# Rail Delivery – Buckleswood compound works



Dust Suppression on site



Drainage works



Soil Stabilisation (completed)



# Rail Delivery – ACA works



**Ballast Delivery**



**79 Nr Track Panels being stored in the ACA**

**Plain line Track Panels Delivery**



# Rail Delivery - Branchline Track

## McCullochs Panel Lifters

Lifting & moving track panels



## Moving rails for installation by NTC



## High output New Track Construction Machine (NTC)

- 3.7km new track installed along branchline (west end of route)
- NTC: 50% quicker, improved quality, improved safety, minimises noise and disturbance



## Ballast unloading



## Tamping



## Current status



# Rail Delivery – Plan on a Page

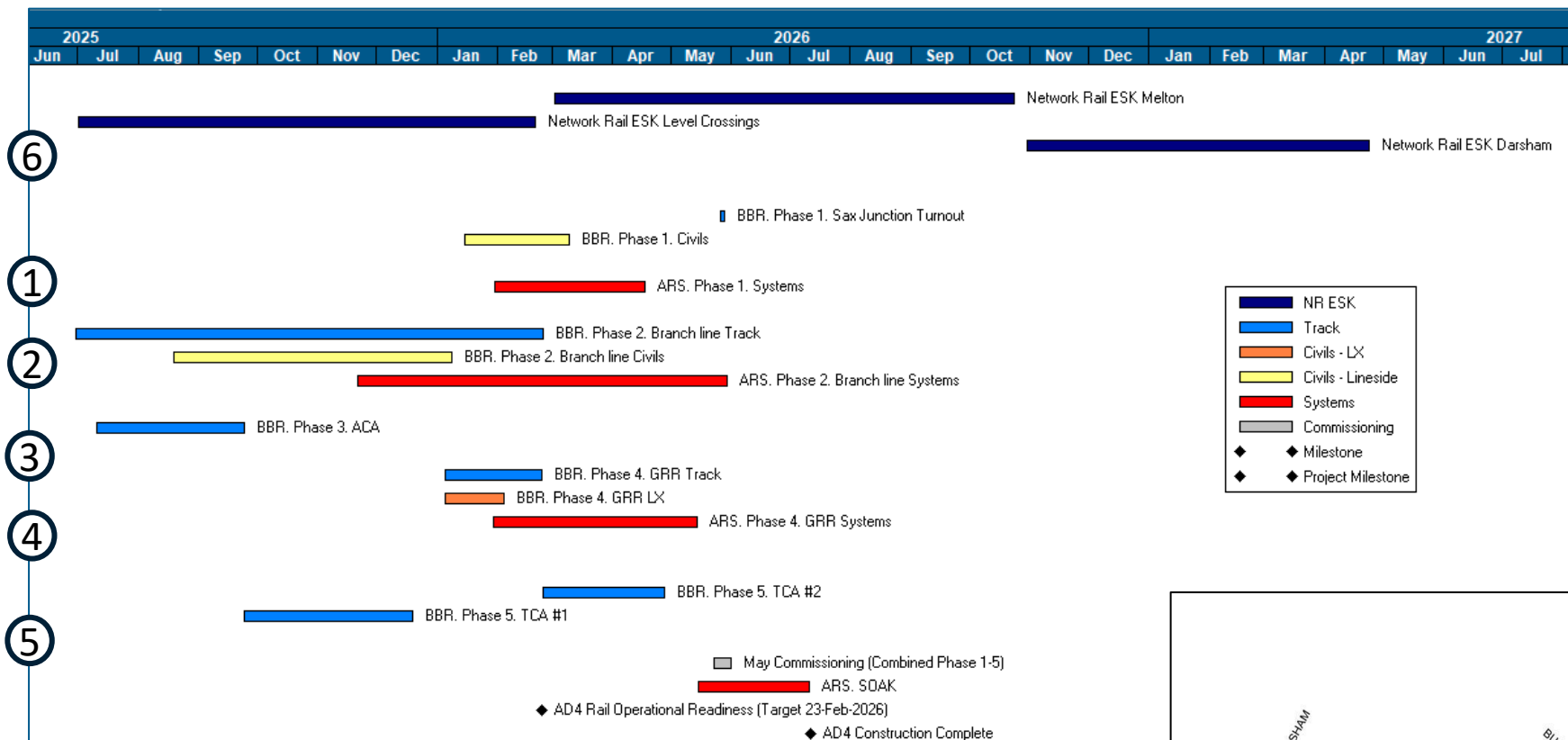

	Location	Scope
1	Saxmundham Junction	Upgrade existing junction
2	Sizewell Branch line	Track upgrade Level crossing upgrade (7Nr) Signalling upgrade
3	ACA Sidings	Temporary sidings (3Nr)
4	Green Rail Route	Temporary connection to TCA New level crossings (2Nr)
5	TCA Sidings	Temporary sidings (8Nr)
6	East Suffolk line	Level Crossing upgrades (11Nr) Track upgrades Signalling upgrade

## Next steps:

- Green Rail Route turnout installation
- Leiston & Saxmundham Road level crossing utilities diversions
- Branchline track upgrade (eastern section)
- ACA track construction
- TCA track mobilisation
- ESK Level crossing upgrades (by NR)

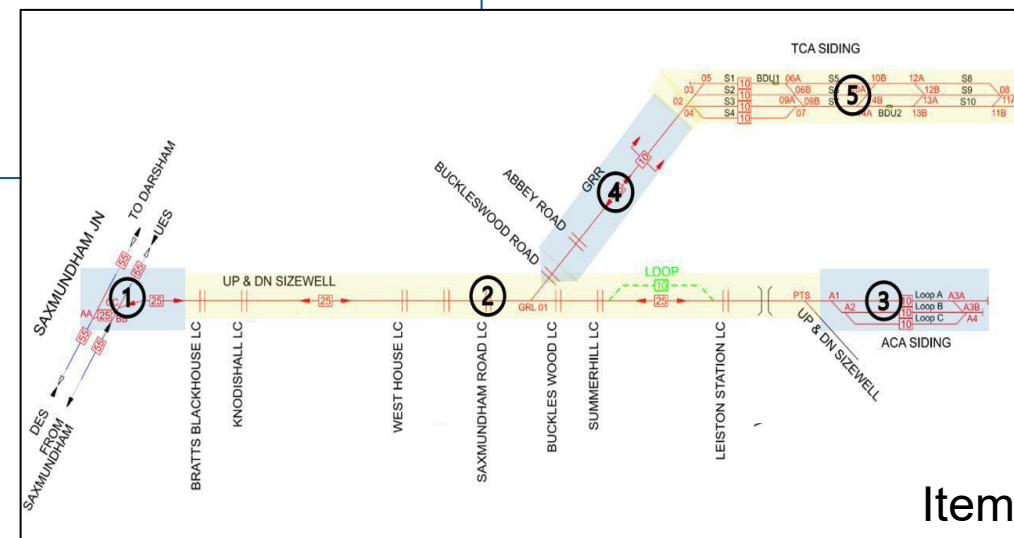



# Southern Transport Forum NWR Update





# Melton Level Crossing – Update

Survey works are ongoing at Melton Level Crossing, with planned overnight road closures in place for this weekend 5<sup>th</sup> – 8<sup>th</sup> September.

Upgrade works at Melton, for both the road and the level crossing, are currently forecast to commence from Summer 2026.

This forecast date is subject to change as a result of the complex interfaces (rail/road/utilities/3<sup>rd</sup> parties) required to agree a delivery strategy.

Greater detail will be published in advance for any periods of disruption to allow the local community to plan accordingly.



# ESK LX Planned Construction Programme

Level Crossing	Start	Forecast Finish	Traffic Management
Brick Kiln	w/c 06/10/2025	w/c 20/10/2025	Min requirement 2 days for road resurfacing, planned at night and liaison with local resident.
Blackstock	w/c 27/10/2025	w/c 01/12/2025	Min requirement 2 days for URX, planned at night.
Red House Farm	w/c 27/10/2025	w/c 01/12/2025	Traffic management to be agreed with landowner to minimise disruption.
Melton Sewage	w/c 01/12/2025	w/c 12/01/2026	No requirement
Dock Lane	w/c 01/12/2025	w/c 12/01/2026	No requirement
Ellingers	w/c 01/12/2025	w/c 12/01/2026	Traffic management to be agreed with landowner to minimise disruption.
Kingston Farm	w/c 19/01/2026	w/c 09/02/2026	Closures to be planned in line with landowner.
Bealings	November 2025	January 2026	No traffic management envisioned at this time. Methodology to be confirmed.

For the majority of the construction periods, these level crossings will be open to public use as normal. Where closures are in place they will be up to 15m either side of the affected level crossing.







# Melton LX Closed Weekend of 2 August 2025



Item 4

## What happened

Residents experienced considerable inconvenience due to the closure of Melton level crossing

### **This was due to a miscommunication**

- ☒ The traffic management plans for the work due in October were implemented instead of the plans for the weekend of 2 August 2025.
- ☒ This was an error caused by the project manager of our traffic management company sending the wrong plans to the team on the ground.
- ☒ As soon as the mistake was identified, the closure was lifted – *but not before it had affected local residents and road users.*

## What are we doing differently

- ✓ Briefings to traffic management to try and prevent this happening again.
- ✓ The project manager has been asked to put in place an additional check with the team on the ground to make sure the correct week's instructions have been sent and received.
- ✓ Two weekends' work involving road closures (on Farnham Rd and Bridge Rd) went without issues.
  - Saturday 9 August 2025
  - Saturday 16 August 2025
- ✓ Additional planning meetings for October works agree and confirm traffic management arrangements.

Item 4



## Building additional confidence

- We've had **further meetings** to review arrangements for Week 31 (October 2025 closure).
- **One traffic management company** to implement and coordinate all closures for the works. Not two as previously planned to minimise risk of confusion and miscommunication.
- Reviewing additional **requirements of Melton Parish Council** and confirming with Suffolk CC who are highways authority.
- Meetings closer to week 31 to **confirm arrangements with traffic management company**.

# Item 5: Traffic Movements and Transport Review Group Update

Rebecca Quigg, Transport Coordinator

Steve Merry, Suffolk County Council Highways

# Transport Monitoring Reporting Q2 2025

Average (Mean) and Maximum Daily HDV Movements

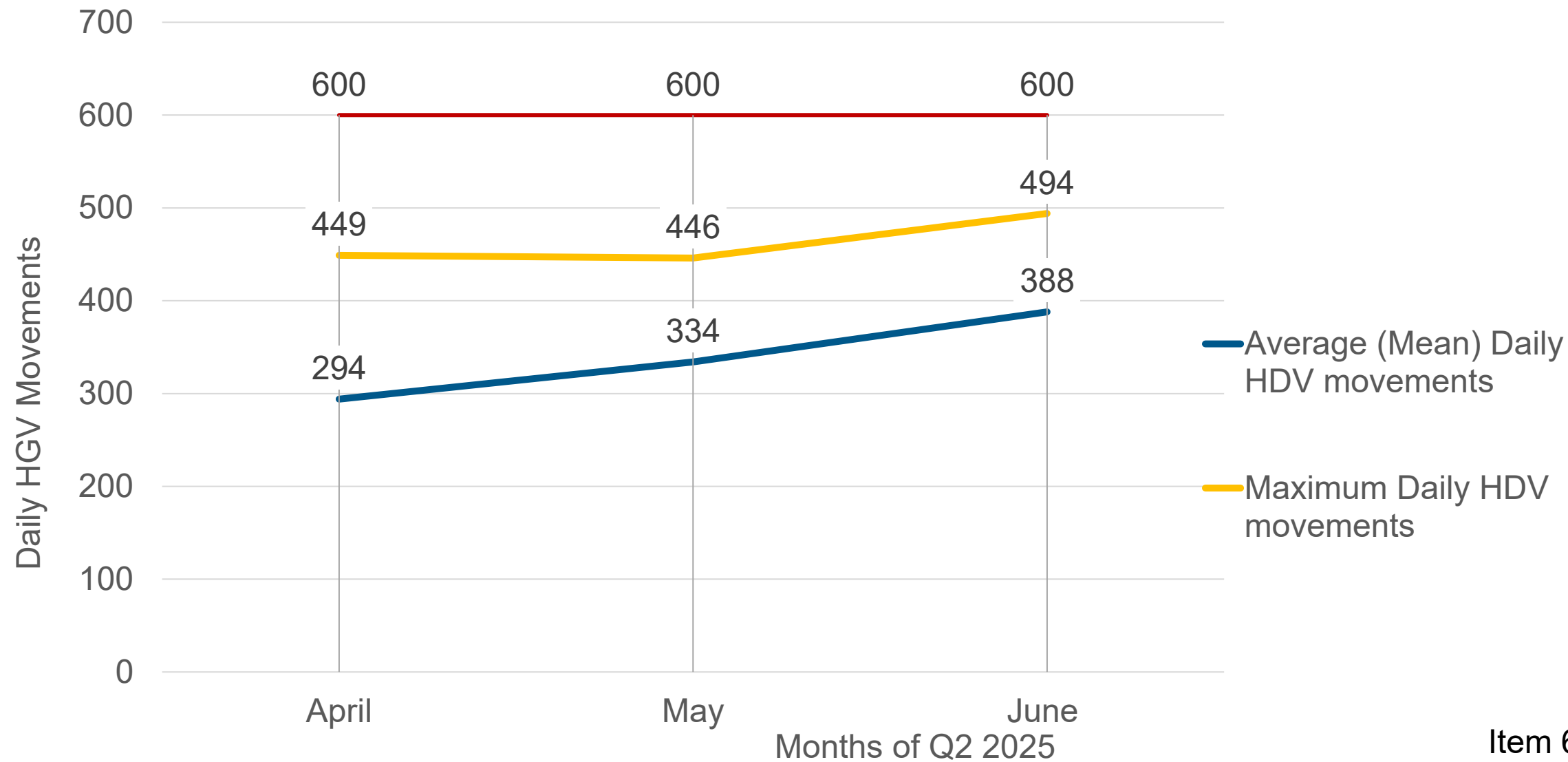



# Transport Monitoring Reporting Q2 2025

## Directional Split of HGV Movements

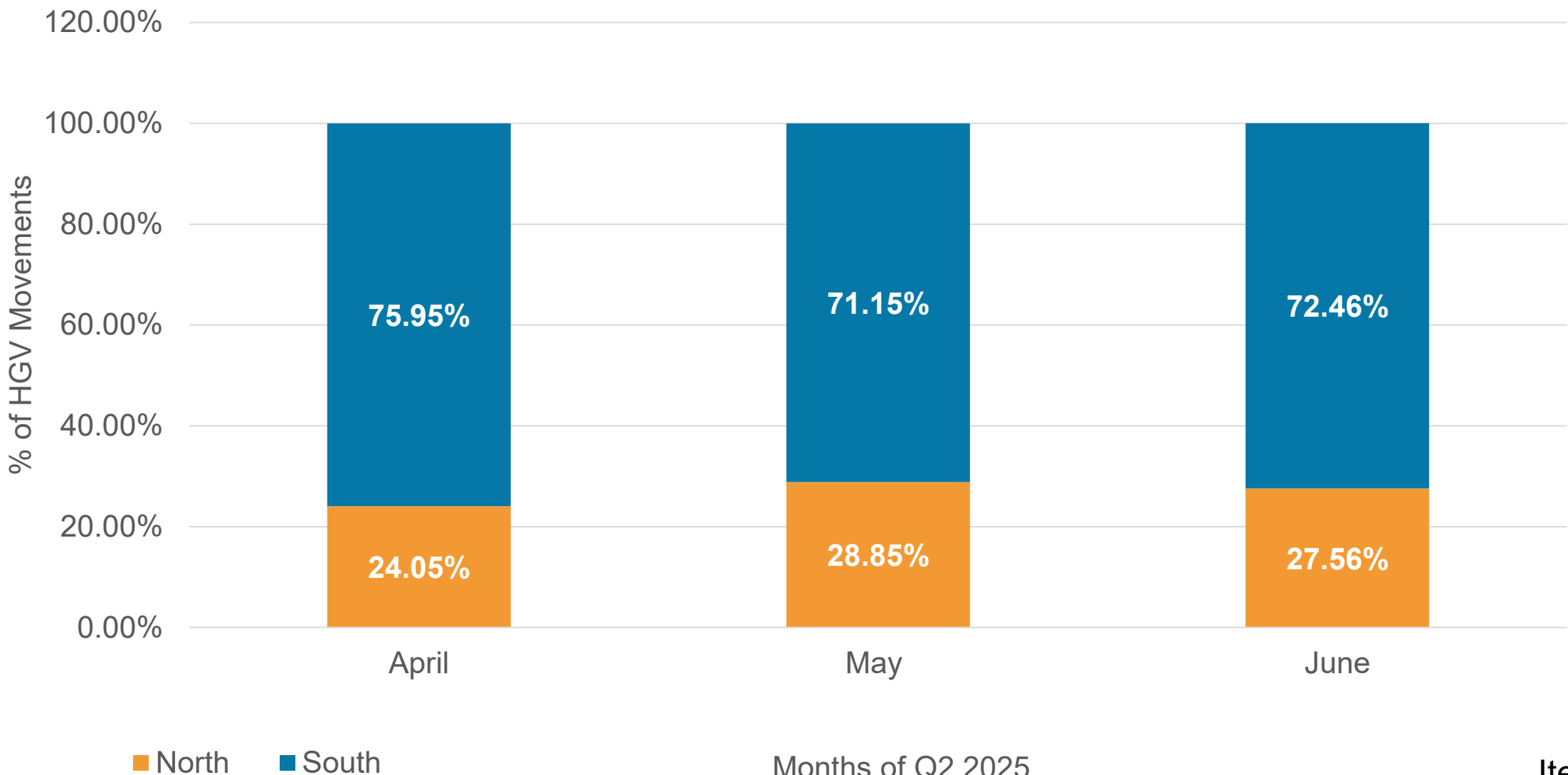

# Transport Monitoring Reporting Q2 2025

## Average (Mean) and Maximum LGV Movements

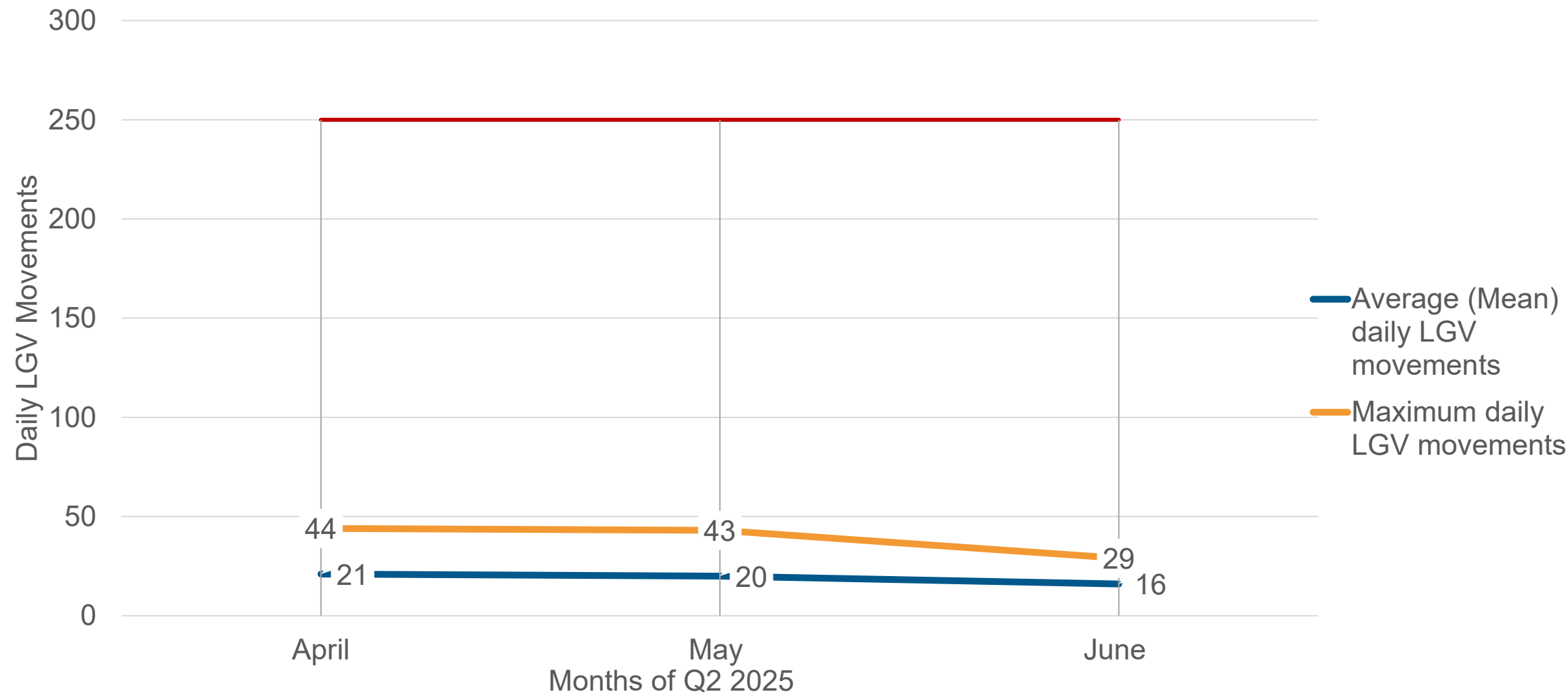

# Transport Review Group Update

- Last meeting on 23 July 2025
- Papers to be uploaded to ESC website next week
- **Key topics of discussion**
  - Permanent traffic monitoring
  - Results of latest traffic monitoring survey
  - CTMP review
  - Key accesses to the off-site infrastructure sites

## Transport Working Groups

- Designs have been in progress over the summer
- Dates for next working groups are now going in the diary for September
- Yoxford, Westleton and Leiston schemes have been formally accepted by their working groups



# Traffic Monitoring 2025

- Next round of traffic monitoring took place at the end of April 2025
- Results were presented to the TRG on 23 July 2025
- TRG is continuing to monitor biannual sites
- Snapshot monitoring survey to take place in August, including bank holiday weekend
- TRG has agreed to take forward 7 permanent monitoring sites, subject to funding agreement

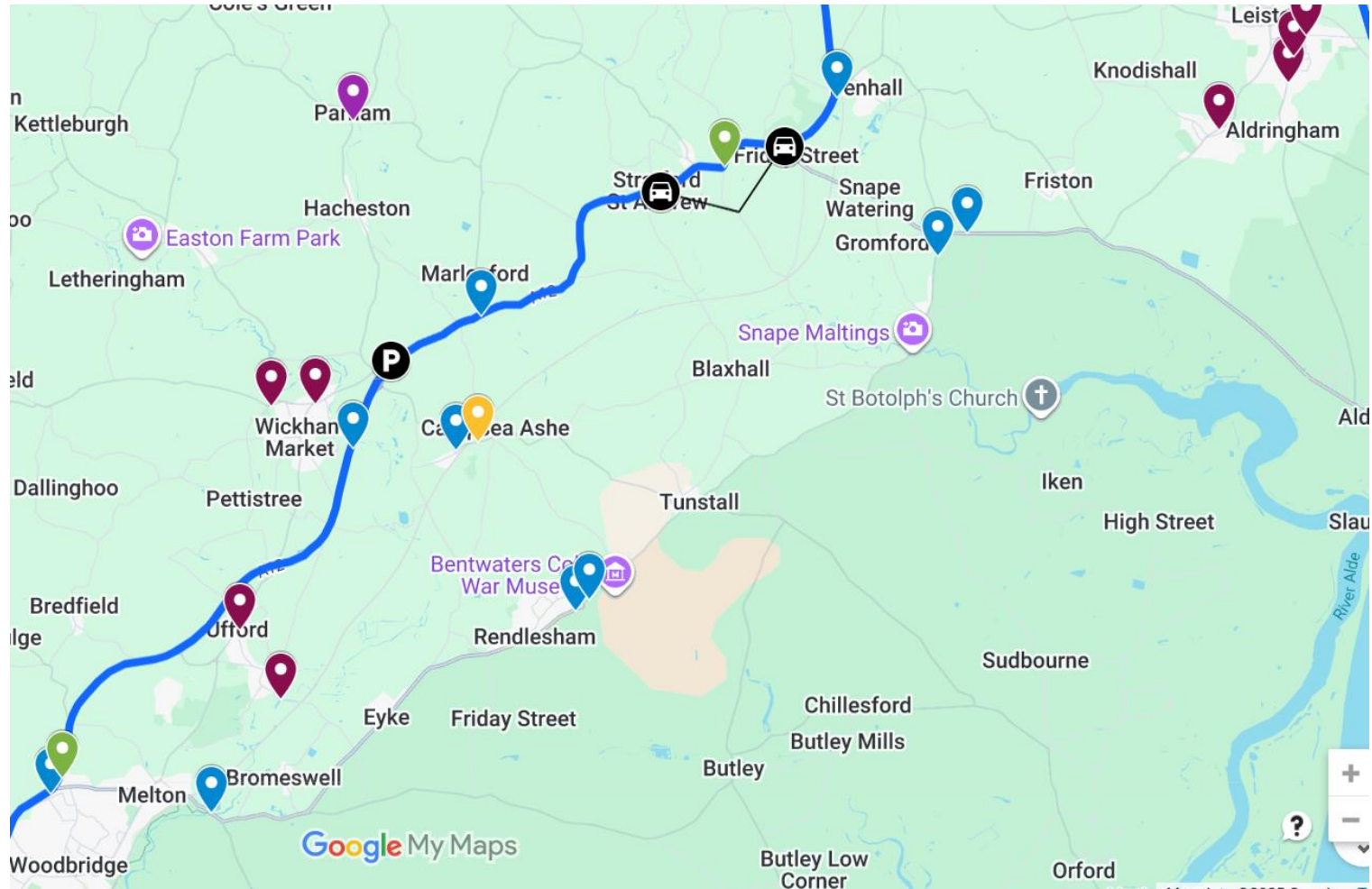

# Item 6: Q&A

Via Town and Parish Council Representative  
Chair

Item 7 59

# Pre-submitted Questions

**Submitted by:** Cllr Geraldine Barker Saxmundham Town Council

Stationery Goods Trains held in Saxmundham during the night with the engines running:  
The issue with goods trains being held in Saxmundham has already been raised with Sizewell C. Unfortunately, thus far, Network Rail have not been forthcoming with a solution. Saxmundham Town Council were advised that 'the drivers are unable to switch off their engines while waiting, as restarting them would be inefficient and cause further delays due to the time needed to warm up the locomotives'. This situation is totally unsatisfactory. The trains should not be held in Saxmundham. Local residents are being woken during the night and often, due to the extended duration of the engines running, are unable to return to sleep.

To eliminate disturbance, is there any reason why the locomotives cannot be held outside Saxmundham?



## Pre-submitted Questions

**Submitted by:** Cllr John Bann Melton Parish Council

**Q1)** For Stephen Keighley - at past Forum meetings I have asked about improving access across the Melton level crossing for pedestrians and cyclists as a benefit for the local community and as a quid pro quo for disruption caused with the closure of Melton level crossing for SZC rail works and at other locations which result in the suspension of our train services. Your response to my queries led me to believe that when the improvements to the track were made, there could be improvements done at the same time for the pedestrians and cyclists as part of the SZC scheme. Network Rail made it clear at a recent meeting that this was not the case and that they are concentrating on just the track and that any instructions about other improvements are outstanding. Can you update me on SZC's current position on this?

**Q2)** When the Melton Level Crossing works are undertaken at the end of October, Melton Parish Council want to have electronic matrix signs placed on the A12 at the A1152 roundabout to clearly direct drivers who want to travel beyond the crossing via the signed diversionary route up the A12. This will reduce unnecessary traffic, including for Bentwaters, travelling down Woods Lane into Melton and being forced to U turn or attempt a return to the A12 via Melton, Yarmouth Road and Ufford. Can SZC commit to organising this with SCC Highways?

## Pre-submitted Questions

**Submitted by:** Cllr Richard Cooper Marlesford Parish Council

### **Q1) HV Works Marlesford to Southern Park and Ride**

In my e mails of 14<sup>th</sup> July and 4<sup>th</sup> August I raised the issue of the works required to lay an HV cable from Marlesford to the Southern Park and Ride. As this is likely to involve significant disruption to A12 traffic coming through Marlesford and the works are believed to be taking place in Q4 2025, Marlesford wants to understand what the programme of works is and how it will impact Marlesford residents.

### **Q2) Southern Park and Ride**

In February, a commitment was made by SZC to host a visit to the Southern Park and Ride site “when it was possible”. We are aware that SZC are looking to discharge planning conditions associated with the Southern Park and Ride and we believe the final plans for the site have been drawn up. What is preventing SZC from hosting a visit to the Southern Park and Ride site for Wickham Market, Hacheston, Campsea Ashe and Marlesford?

## Pre-submitted Questions

**Submitted by:** Klaus Fortmann Clerk to Campsea Ashe Parish Council

**Q1)** We have been informed of SZC subcontractors removing the blue vehicle stickers and using roads (like the B1078 Coddensham – Campsea) they have been briefed not to use. How will SZC be dealing with this, as ‘briefing ‘ employees seemingly are not quite working.

**Q2)** We had been repeatedly assured that no sub-contractors would utilise Bentwaters /Rendlesham.

It seems that is not being the case, with large amount of contractor vehicles (including road sweeper) stationed in the Bentwaters/Rendlesham area. This is hugely disappointing, considering the strains our village is already under. These vehicles add to an already heavy load on the weight restricted Ivy Lodge Road. Can SZC assure that their assurances will be correct in the future?



## Pre-submitted Questions

**Submitted by:** Cllr Charlotte Fox Benhall and Sternfield Parish Council

**Q1)** The new Friday Street roundabout will sit wholly within Benhall and the Benhall and Sternfield Parish Council would like to know exactly what provisions have been made for cycling, walking and wheeling road users and whether any upgrades to current designations - such as from footpath to bridleway - have been made?

**Q2)** The PC would like to understand how the various existing PROWs, pedestrian and cycling footpaths will link together in order to ensure that there are no 'stranded' sections and that full connectivity is achieved.

### **Submitted by:** Cllr Robin Sanders Woodbridge Town Council

**Q1.** At an earlier forum it was agreed that Sizewell C team would ensure all Sizewell C related HGV traffic would bear an SZC sticker so that they are identifiable as vehicles servicing/visiting Sizewell C or its associated sites such as the two villages bypass and the P&R projects. This was so they could be identified easily and reported if there were concerns about where the HGVs were seen or if drivers were transgressing speed limits etc. It is readily apparent that this HGV sticker scheme is either non-existent or that it is failing to be enforced. In recent trips up the A12 I have not seen a single SZC sticker on a HGV, many of which I suspect are on Sizewell C related journeys. I have also seen at least two HGV on the A1152/B1079 which I suspect are Sizewell C related.

Now that there are other energy related projects where similar HGVs are being utilised it is, in my view, imperative that we can distinguish Sizewell C HGVs from others on the roads and I consider this be instigated fully in the next week or two.

**Q2.** I have recently raised concerns with the Project Team on the presence of a fleet of medium to large water tanker HGVs that have been abstracting water daily on a near constant basis, for quite a few months, from two fire hydrants in the Martlesham Heath industrial estate. All these vehicles are parking on bends and in one location on double yellow lines causing a serious road safety hazard and are starting to impact on the road verges, kerbs etc. Two weeks ago one driver advised that these tankers are supplying water for dust suppression on Sizewell C. I am aware that on Thursday last week you sought to investigate this matter. Can you please report to this meeting if you were aware before my contact of this matter, if this abstraction is being paid for and that you are seeking to remedy the traffic hazards the tankers are causing by parking on bends.

# Forum Schedule 2025

All forum timings:  
**18:30 - 20:30** (arrival from 18:00)



Our forums are open to local people to attend as observers – and they're another great way to hear about our latest work!

Main Development Site Forum	Wednesday 15 <sup>th</sup> January 2025	Leiston Town Athletic Association, Victory Road, Leiston, Suffolk, IP16 4DQ
Northern Transport Forum	Wednesday 5 <sup>th</sup> February 2025	Darsham Village Hall, Cheyney Green, The Street, Darsham, Suffolk, IP17 3FA
Southern Transport Forum	Wednesday 12 <sup>th</sup> March 2025	Stratford St Andrew Riverside Centre, Great Glemham Road, Stratford St Andrew, Suffolk, IP17 1LJ
<b>Community Forum</b>	<b>Thursday 27<sup>th</sup> March 2025</b>	<b>High Lodge, Haw Wood Hinton Nr, Saxmundham IP17 3QT</b>
Main Development Site Forum	Wednesday 2 <sup>nd</sup> April 2025	Leiston Town Athletic Association, Victory Road, Leiston, Suffolk, IP16 4DQ
Northern Transport Forum	Wednesday 7 <sup>th</sup> May 2025	Darsham Village Hall, Cheyney Green, The Street, Darsham, Suffolk, IP17 3FA
Southern Transport Forum	Wednesday 4 <sup>th</sup> June 2025	Stratford St Andrew Riverside Centre, Great Glemham Road, Stratford St Andrew, Suffolk, IP17 1LJ
Main Development Site Forum	Wednesday 2 <sup>nd</sup> July 2025	Leiston Town Athletic Association, Victory Road, Leiston, Suffolk, IP16 4DQ
Northern Transport Forum	Wednesday 6 <sup>th</sup> August 2025	Darsham Village Hall, Cheyney Green, The Street, Darsham, Suffolk, IP17 3FA
Southern Transport Forum	Wednesday 3 <sup>rd</sup> September 2025	Stratford St Andrew Riverside Centre, Great Glemham Road, Stratford St Andrew, Suffolk, IP17 1LJ
Main Development Site Forum	Wednesday 8 <sup>th</sup> October 2025	Leiston Town Athletic Association, Victory Road, Leiston, Suffolk, IP16 4DQ
<b>Community Forum</b>	<b>Thursday 23<sup>rd</sup> October 2025</b>	<b>Sizewell Sports and Social Club, King George's Avenue, Leiston, IP16 4JX</b>
Northern Transport Forum	Wednesday 5 <sup>th</sup> November 2025	Darsham Village Hall, Cheyney Green, The Street, Darsham, Suffolk, IP17 3FA
Southern Transport Forum	Wednesday 3 <sup>rd</sup> December 2025	Stratford St Andrew Riverside Centre, Great Glemham Road, Stratford St Andrew, Suffolk, IP17 1LJ





Thank you

