

WELCOME

To the Sizewell C Community Engagement Event



Clr Ray Herring

Leader of Suffolk Coastal District Council



Clr Guy McGregor

Chair of the Joint Local Authorities Group



Guiding Principles

Stephen Baker

Chief Executive of Suffolk Coastal & Waveney District Councils



Overarching Principle

‘If Suffolk is doing right by the nation
the nation should do right by Suffolk’

- Benefit from perceived ‘burden’ of hosting new nuclear facility
- Keeping the ‘lights on’
- Security of supply

Key Principles

- Environmental Exemplar
- Maximising Economic Growth
- Securing Infrastructure Legacy
- Agreement on long-term Community Benefit

Environmental Exemplar

- Environmentally sensitive area
 - AONB, SSSI, Ramsar
- Visual Impact
 - Build on Sizewell B design standards
- Construction impact
 - Minimise land take
 - Protect beach access
 - Tourism impact

Maximising Economic Growth

- Maximise local employment
- Establish strong local supply chain
- Use development as catalyst for improving skills, esp. in young people

Securing Infrastructure Legacy

- Transport Infrastructure
 - Road network improvements e.g. 4VBP & B1122/ Yoxford Junction
 - Rail improvements
- Associated Development sites legacy
 - Housing
 - Serviced land
 - Tourism
 - Recreation
- Capital investment in skills/ training

Community Benefit

- Goes to the heart of 'doing right by Suffolk'
- New Nuclear Authorities working closely with central govt & industry
- Establish long-term fund based on generating capacity
- Distinct from section 106 agreements negotiated for construction phase

Council's views on EDF's Stage 1 Consultation

Bob Chamberlain, John Pitchford & Paul Wood
Representing Suffolk Coastal & Suffolk County Councils



Stage 1 Consultation

- Overarching impacts
 - Transport
 - Environment
 - Economic
- Main site
- Construction & Lay-down areas
- Associated Development Sites

Transport

- Inadequate information provided
- Underestimates car traffic to site
- Need for four villages by-pass & mitigation on B1122 & through Yoxford
- P&R sites should not be close to construction site
- Sustainable transport links for workers east of A12

Transport

- Maximise use of rail & sea transport
- New rail head adds to flows on local network
- Direct rail to site overcomes this but environmental impacts need consideration
- Rail passengers on Leiston line?
- Support freight management facility

Environment

- EDF should treat project as an environmental exemplar
- Seeking very high quality design – building on B station
- Enhancements to AONB & wider area
- Any structure designed to minimise impact on coastal processes
- Continued engagement with local communities on development of coastal management proposals
- Clarification on long-term spent fuel storage

Economic Opportunities

- Disappointed with lack of detail around maximising local economic opportunities
- EDF's aspirations welcome but need to see mechanisms to deliver:
 - Employment
 - Local supply chain opportunities
 - Training & skills
- Will work with EDF to manage 'boom & bust' and ensure economic exploitation of project

Main site

- Within AONB - seeking exemplar of good design with minimal impact
- Detailed design unavailable – concern more visually obtrusive than B station
- Loss of SSSI – land take needs to be justified & minimised
- Understanding of impact on coastal processes required partic. in relation to jetty
- Retain beach access during construction
- Robust landscaping with lighting shielded/ screened

Construction & Laydown Areas

- Laydown area very extensive EDF need to provide justification
- Council objects to use of land overlooking:
 - Minsmere Valley
 - Theberton
 - Leiston Abbey
 - Pill Box Field
- Screening effect retained at Coronation Wood
- More work required on impact on east Leiston residents & traffic impact on Lover's Lane
- Phasing plan for restoration of laydown areas
- Minimise impact on AONB of new access road post construction

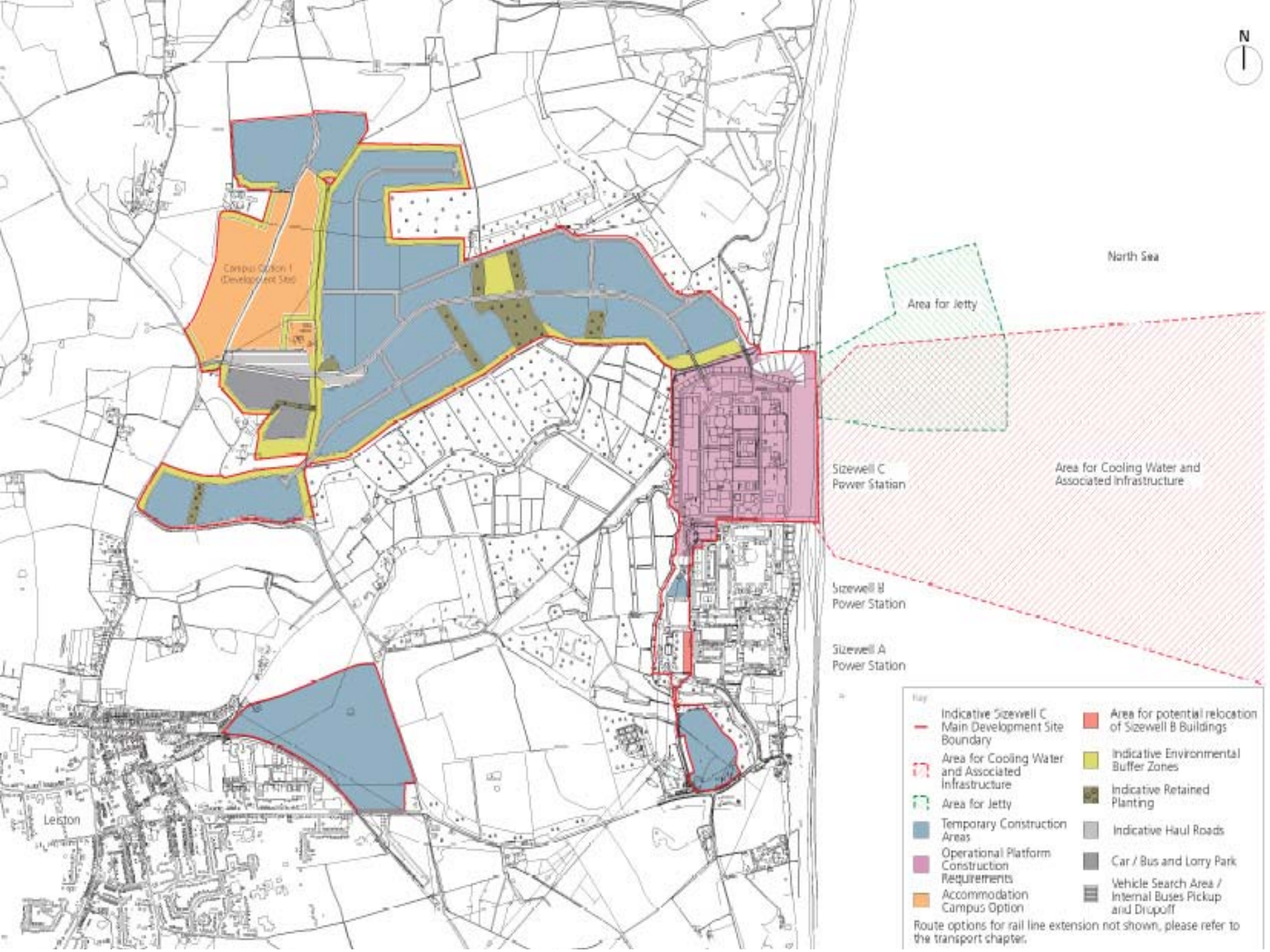
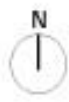

Campus Option 1
Development Site

North Sea

Area for Jetty

Sizewell C
Power Station

Area for Cooling Water and
Associated Infrastructure

Sizewell B
Power Station

Sizewell A
Power Station

Leiston

- Key
- | | | | |
|--|--|--|---|
| | Indicative Sizewell C Main Development Site Boundary | | Area for potential relocation of Sizewell B Buildings |
| | Area for Cooling Water and Associated Infrastructure | | Indicative Environmental Buffer Zones |
| | Area for Jetty | | Indicative Retained Planting |
| | Temporary Construction Areas | | Indicative Haul Roads |
| | Operational Platform Construction Requirements | | Car / Bus and Lorry Park |
| | Accommodation Campus Option | | Vehicle Search Area / Internal Buses Pickup and Dropoff |
- Route options for rail line extension not shown, please refer to the transport chapter.

Associated Development Sites

- Sites include:
 - Accommodation Campus
 - Two Park & Rides
 - Freight Management Centre
 - Visitors Centre
- 3 options provided for each site
- Guiding principles steered our response

Accommodation Campus

- No rationale for huge single campus
- Legacy housing/ tourism should be explored
- Need clarification on traffic impacts of accommodation options
- Sizewell Gap option discounted
 - Wholly within AONB
 - No benefits over other options

Park & Ride

- Northern & southern options provided
- Northern Options:
 - Option 1 (Yoxford Rd) discounted as too close to site & impact on B1122
 - Option 2 (Darsham) preferable to option 3 (A12/A144 junc.) on environmental & traffic safety grounds
 - Option 2 also potential legacy parking at Darsham station
 - Potential benefit from alternative option closer to northern population settlements

Park & Ride

- Southern options:
 - Decouple Freight Management Centre
 - Option 3 (Potash Corner) discounted due to impact on amenity, PROW & safety issues
 - Option 1 (Wickham Mkt) retain with further consideration of archaeological impact/ highway access
 - Option 2 (Woodbridge) achieves maximum mitigation & may have potential legacy use

Freight Management Centre

- Prefer stand alone site on A14
- Legacy use for 'Operation Stack'
- Option 3 (Seven Hills Junction) impacts on natural & historic environment
- Option 1 (Orwell Crossing West) impacts on employment land
- Option 2 (Orwell Crossing East) favoured if legacy use is viable

Visitors Centre

- New centre would replace Sizewell B facility
- Option 1 (east of Lover's Lane) discounted on environmental grounds
- Option 3 (Goose Hill) best connection to construction site & is preferable long-term
- Option 2 (Sizewell Beach) should be considered for temporary site until option 3 available

Breakout Sessions



Workshop Feedback

Bryn Griffiths

Assistant Director, Suffolk County Council



Managing the Impact on the Local Community

Associated Sites and Transport Issues

(Park and Ride, Freight Management and Rail)

- More evidence and information needed **urgently**
- Suffolk needs a **four villages by-pass**
 - Needed for this development and others: take up with Government
- Don't forget **Yoxford**
- Consider **new route** from Saxmundham to Leiston
- Concern about vehicle movements from **east of A12**
- **Maximise rail and sea** use above road
 - Improve rail infrastructure including passengers
- Concern about **Jetty impacts** eg: fishing, coastal processes and landscape
- **Control vehicle movements**
 - Bulk up loads
 - Control lorry movements
- Consider **dispersing accommodation** and using smaller blocks
- There **must be a legacy** from the associated sites e.g. housing

Environmental Exemplar

Sizewell C and Environmental Issues

- **Sizewell C's design is crucial**
 - appearance must be at least as good as Sizewell B including Chimney's
- Sizewell Estate plans are good but **plans need to immediate area.**
 - Enhancement not just Mitigation
 - Mitigate SSSI loss
 - Dry Fuel Store precedent
 - Work with Environmental Agency
- EDF need to **justify the vastness of the lay-down area** – can it be smaller?
 - Can we use existing brown field sites
- Access to Beach must be maintained throughout build and beyond
- Associated developments and buildings crucial as well
- Freshwater footprint needs to be considered
- We want phased return of the land **asap**

A Lasting Legacy

Jobs, Growth and Community Issues

- Important to **work with Government** to maximise Suffolk's benefits
 - Energy Site of Excellence
 - Focus not just Nuclear also East Anglian Off-Shore Wind and Renewable Energy Enterprise Zone
- **Sustain Communities** beyond build period
- We are looking for wider community benefits through a **long term fund**. In addition to SIO6
- Catalyst for improving **skills for young people**
 - Opportunities for graduates and apprenticeships
 - Engineering and Energy Skills from Primary School and beyond
- **Capital investment** needed in skills and education
- We must insist that the existing level of public services in not diluted by Sizewell C
- www.sizewellsupplychain.co.uk
- Lasting legacy e.g. **sports clubs and recreation sites**
- **Centre of Excellence** for high end engineering
 - Map resources

Next Steps

Responding to the Consultation and beyond

- We would be demanding benefits not just expecting them
- Suffolk needs to clearly articulate its need in united way to strengthen the council's S106 agreement negotiations
- What we want will need to be prioritised if we are to be effective
- Another community event will be needed to Stage 2 of the Consultation
- We need to be clearer about the development timelines

Next Steps

Cllr Guy McGregor

Chair Joint Local Authorities Group

