

Scale:1:15000

Scale
 0 150 300 450 600 750 m

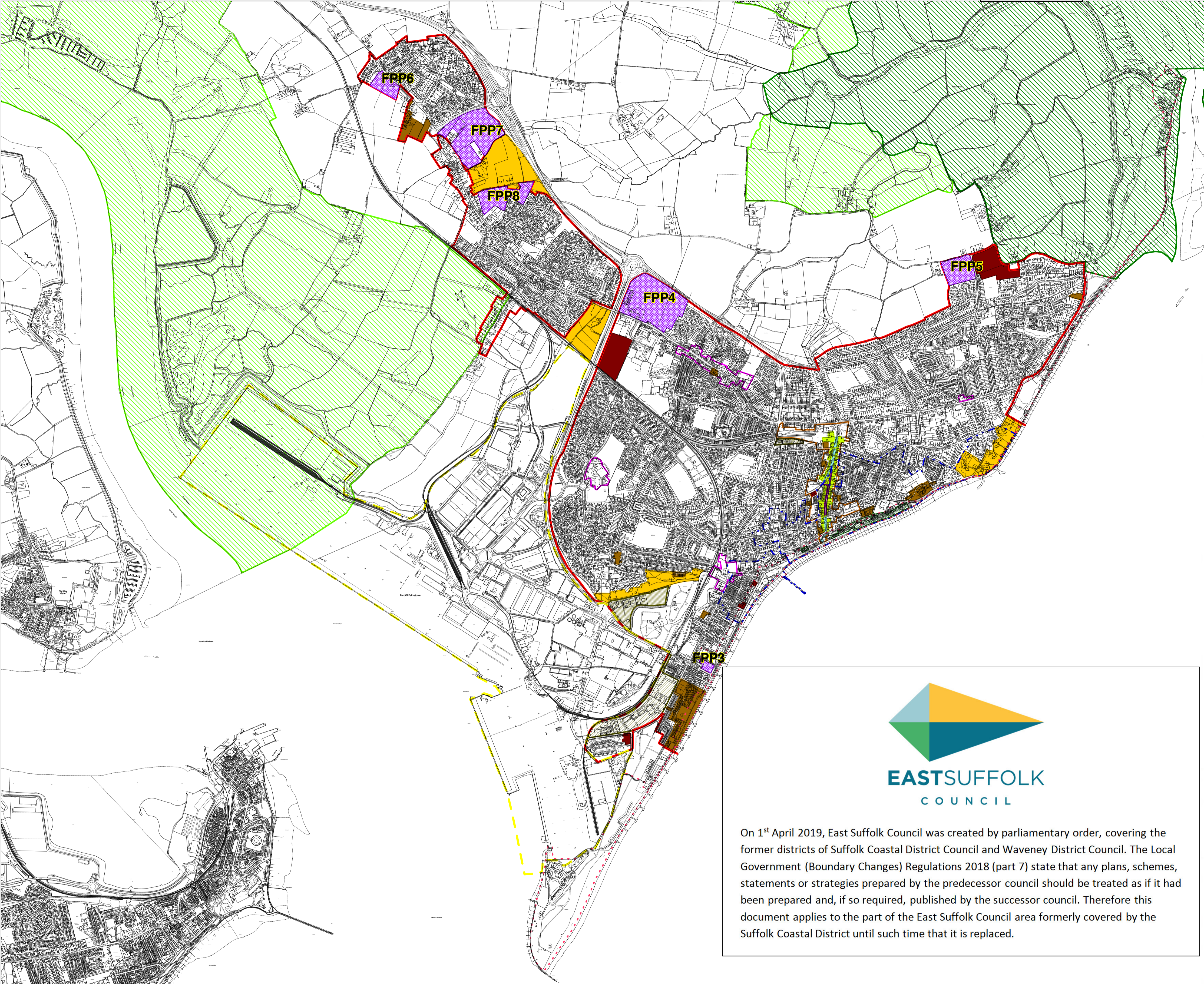

This document was superseded on 23rd September 2020 with the adoption of the East Suffolk Council - Suffolk Coastal Local Plan.



On 1st April 2019, East Suffolk Council was created by parliamentary order, covering the former districts of Suffolk Coastal District Council and Waveney District Council. The Local Government (Boundary Changes) Regulations 2018 (part 7) state that any plans, schemes, statements or strategies prepared by the predecessor council should be treated as if it had been prepared and, if so required, published by the successor council. Therefore this document applies to the part of the East Suffolk Council area formerly covered by the Suffolk Coastal District until such time that it is replaced.



Town Centre Inset Map - not to scale

Key

- Area of Outstanding Natural Beauty
- Heritage Coast & AONB
- FPP28: Areas to be Protected from Development
- FPP13: Felixstowe Town Centre
- FPP15: Primary Shopping Area
- FPP10: Land at Bridge Road, Felixstowe
- FPP11: Land at Carr Road/Langer Road, Felixstowe
- FPP12: Land at Haven Exchange, Felixstowe
- FPP14: Retail frontages (Primary)
- FPP14: Retail frontages (Secondary)
- FPP16: District Centres
- Conservation Areas
- Housing permissions between 1/4/15 to 31/12/15
- Housing permissions as at 31/3/15
- FPP25: Historic Park and Garden
- FPP17 - FPP21: Seafront Policies
- FPP2: Physical Limits Boundaries
- FPP9: Port of Felixstowe
- Housing Allocations